

462930

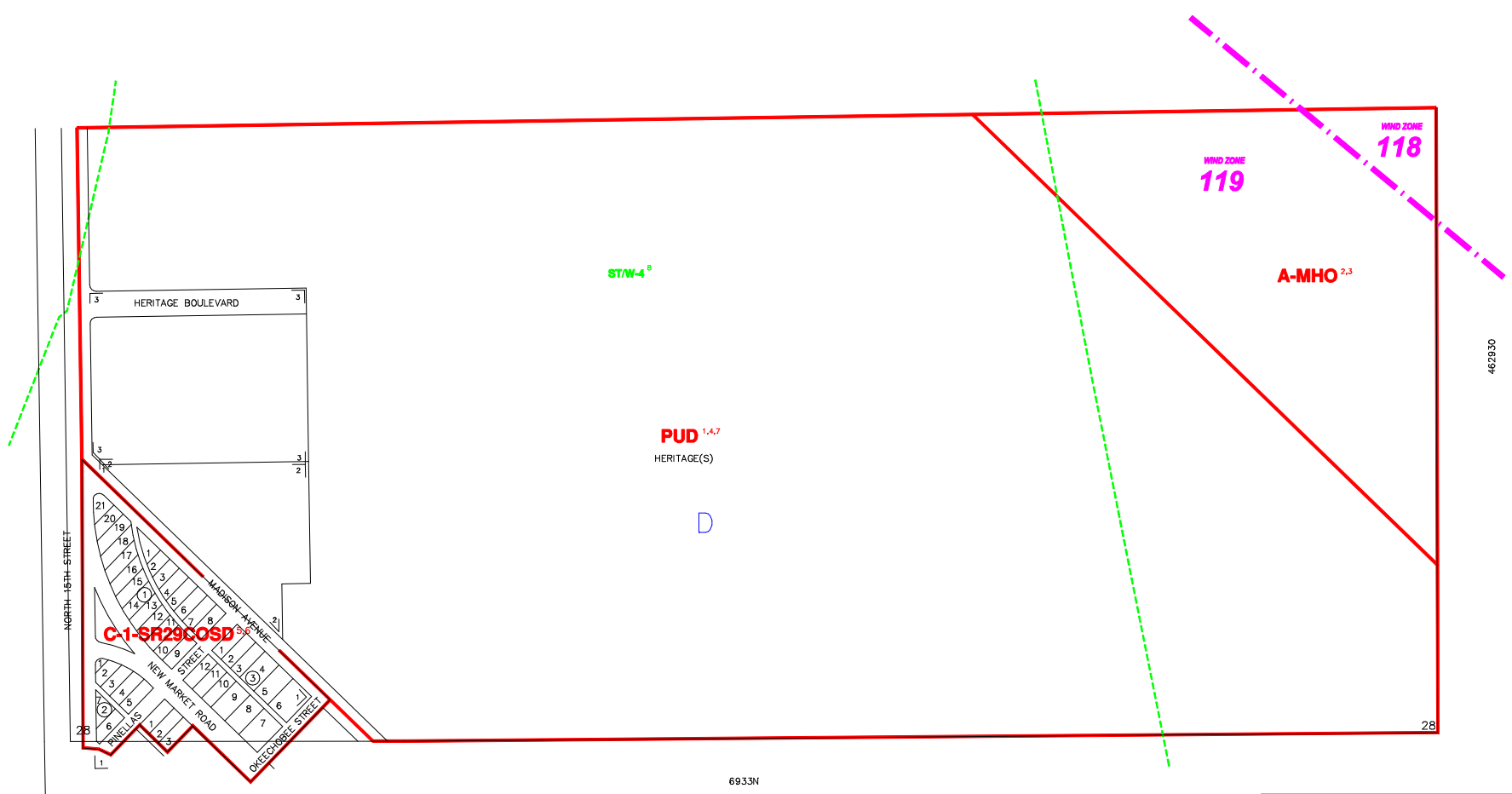

6929

462930

D

C-1-SR29COSD 2,6

6933N

----- INDICATES SPECIAL TREATMENT OVERLAY
 - - - - - INDICATES WIND ZONE BOUNDARY LINE

SUBDIVISION INDEX							
NO.	NAME	P.B.	Pg.	NO.	NAME	P.B.	Pg.
1	NEWMARKET SUB	1	104	11			
2	HERITAGE UNIT 1	19	66-69	12			
3	HERITAGE UNIT 2	23	74-75	13			
4				14			
5				15			
6				16			
7				17			
8				18			
9				19			
10				20			

ZONING NOTES
 1 4-20-02 R-82-21
 2 4-20-02 R-82-32
 3 8-12-01 R-82-31
 4 8-12-01 R-82-32
 5 8-12-01 R-82-33
 6 4-17-04 LDC R-28
 7 3-15-04 SUNSETTED
 8 6-15-05 LDC ORD. 05-27

THIS IS TO CERTIFY THAT THIS IS A PAGE OF THE OFFICIAL ZONING ATLAS REFERRED TO AND ADOPTED BY REFERENCE BY ORDINANCE NO. 04-41 OF THE COUNTY OF COLLIER, FLORIDA, ADOPTED JUNE 22, 2004.

BY _____ CHAIRMAN

ATTEST _____ CLERK

FLOOD INSURANCE RATE MAP INFORMATION	
COMMUNITY NUMBER: 120067	PANEL NUMBER: 150G
PROGRAM: REGULAR	EFFECTIVE DATE: NOV. 17, 2005
FLOOD ZONE: ALL <u>D</u> OR AS SHOWN ON MAP.	
WIND ZONE: ALL _____ OR AS SHOWN ON MAP.	
COLLIER COUNTY, FLORIDA	
COMMUNITY DEVELOPMENT DIVISION	
TWP 46S RNG 29E	SEC(S) 28 SO 1/2
SCALE	MAP NUMBER:
0 400	6928S