

The Historic/Archaeological Probability Maps are the official County source designating historic or archaeological resources.

69335

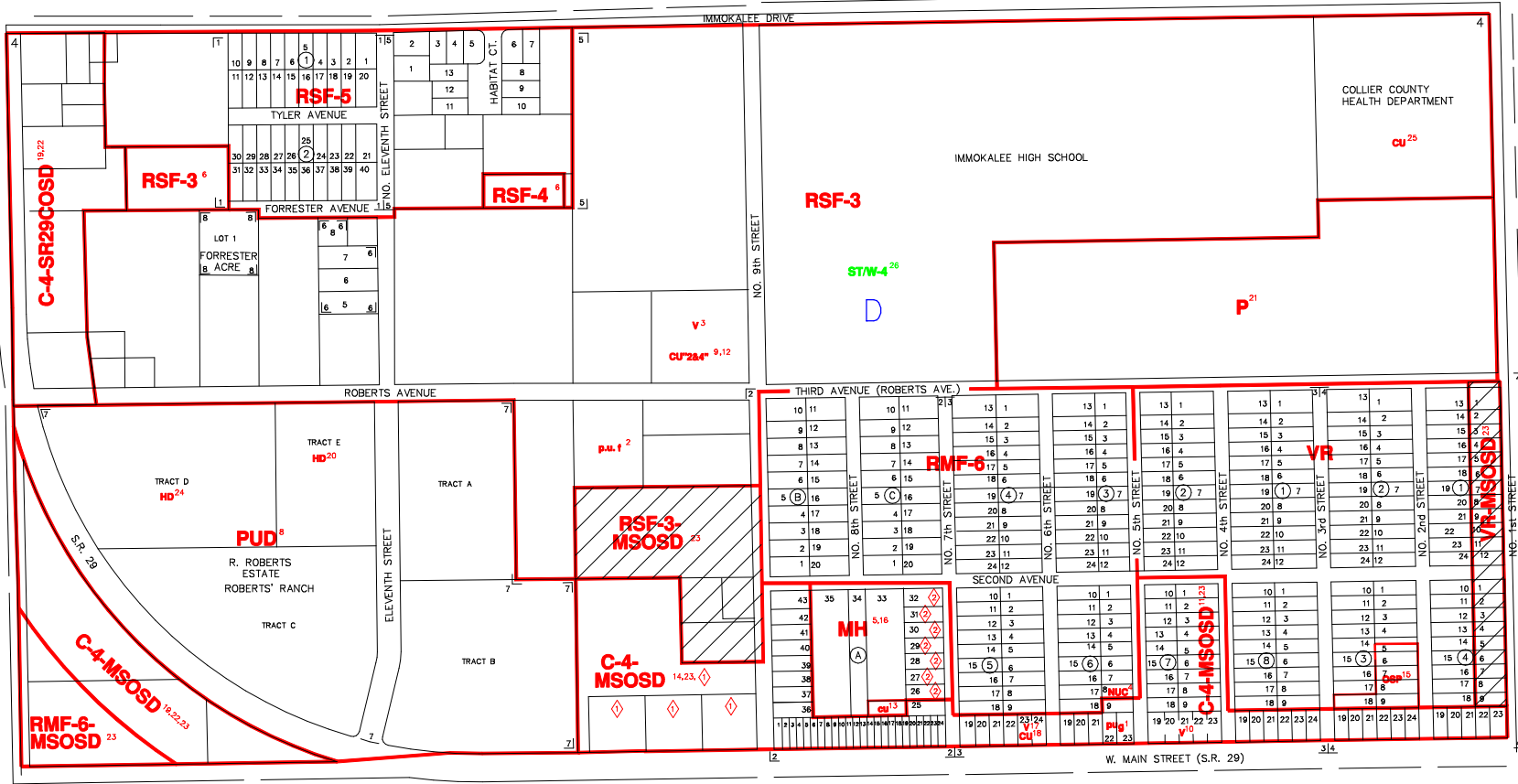

LAST REVISION: ZONING _____ OTHER _____

7905N

7903N

7904S

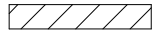

SPECIAL CONDITIONS OF (MSOSD)



INDICATES SPECIAL TREATMENT OVERLAY

SUBDIVISION INDEX							
NO.	NAME	P.B.	Pg.	NO.	NAME	P.B.	Pg.
1	HULL HEIGHTS		95	11			
2	JOYCE PARK		101	12			
3	MILLERS PARK		80	13			
4	FRED WHIDDEN		36	14			
5	HABITAT FOR HUMANITY PHASE 6		86	15			
6	LOS HORYON SUBDIVISION		73	16			
7	ROBERTS RIDGE		100-101	17			
8	FORRESTER ACRE		83	18			
9				19			
10				20			

ZONING NOTES	DEVELOPMENT STANDARDS MODIFICATIONS
1	6-28-84 R-94-3 94-33
2	6-28-84 R-94-3 94-33
3	6-28-84 R-94-3 94-33
4	6-28-84 R-94-3 94-33
5	6-28-84 R-94-3 94-33
6	6-28-84 R-94-3 94-33
7	6-28-84 R-94-3 94-33
8	6-28-84 R-94-3 94-33
9	6-28-84 R-94-3 94-33
10	6-28-84 R-94-3 94-33
11	6-28-84 R-94-3 94-33
12	6-28-84 R-94-3 94-33
13	6-28-84 R-94-3 94-33
14	6-28-84 R-94-3 94-33
15	6-28-84 R-94-3 94-33
16	6-28-84 R-94-3 94-33
17	6-28-84 R-94-3 94-33
18	6-28-84 R-94-3 94-33
19	6-28-84 R-94-3 94-33
20	6-28-84 R-94-3 94-33
21	6-28-84 R-94-3 94-33
22	6-28-84 R-94-3 94-33
23	6-28-84 R-94-3 94-33
24	6-28-84 R-94-3 94-33
25	6-28-84 R-94-3 94-33
26	6-28-84 R-94-3 94-33

THIS IS TO CERTIFY THAT THIS IS A PAGE OF THE OFFICIAL ZONING ATLAS REFERRED TO AND ADOPTED BY REFERENCE BY ORDINANCE NO. 91-102 OF THE COUNTY OF COLLIER, FLORIDA, ADOPTED OCTOBER 30, 1991.

BY _____ CHAIRMAN
 ATTEST _____ CLERK

FLOOD INSURANCE RATE MAP INFORMATION

COMMUNITY NUMBER: 120067 PANEL NUMBER: 150G
 PROGRAM: REGULAR EFFECTIVE DATE: NOV. 17, 2005
 FLOOD ZONE: ALL D OR AS SHOWN ON MAP.
 WIND ZONE: ALL 119 OR AS SHOWN ON MAP.

COLLIER COUNTY, FLORIDA
 COMMUNITY DEVELOPMENT DIVISION
 TWP 47S RNG 29E SEC(S) 4 NO. 1/2
 SCALE 0 400 MAP NUMBER: 7904N