

7933N

7932S

472930

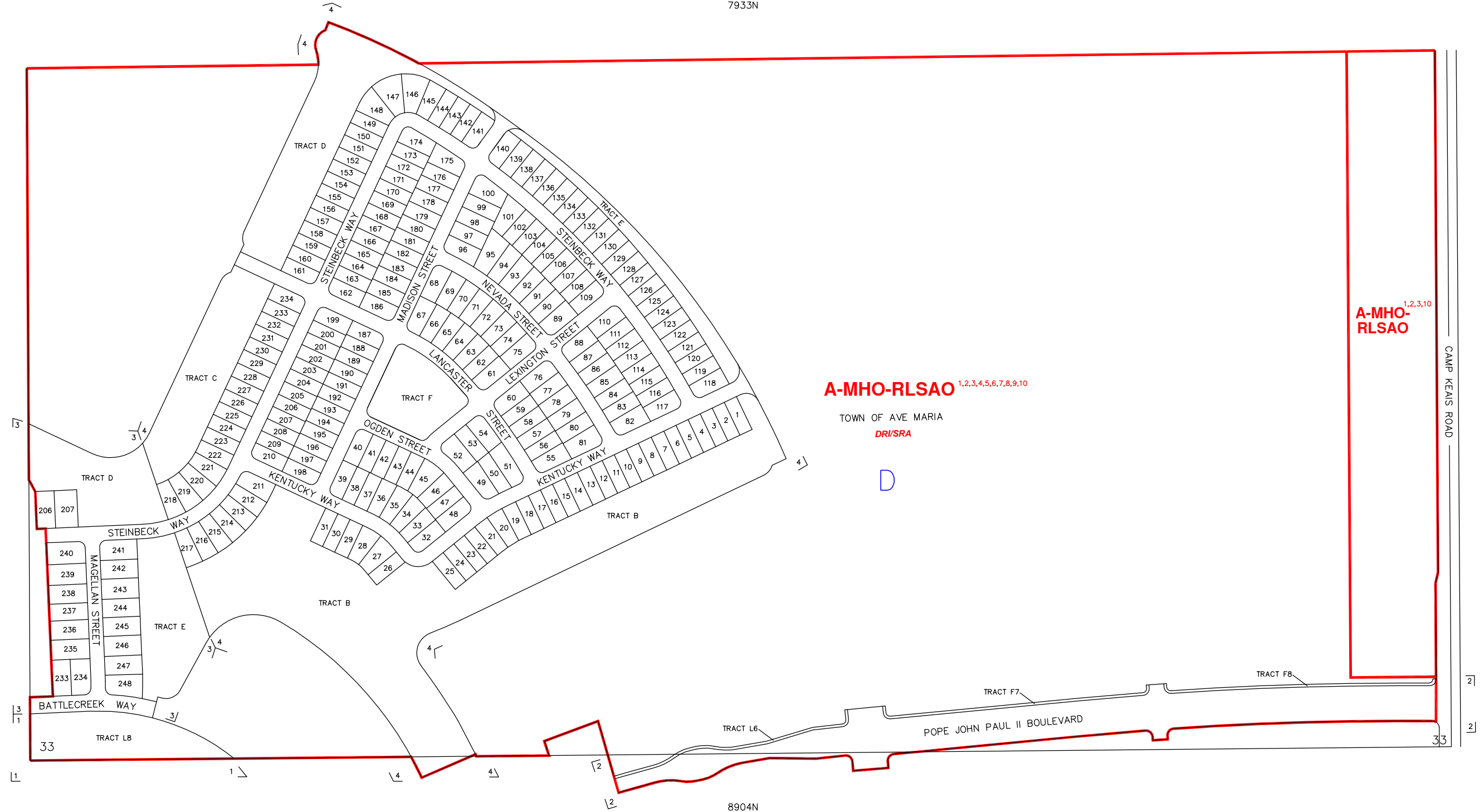

A-MHO-RLSAO 1,2,3,4,5,6,7,8,9,10

TOWN OF AVE MARIA
DR/SRA

D

A-MHO-RLSAO 1,2,3,10

CAMP KEAIS ROAD

8904N

SUBDIVISION INDEX

NO.	NAME	P.B.	Pg.	NO.	NAME	P.B.	Pg.
1	AVE MARIA PHASE ONE	46	16-29	11			
2	AVE MARIA PHASE TWO	48	29-34	12			
3	AVE MARIA UNIT 7, LIBERTY PARK	48	35-40	13			
4	AVE MARIA UNIT 8, EMERSON PARK	48	41-47	14			
5				15			
6				16			
7				17			
8				18			
9				19			
10				20			

ZONING NOTES

1 4-20-82 R-82-2-I
 2 R-87-8C
 3 LDC-91
 4 3-23-04 SRA-03-AR-4578 04-89
 5 6-14-05 DRI-04-AR-6293 05-235
 6 11-1-05 SE-05-AR-8029 05-377
 7 6-14-05 SRA-04-AR-6896 05-234A
 8 1-1-06 DC-05-AR-0030 05-376
 9 DC-07-AR-12651 06-153
 10 6-16-03 LDC 03-27

THIS IS TO CERTIFY THAT THIS IS A PAGE OF THE OFFICIAL ZONING ATLAS REFERRED TO AND ADOPTED BY REFERENCE BY ORDINANCE NO. 04-41 OF THE COUNTY OF COLLIER, FLORIDA, ADOPTED JUNE 22, 2004.

BY _____ CHAIRMAN

ATTEST _____ CLERK

FLOOD INSURANCE RATE MAP INFORMATION

COMMUNITY NUMBER: 120067 PANEL NUMBER: 275G
 PROGRAM: REGULAR EFFECTIVE DATE: NOV. 17, 2005
 FLOOD ZONE: ALL D OR AS SHOWN ON MAP.
 WIND ZONE: ALL 121 OR AS SHOWN ON MAP.

COLLIER COUNTY, FLORIDA

COMMUNITY DEVELOPMENT DIVISION

TWP47S RNG 29E SEC(S) 33 SO 1/2

SCALE 0 400 MAP NUMBER: 7933S