

The Historic/Archaeological Probability Maps are the official County source designating historic or archaeological resources.

LAST REVISION: ZONING \_\_\_\_\_ OTHER \_\_\_\_\_

8509S

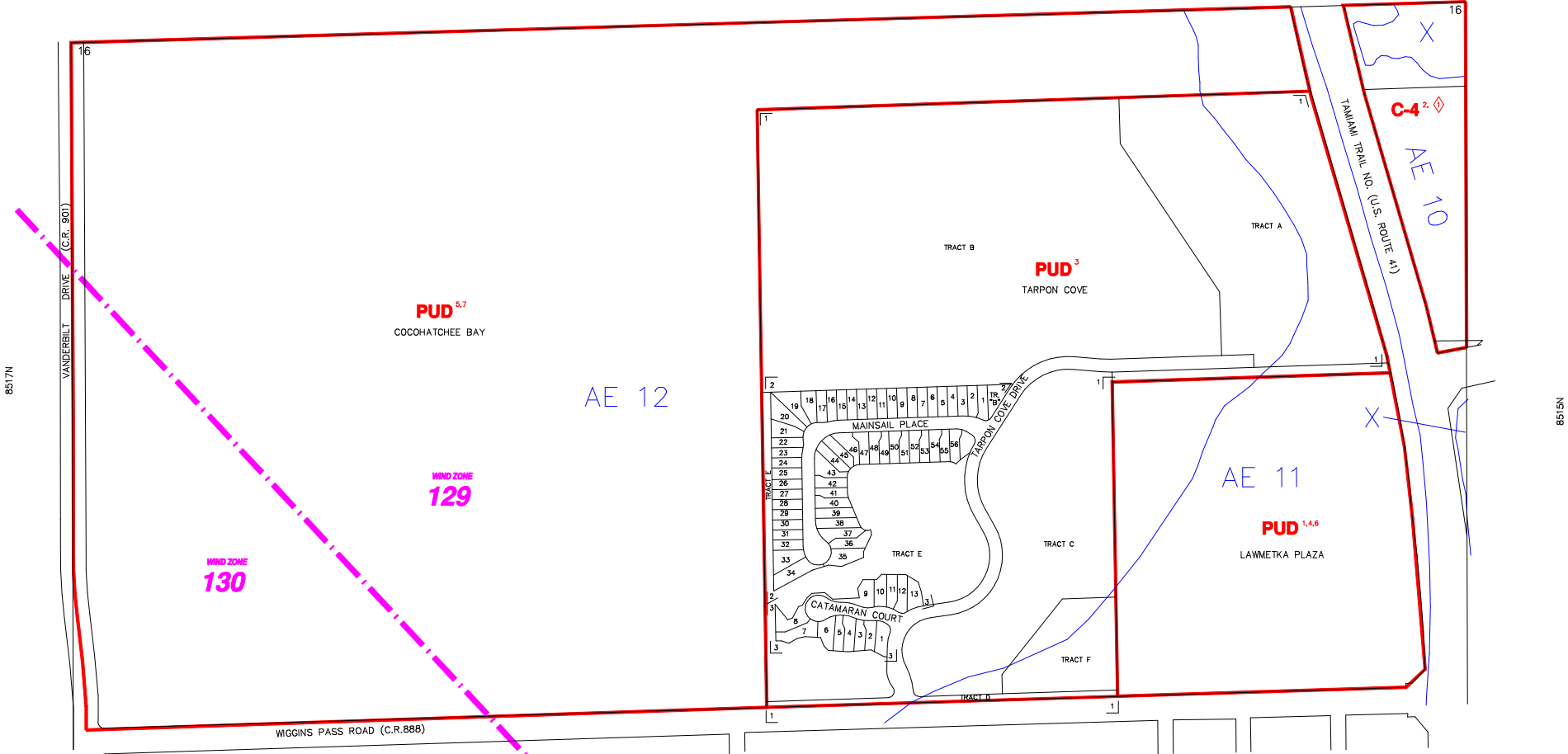

8517N

VANDERBILT DRIVE (C.R. 907)

WIGGINS PASS ROAD (C.R. 888)

8515N

8516S

— — — — — INDICATES WIND ZONE BOUNDARY LINE

SUBDIVISION INDEX							
NO.	NAME	P.B.	Pg.	NO.	NAME	P.B.	Pg.
1	TARPOON COVE	27	91-97	11			
2	TARPOON COVE REPLAT	29	14-17	12			
3	CATAMARAN COURT AT TARPOON COVE	31	69-70	13			
				14			
				15			
				16			
				17			
				18			
				19			
				20			

**ZONING NOTES**

1 3-27-90 R-88-23 80-26  
 2 3-27-90 R-88-23 80-26  
 3 5-12-95 R-91-91 11 65-76  
 4 5-12-95 R-91-91 11 65-76  
 5 10-14-00 PUD-02-48-0088 02-31  
 6 11-18-05 PUD-02-48-0088 02-31  
 7 11-18-05 PUD-02-48-0088 02-31

**DEVELOPMENT STANDARDS MODIFICATIONS**

6-22-92 R-92-4 92-43

THIS IS TO CERTIFY THAT THIS IS A PAGE OF THE OFFICIAL ZONING ATLAS REFERRED TO AND ADOPTED BY REFERENCE BY ORDINANCE NO. 04-41 OF THE COUNTY OF COLLIER, FLORIDA, ADOPTED JUNE 22, 2004.

BY \_\_\_\_\_ CHAIRMAN  
 ATTEST \_\_\_\_\_ CLERK

**FLOOD INSURANCE RATE MAP INFORMATION**

COMMUNITY NUMBER: 120067 PANEL NUMBER: 187G, 191G  
 PROGRAM: REGULAR EFFECTIVE DATE: NOV. 17, 2005  
 FLOOD ZONE: ALL \_\_\_\_\_ OR AS SHOWN ON MAP.  
 WIND ZONE: ALL \_\_\_\_\_ OR AS SHOWN ON MAP.

**COLLIER COUNTY, FLORIDA**

COMMUNITY DEVELOPMENT DIVISION  
 TWP 48S RNG 25E SEC(S) 16 NO 1/2  
 SCALE 0 400  
 MAP NUMBER: 8516N