

AE 10

CANAL

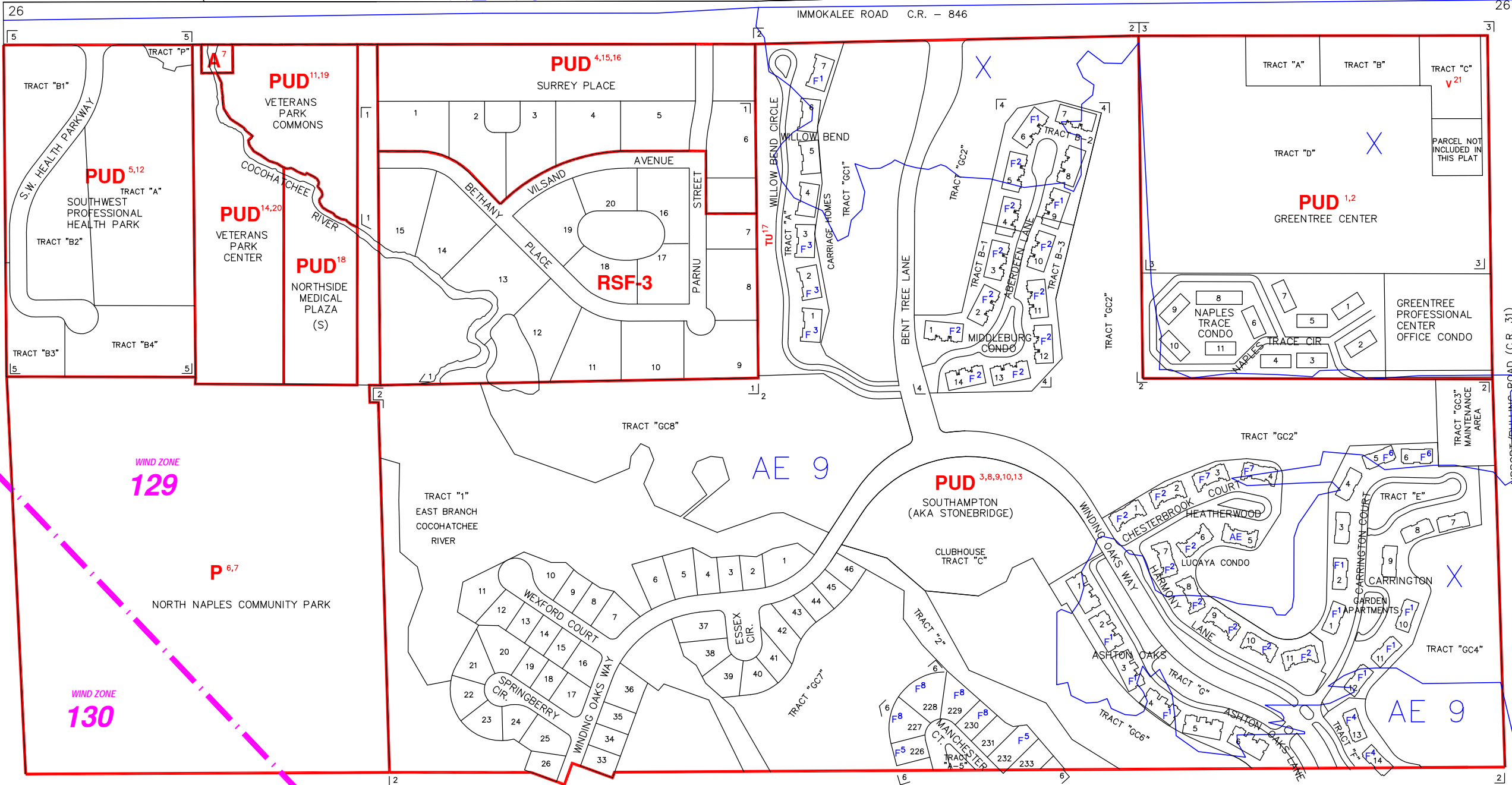

- FLOOD ZONE MAP REVISION**
1. ZONE X (LOMR) 3-18-98
 2. ZONE X (LOMR) 6-12-97
 3. ZONE X (LOMR) 12-16-99
 4. ZONE X (LOMR) 6-20-01
 5. ZONE X (LOMR) 8-2-06
 6. ZONE X (LOMR) 8-17-06
 7. ZONE X (LOMR) 8-29-06
 8. ZONE X (LOMR) 2-21-08

INDICATES WIND ZONE BOUNDARY LINE

SUBDIVISION INDEX			
NO.	NAME	P.B.	Pg.
1	SOUTHWIND ESTATES	11	17
2	SOUTHAMPTON UNIT ONE	19	92-103
3	GREEN TREE CENTER	19	26-30
4	SIENNA AT SOUTHAMPTON	20	17-18
5	SOUTHWEST PROFESSIONAL HEALTH PARK	28	53-54
6	STONEBRIDGE UNIT FIVE	30	76-77
7			
8			
9			
10			

- ZONING NOTES**
1. R-81-16-C
 2. Z-84-6
 3. R-87-48C
 4. R-88-10C
 5. 11-14-89 R-89-5 89-74
 6. R-85-17
 7. LDC-91
 8. PUD-87-48(1) 91-96
 9. 10-8-92 PD-95-5 95-46
 10. 11-2-95 PD-96-1 96-33
 11. 6-25-96 PUD-89-5(1) 96-49
 12. 12-10-96 PD-97-3 97-22
 13. 6-5-97 PD-97-13 97-80
 14. 12-9-97 PUD-88-10(1) 98-60
 15. 8-23-98 PUD-88-10(2) 98-67
 16. 8-4-98 PUD-88-10(2) 98-67
 17. 6-13-00 PUD-90-4 09-49
 18. 5-8-01 PUD-96-1(2) 01-23
 19. 5-8-01 PUD-97-13(1) 01-22
 20. 10-23-07 VA-07-AR-11577 07-297

THIS IS TO CERTIFY THAT THIS IS A PAGE OF THE OFFICIAL ZONING ATLAS REFERRED TO AND ADOPTED BY REFERENCE BY ORDINANCE NO. 04-41 OF THE COUNTY OF COLLIER, FLORIDA, ADOPTED JUNE 22, 2004.

BY _____ CHAIRMAN
 ATTEST _____ CLERK

FLOOD INSURANCE RATE MAP INFORMATION

COMMUNITY NUMBER: 120067 PANEL NUMBER: 193G,195G
 PROGRAM: REGULAR EFFECTIVE DATE: NOV. 17, 2005
 FLOOD ZONE: ALL _____ OR AS SHOWN ON MAP.
 WIND ZONE: ALL _____ OR AS SHOWN ON MAP.

COLLIER COUNTY, FLORIDA
 COMMUNITY DEVELOPMENT DIVISION
 TWP 48S RNG 25E SEC(S) 26 NO 1/2
 SCALE 0 400
 MAP NUMBER: 8526N