

LAST REVISION: ZONING _____ OTHER _____

The Historic/Archaeological Probability Maps are the official County source designating historic or archaeological resources.

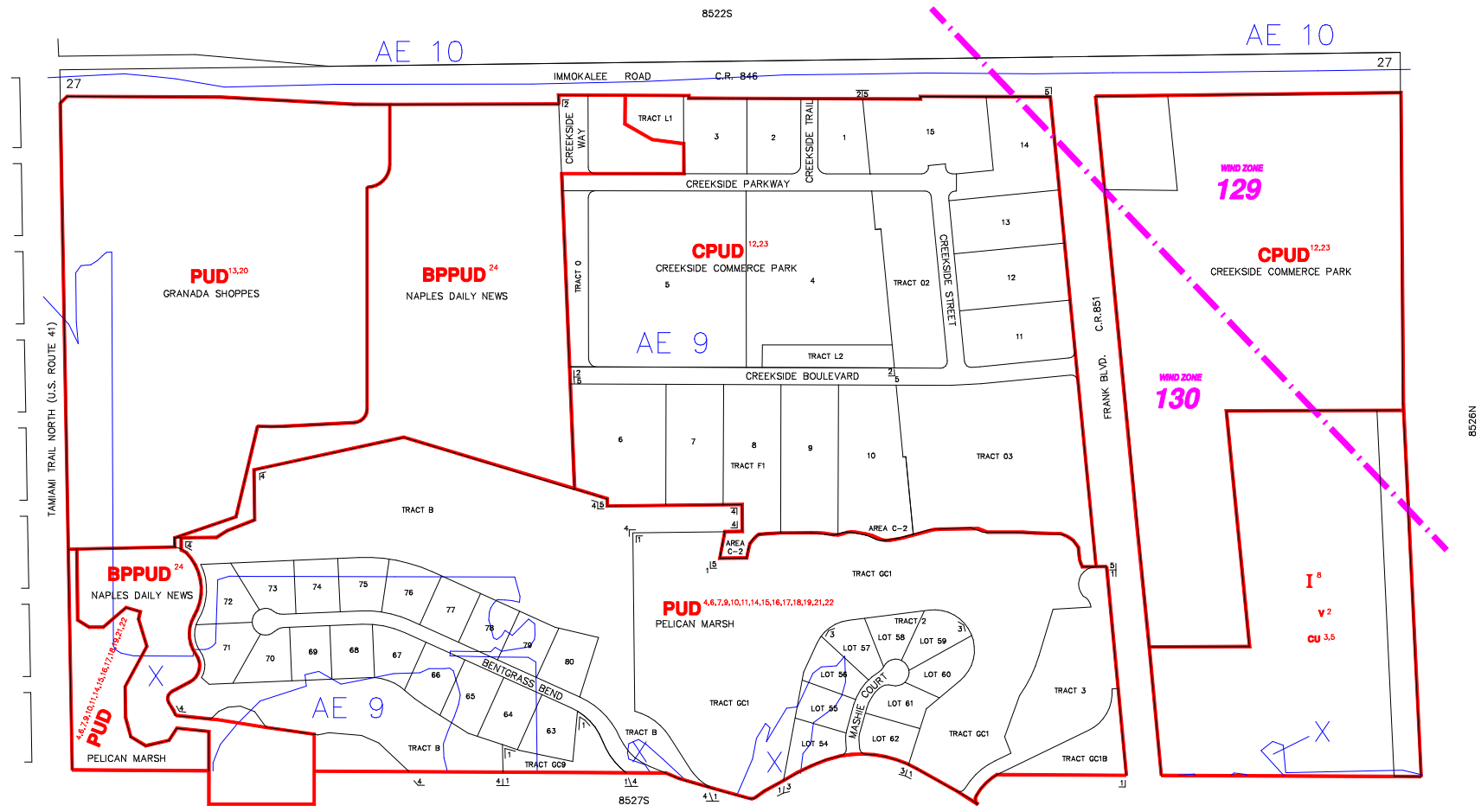

----- INDICATES WIND ZONE BOUNDARY LINE

SUBDIVISION INDEX							
NO.	NAME	P.B.	Pg.	NO.	NAME	P.B.	Pg.
1	PELICAN MARSH GOLF COURSE PHASE THREE	25	14-16	9			
2	CREEKSIDE COMMERCE PARK WEST-UNIT ONE	29	57-58	10			
3	MASHIE COURT AT THE ESTATES AT BAY COLONY GOLF CLUB	31	67-68	11			
4	BENTGRASS BEND AT THE ESTATES AT BAY COLONY GOLF CLUB	33	54-56	12			
5	CREEKSIDE COMMERCE PARK WEST-UNIT TWO	35	43-44	13			
6				14			
7				15			
8				16			
				17			
				18			

ZONING NOTES

1 DC-91 V-02-16 02-415
 2 4-4-82 C-1-02-17 02-32
 3 4-2-82 C-1-02-17 02-32
 4 4-2-82 C-1-02-17 02-32
 5 4-2-82 C-1-02-17 02-32
 6 4-2-82 C-1-02-17 02-32
 7 4-2-82 C-1-02-17 02-32
 8 4-2-82 C-1-02-17 02-32
 9 4-2-82 C-1-02-17 02-32
 10 4-2-82 C-1-02-17 02-32
 11 4-2-82 C-1-02-17 02-32
 12 4-2-82 C-1-02-17 02-32
 13 4-2-82 C-1-02-17 02-32
 14 4-2-82 C-1-02-17 02-32
 15 4-2-82 C-1-02-17 02-32
 16 4-2-82 C-1-02-17 02-32
 17 4-2-82 C-1-02-17 02-32
 18 4-2-82 C-1-02-17 02-32
 19 4-2-82 C-1-02-17 02-32
 20 4-2-82 C-1-02-17 02-32
 21 4-2-82 C-1-02-17 02-32
 22 4-2-82 C-1-02-17 02-32
 23 4-2-82 C-1-02-17 02-32
 24 4-2-82 C-1-02-17 02-32

THIS IS TO CERTIFY THAT THIS IS A PAGE OF THE OFFICIAL ZONING ATLAS REFERRED TO AND ADOPTED BY REFERENCE BY ORDINANCE NO. 04-41 OF THE COUNTY OF COLLIER, FLORIDA, ADOPTED JUNE 22, 2004.

BY _____ CHAIRMAN
 ATTEST _____ CLERK

FLOOD INSURANCE RATE MAP INFORMATION

COMMUNITY NUMBER: 120067 PANEL NUMBER: 193G
 PROGRAM: REGULAR EFFECTIVE DATE: NOV. 17, 2005
 FLOOD ZONE: ALL _____ OR AS SHOWN ON MAP.
 WIND ZONE: ALL _____ OR AS SHOWN ON MAP.

COLLIER COUNTY, FLORIDA

COMMUNITY DEVELOPMENT DIVISION

TWP 48S RNG 25E SEC(S) 27 NO 1/2

SCALE 0 400

MAP NUMBER: 8527N