

The Historic/Archaeological Probability Maps are the official County source designating historic or archaeological resources.

LAST REVISION: ZONING _____ OTHER _____

8609N

8610N

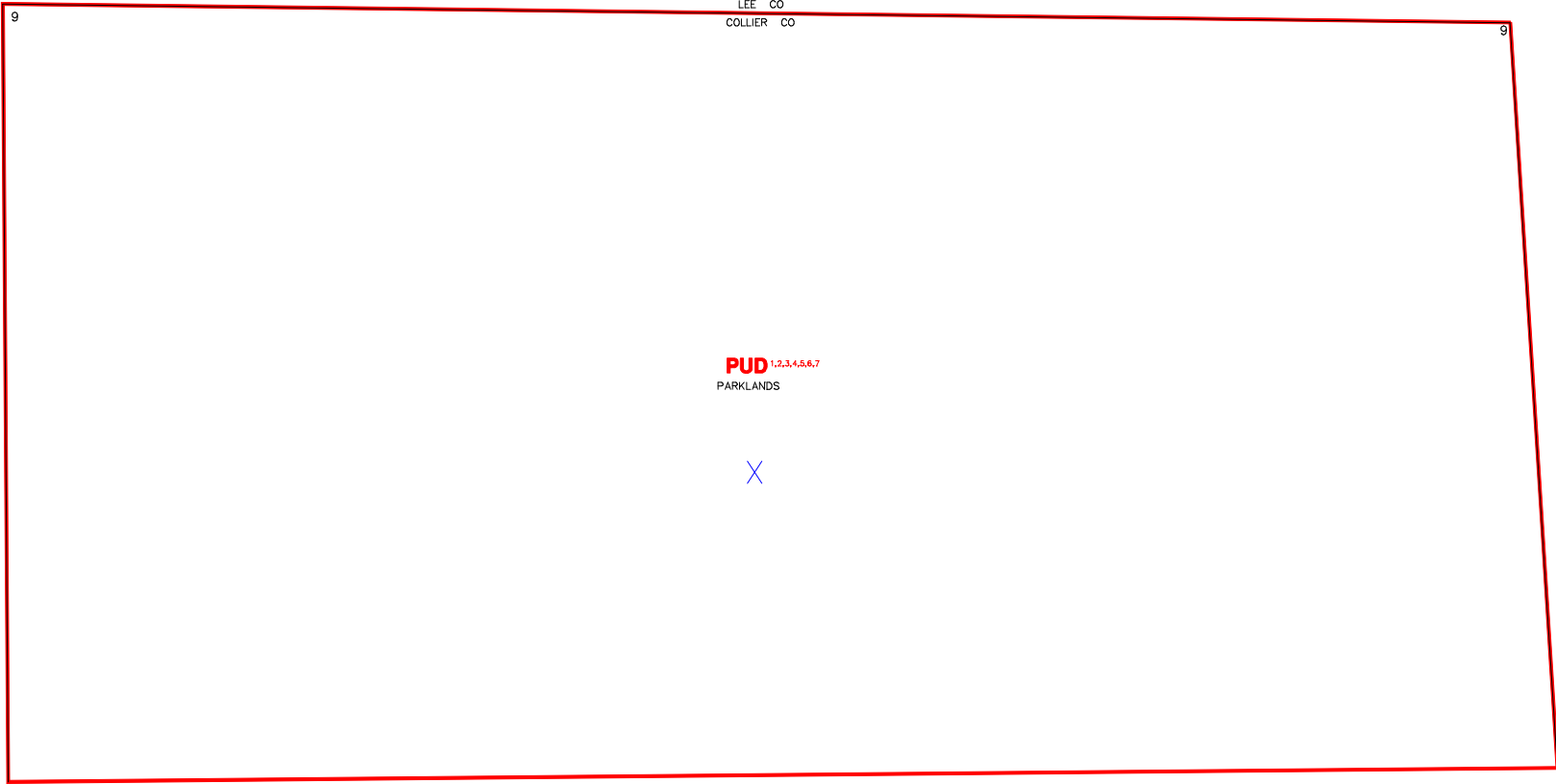

8609S

SUBDIVISION INDEX							
NO.	NAME	P.B.	Pg.	NO.	NAME	P.B.	Pg.
11							
12							
13							
14							
15							
16							
17							
18							
19							
20							

ZONING NOTES
 1. PUD-84-24(1), 83-43
 2. 7-27-83
 3. 2-28-88 DCA-84-3, 84-388
 4. 7-30-02 DCA-02-AR-27288 02-328
 5. 8-8-03 DCA-02-AR-2388 03-02

THIS IS TO CERTIFY THAT THIS IS A PAGE OF THE OFFICIAL ZONING ATLAS REFERRED TO AND ADOPTED BY REFERENCE BY ORDINANCE NO. 04-41 OF THE COUNTY OF COLLIER, FLORIDA, ADOPTED JUNE 22, 2004.

BY _____ CHAIRMAN

ATTEST _____ CLERK

FLOOD INSURANCE RATE MAP INFORMATION	
COMMUNITY NUMBER: 120067	PANEL NUMBER: 215G,225G
PROGRAM: REGULAR	EFFECTIVE DATE: NOV. 17, 2005
FLOOD ZONE: ALL <u>X</u> OR AS SHOWN ON MAP.	
WIND ZONE: ALL <u>127</u> OR AS SHOWN ON MAP.	
COLLIER COUNTY, FLORIDA	
COMMUNITY DEVELOPMENT DIVISION	
TWP 48S RNG 26E	SEC(S) 9 NO 1/2
SCALE	MAP NUMBER:
0 400	8609N