

The Historic/Archaeological Probability Maps are the official County source designating historic or archaeological resources.

LAST REVISION: ZONING _____ OTHER _____

8612N

8611S

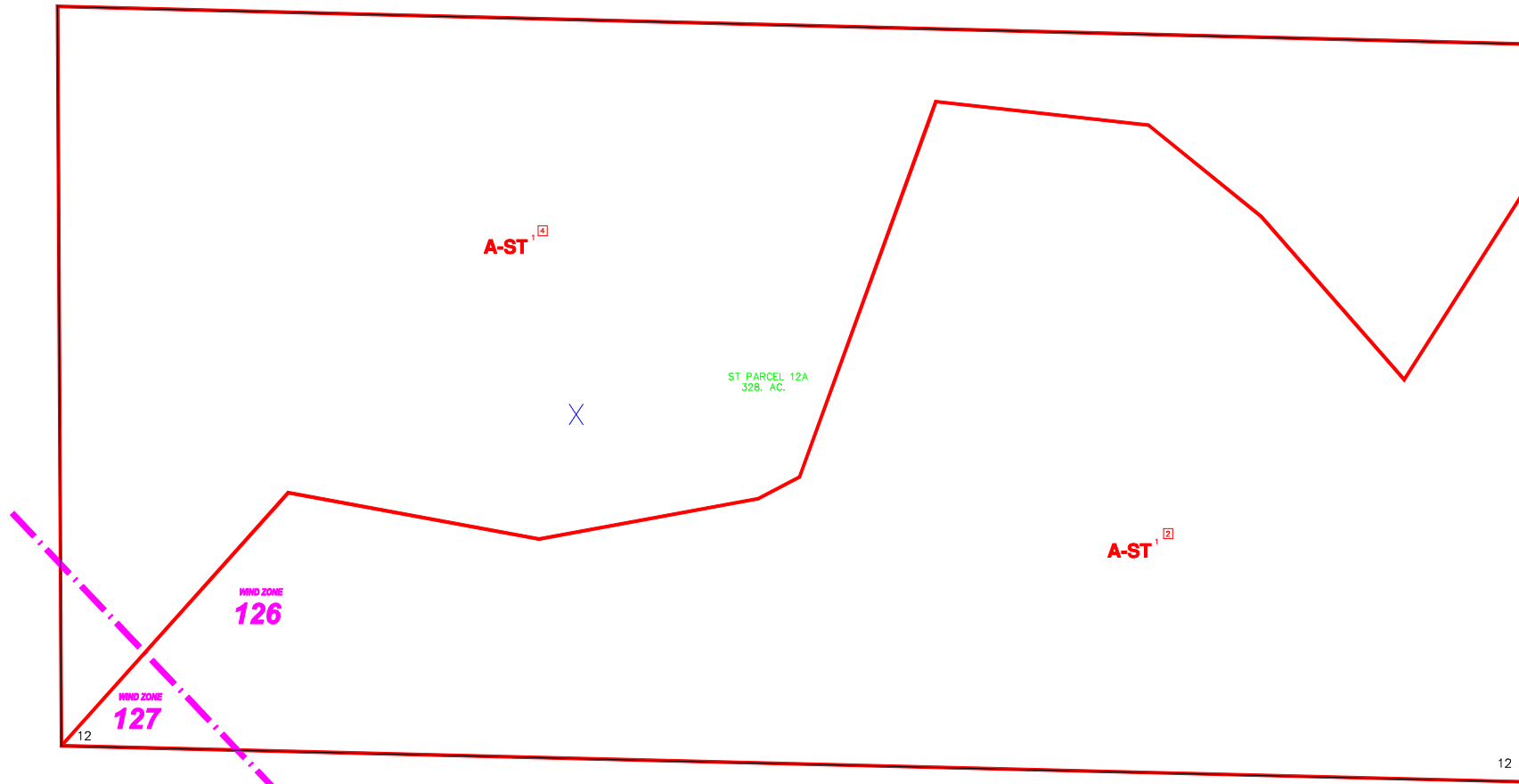

482728

8613N

----- INDICATES SPECIAL TREATMENT OVERLAY
 - - - - - INDICATES WIND ZONE BOUNDARY LINE

SUBDIVISION INDEX							
NO.	NAME	P.B.	Pg.	NO.	NAME	P.B.	Pg.
11				11			
12				12			
13				13			
14				14			
15				15			
16				16			
17				17			
18				18			
19				19			
20				20			

ZONING NOTES
 1 LDC-91
 2 11/17/2005

ZONING OVERLAY NOTES:
 OVERLAYS CREATED BY
 LDC ORD. No. 04-08 1-7-04
 2 REUDO-RECEIVING LANDS
 4 REUDO-SENDING LANDS-HRPPA

THIS IS TO CERTIFY THAT THIS IS A PAGE OF THE OFFICIAL ZONING ATLAS REFERRED TO AND ADOPTED BY RESOLUTION NO. 04-41 OF THE COUNTY OF COLLIER, FLORIDA, ADOPTED JUNE 22, 2004.

BY _____ CHAIRMAN
 ATTEST _____ CLERK

FLOOD INSURANCE RATE MAP INFORMATION	
COMMUNITY NUMBER: 120067	PANEL NUMBER: 225G
PROGRAM: REGULAR	EFFECTIVE DATE: NOV. 17, 2005
FLOOD ZONE: ALL <u>X</u> OR AS SHOWN ON MAP.	
WIND ZONE: ALL _____ OR AS SHOWN ON MAP.	
COLLIER COUNTY, FLORIDA	
COMMUNITY DEVELOPMENT DIVISION	
TWP 48S RING 26E SEC(S) 12 SO 1/2	
SCALE	MAP NUMBER:
0 400	8612S