

The Historic/Archaeological Probability Maps are the official County source designating historic or archaeological resources.

LAST REVISION: ZONING _____ OTHER _____

8608S

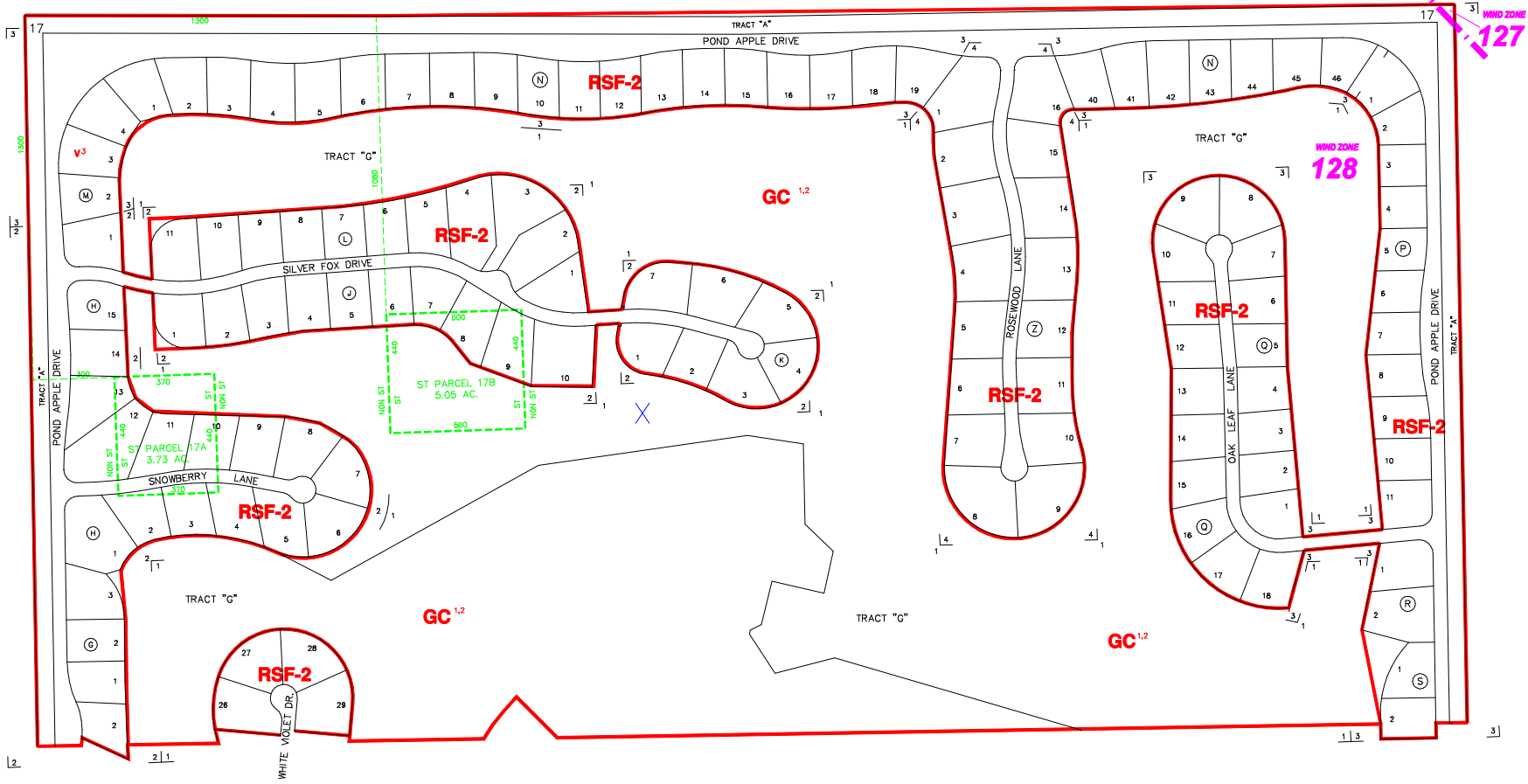

----- INDICATES SPECIAL TREATMENT OVERLAY
 - - - - - INDICATES WIND ZONE BOUNDARY LINE

8617S

SUBDIVISION INDEX							
NO.	NAME	P.B.	Pg.	NO.	NAME	P.B.	Pg.
1	QUAIL CREEK UNIT 1	13	19-26	11			
2	QUAIL CREEK UNIT 2	13	124-125	12			
3	QUAIL CREEK UNIT 3	14	17-20	13			
4	QUAIL CREEK UNIT 4	13	47	14			
5	QUAIL CREEK BLOCK "A"			15			
				16			
				17			
				18			
				19			
				20			

ZONING NOTES
 1-13-06 86-12
 2-13-06 86-27
 3-13-06 86-28
 4-22-04 86-29
 5-11-04 86-30
 6-22-04 86-31
 7-11-04 86-32
 8-11-04 86-33

THIS IS TO CERTIFY THAT THIS IS A PAGE OF THE OFFICIAL ZONING ATLAS REFERRED TO AND ADOPTED BY REFERENCE BY ORDINANCE NO. 04-41 OF THE COUNTY OF COLLIER, FLORIDA, ADOPTED JUNE 22, 2004.

BY _____ CHAIRMAN
 ATTEST _____ CLERK

FLOOD INSURANCE RATE MAP INFORMATION
 COMMUNITY NUMBER: 120067 PANEL NUMBER: 215G
 PROGRAM: REGULAR EFFECTIVE DATE: NOV. 17, 2005
 FLOOD ZONE: ALL X, X, OR AS SHOWN ON MAP.
 WIND ZONE: ALL _____ OR AS SHOWN ON MAP.

COLLIER COUNTY, FLORIDA
 COMMUNITY DEVELOPMENT DIVISION
 TWP 48S RING 26E SEC(S) 17 N 1/2
 SCALE 0 400
 MAP NUMBER: 8617N