

The Historic/Archaeological Probability Maps are the official County source designating historic or archaeological resources.

LAST REVISION: ZONING _____ OTHER _____

8627N

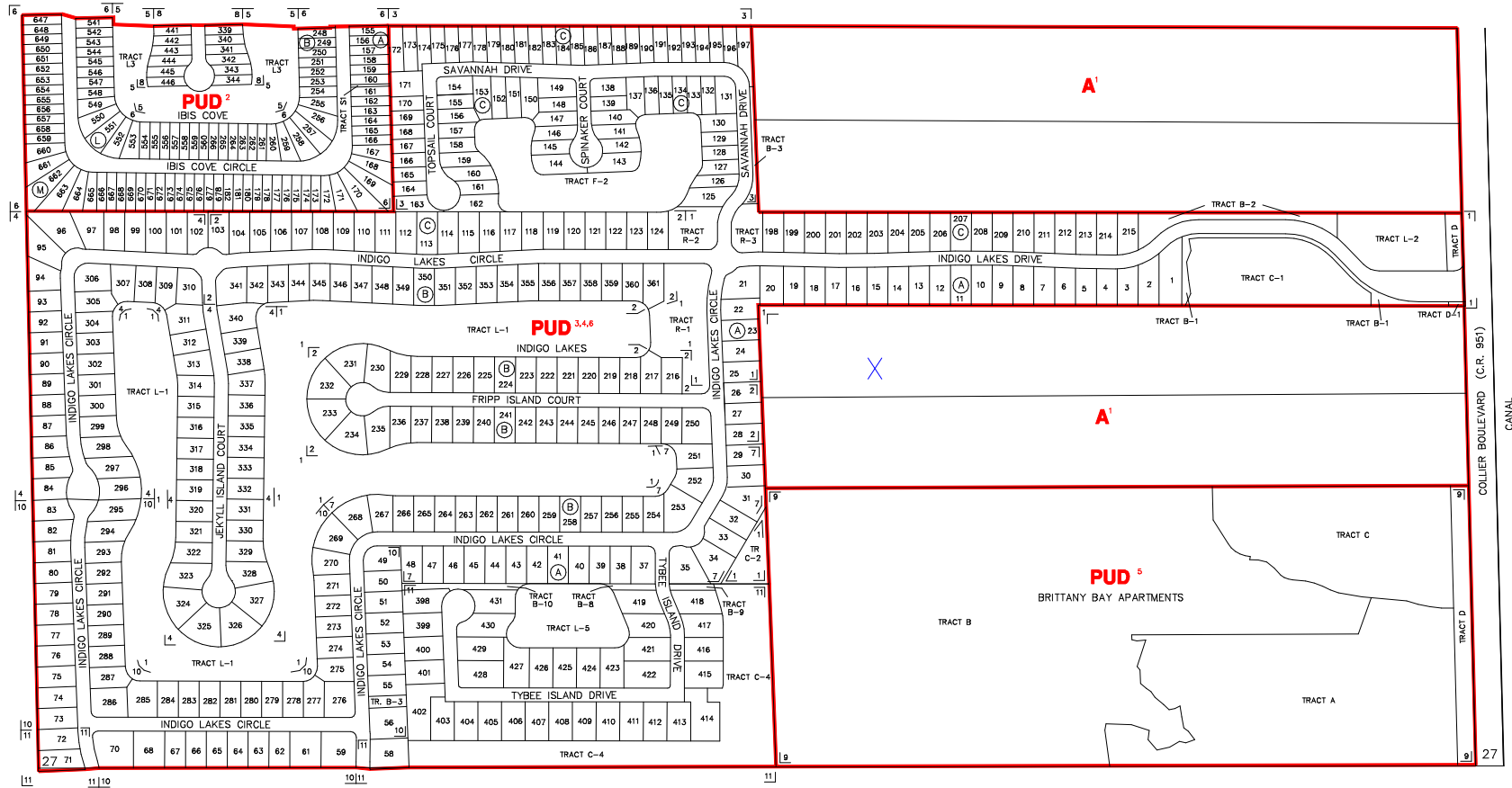

8626S

8628S

8634N

SUBDIVISION INDEX							
NO.	NAME	P.B.	Pg.	NO.	NAME	P.B.	Pg.
1	INDIGO LAKES - UNIT ONE	34	76-84	11	INDIGO PRESERVE	40	54-57
2	INDIGO LAKES - UNIT TWO	35	8-10	12			
3	INDIGO LAKES - UNIT THREE	35	11-12	13			
4	INDIGO LAKES - UNIT FOUR	35	69-72	14			
5	IBIS COVE PHASE ONE	35	52-88	15			
6	IBIS COVE PHASE TWO-A	37	78-83	16			
7	INDIGO LAKES - UNIT FIVE	38	15-17	17			
8	IBIS COVE PHASE TWO-B	38	1-2	18			
9	CAMDEN COVE	39	24-29	19			
10	INDIGO LAKES - UNIT SIX	39	73-76	20			

ZONING NOTES
 1 LDC-51 PUD-98-22 98-21
 2 LDC-51 PUD-88-27 88-9
 3 LDC-51 PUD-88-27 88-9
 4 LDC-51 PUD-08-10 08-71
 5 LDC-51 PUD-08-10 08-71
 6 LDC-51 PUD-01-48-132 01-53
 7 LDC-51 PUD-01-48-132 01-53
 8 LDC-51 PUD-01-48-132 01-53
 9 LDC-51 PUD-01-48-132 01-53
 10 LDC-51 PUD-01-48-132 01-53

THIS IS TO CERTIFY THAT THIS IS A PAGE OF THE OFFICIAL ZONING ATLAS REFERRED TO AND ADOPTED BY REFERENCE BY ORDINANCE NO. 04-41 OF THE COUNTY OF COLLIER, FLORIDA, ADOPTED JUNE 22, 2004.

BY _____ CHAIRMAN
 ATTEST _____ CLERK

FLOOD INSURANCE RATE MAP INFORMATION	
COMMUNITY NUMBER: 120067	PANEL NUMBER: 215G
PROGRAM: REGULAR	EFFECTIVE DATE: NOV. 17, 2005
FLOOD ZONE: ALL X OR AS SHOWN ON MAP.	
WIND ZONE: ALL 128 OR AS SHOWN ON MAP.	
COLLIER COUNTY, FLORIDA	
COMMUNITY DEVELOPMENT DIVISION	
TWP 48S RING 26E SEC(S) 27 SO 1/2	
SCALE	MAP NUMBER: 8627S