

8714S

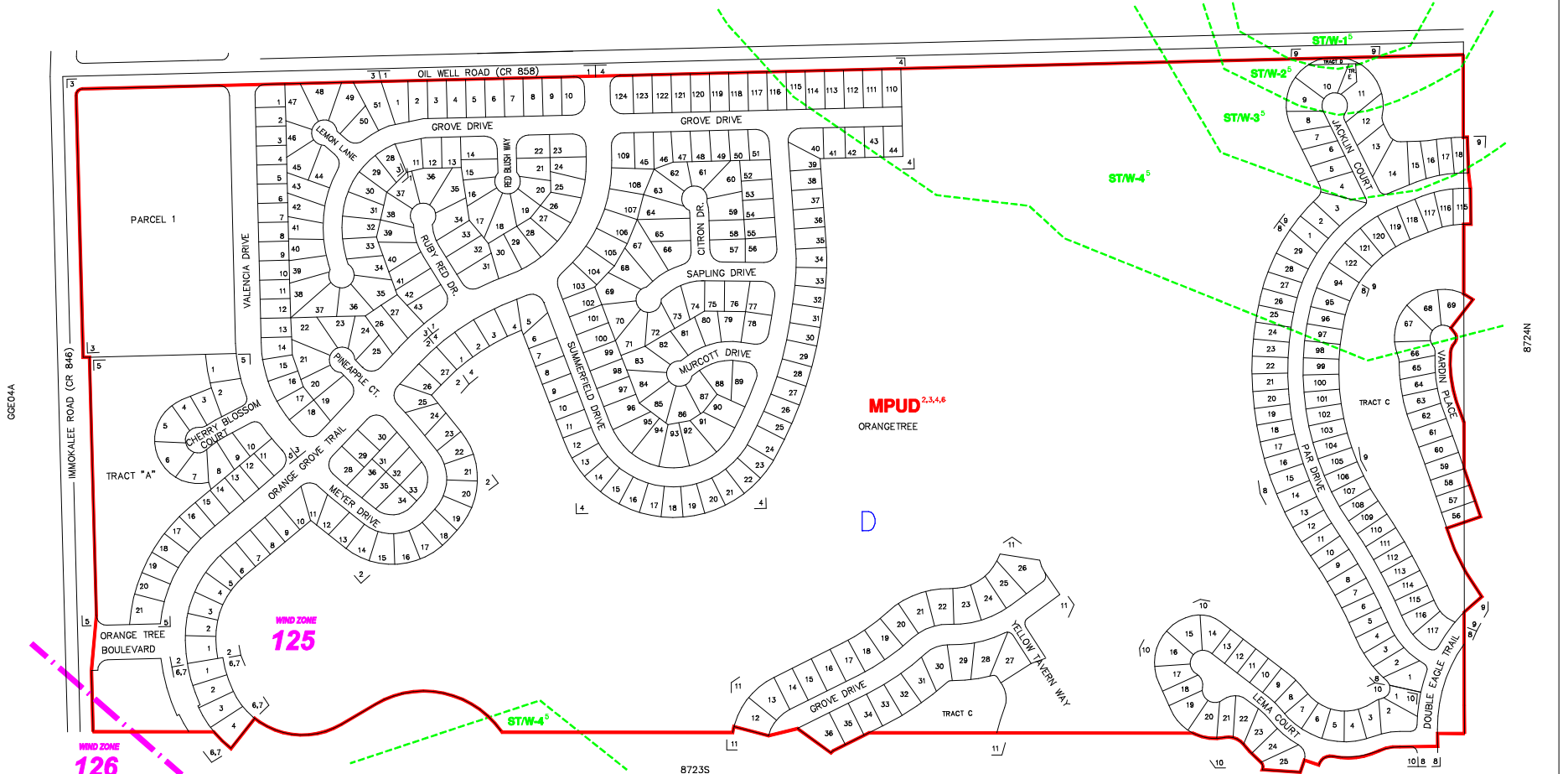

----- INDICATES SPECIAL TREATMENT OVERLAY
 - - - - - INDICATES WIND ZONE BOUNDARY LINE

SUBDIVISION INDEX							
NO.	NAME	P.B.	Pg.	NO.	NAME	P.B.	Pg.
1	ORANGETREE UNIT ONE-CITRUS GREENS SECT. PH.1-A	14	92-93	11	VALENCIA LAKES - PHASE 6-A	48	67-70
2	ORANGETREE UNIT TWO-CITRUS GREENS SECT. PH.4-A	14	113	12			
3	ORANGETREE UNIT THREE-CITRUS GREENS SECT. PH.1-A	14	121	13			
4	ORANGETREE UNIT FOUR-CITRUS GREENS SECT. PH.2-A	14	124-125	14			
5	LAKE LUCERNE	24	48-49	15			
6	VALENCIA LAKES	35	86-88	16			
7	VALENCIA LAKES - PHASE 1-A	36	25-27	17			
8	VALENCIA GOLF AND COUNTRY CLUB - PHASE 1	40	33-39	18			
9	VALENCIA GOLF AND COUNTRY CLUB - PHASE 1A	42	36-41	19			
10	VALENCIA GOLF AND COUNTRY CLUB - PHASE 2A	46	43-47	20			

ZONING NOTES
 1 8-15-05
 2 5-28-01
 3 1-11-04
 4 6-15-05
 5 7-28-05
 6 8-15-05
 7 8-15-05
 8 8-15-05
 9 8-15-05
 10 8-15-05

THIS IS TO CERTIFY THAT THIS IS A PAGE OF THE OFFICIAL ZONING ATLAS REFERRED TO AND ADOPTED BY REFERENCE BY ORDINANCE NO. 04-41 OF THE COUNTY OF COLLIER, FLORIDA, ADOPTED JUNE 22, 2004.

BY _____ CHAIRMAN
 ATTEST _____ CLERK

FLOOD INSURANCE RATE MAP INFORMATION	
COMMUNITY NUMBER: 120067	PANEL NUMBER: 250G
PROGRAM: REGULAR	EFFECTIVE DATE: NOV. 17, 2005
FLOOD ZONE: ALL D OR AS SHOWN ON MAP.	
WIND ZONE: ALL _____ OR AS SHOWN ON MAP.	
COLLIER COUNTY, FLORIDA	
COMMUNITY DEVELOPMENT DIVISION	
TWP 48S RING 27E SEC(S) 23 NO 1/2	
SCALE	MAP NUMBER:
0 400	8723N