

482728

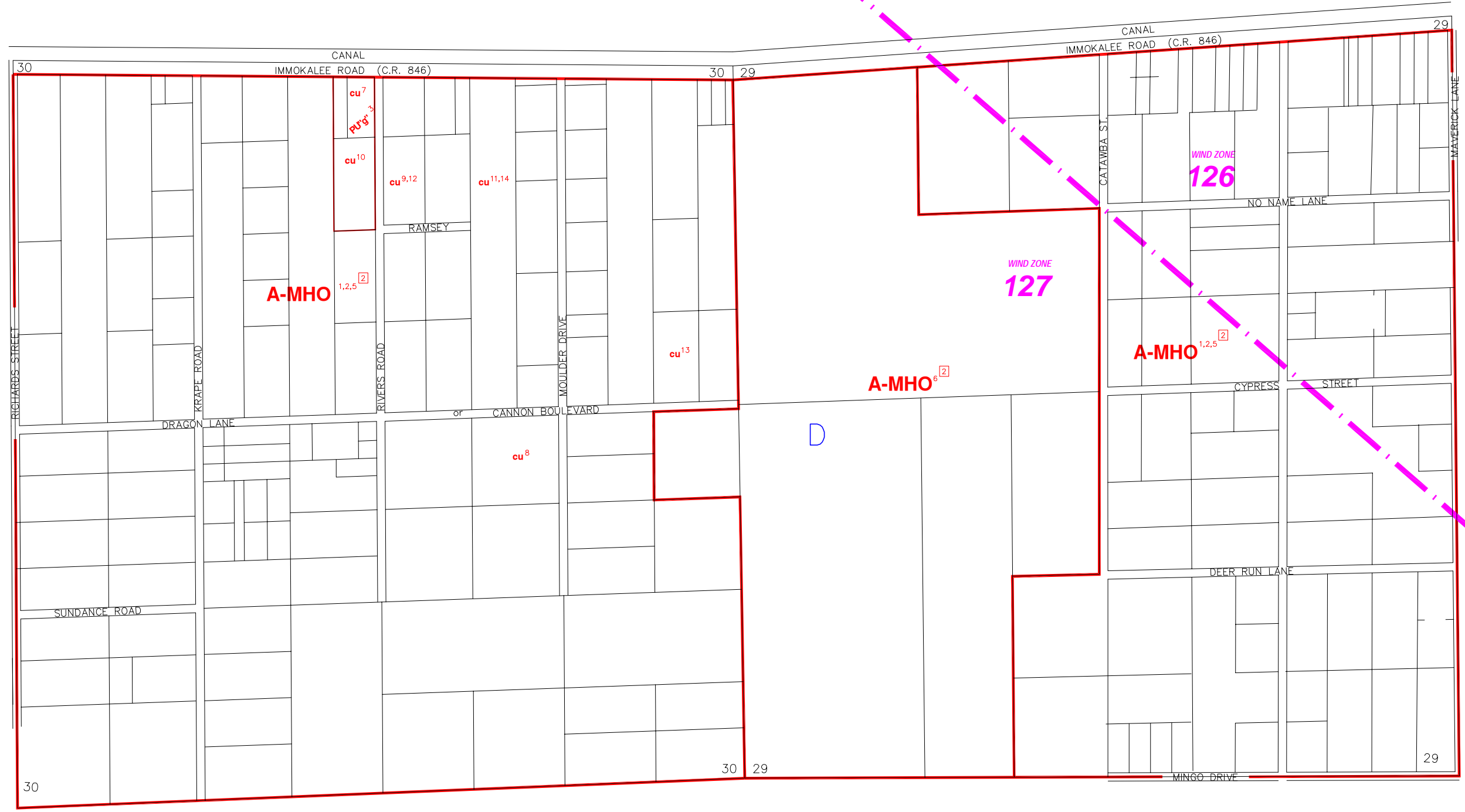

862526

872728  
GGEO4 UNIT 20

873132

INDICATES WIND ZONE BOUNDARY LINE

SUBDIVISION INDEX			
NO.	NAME	P.B.	Pg.
1			
2			
3			
4			
5			
6			
7			
8			
9			
10			

- ZONING NOTES**
- 1 4-20-82 R-82-2-1
  - 2 LDC-91
  - 3 10-22-91 PU-91-13 91-748
  - 4 5-23-95 R-95-2 95-38
  - 5 3-10-98 R-97-11 98-17
  - 6 4-13-99 CU-99-1 99-200
  - 7 10-26-99 CU-99-12 99-398
  - 8 10-22-02 CU-02-AR-1943 02-435
  - 9 12-2-03 CU-03-AR-3906 03-427
  - 10 1-24-06 CU-06-AR-6568 06-21
  - 11 1-13-09 CU-08-AR-13060 09-5
  - 12 9-15-09 CUE-08-AR-13803 09-213

**ZONING OVERLAY NOTES:**  
 OVERLAYS CREATED BY  
 LDC ORD. No. 04-08 1-7-04  
 [2] REMJQ-RECEIVING LANDS

THIS IS TO CERTIFY THAT THIS IS A PAGE OF THE OFFICIAL ZONING ATLAS REFERRED TO AND ADOPTED BY REFERENCE BY ORDINANCE NO. 04-41 OF THE COUNTY OF COLLIER, FLORIDA, ADOPTED JUNE 22, 2004.

BY \_\_\_\_\_ CHAIRMAN  
 ATTEST \_\_\_\_\_ CLERK

**FLOOD INSURANCE RATE MAP INFORMATION**

COMMUNITY NUMBER: 120067 PANEL NUMBER: 225G  
 PROGRAM: REGULAR EFFECTIVE DATE: NOV. 17, 2005  
 FLOOD ZONE: ALL D OR AS SHOWN ON MAP.  
 WIND ZONE: ALL \_\_\_\_\_ OR AS SHOWN ON MAP.

COLLIER COUNTY, FLORIDA  
 COMMUNITY DEVELOPMENT DIVISION  
 TWP 48S RNG 27E SEC(S) 29 & 30  
 SCALE 0 800 MAP NUMBER: 872930