

8908S

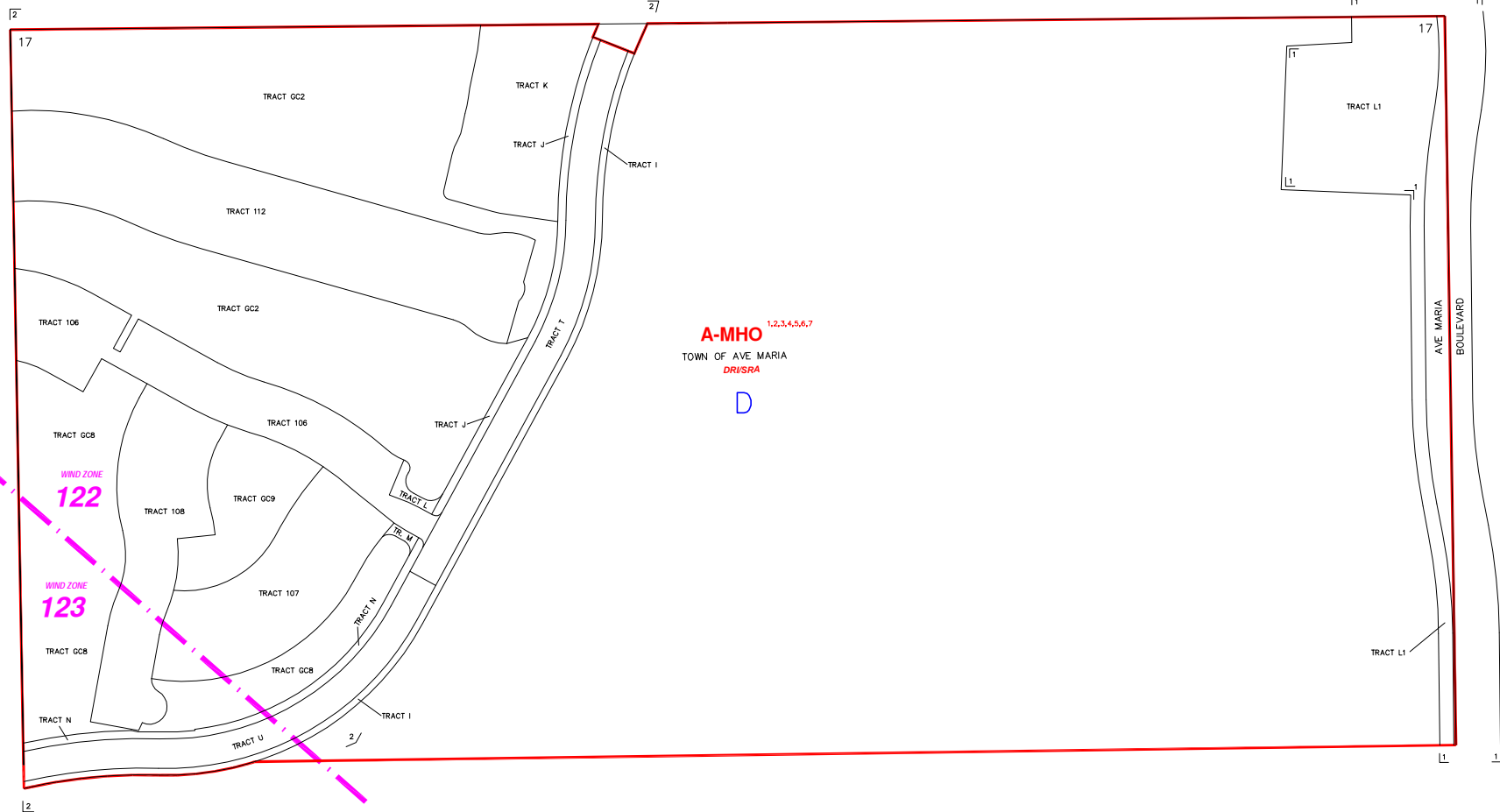

A-MHO 1,2,3,4,5,6,7
 TOWN OF AVE MARIA
 DR/SRA
 D

WIND ZONE
122
 WIND ZONE
123

INDICATES WIND ZONE BOUNDARY LINE

8917S

SUBDIVISION INDEX			
NO.	NAME	P.B.	Pg.
1	AVE MARIA PHASE ONE	46	16-29
2	AVE MARIA UNIT 3, DEL WEBB PHASE ONE	47	52-62

ZONING NOTES
 1 DDC-914 03L-02-10-4579 04-09
 2 1-14-05 DRN-04-AR-6293 05-235
 3 1-14-05 DRN-04-AR-6293 05-235
 4 1-14-05 DRN-04-AR-6293 05-235
 5 1-14-05 DRN-04-AR-6293 05-235
 6 1-14-05 DRN-04-AR-6293 05-235
 7 1-14-05 DRN-04-AR-6293 05-235
 8 1-14-05 DRN-04-AR-6293 05-235
 9 1-14-05 DRN-04-AR-6293 05-235
 10 1-14-05 DRN-04-AR-6293 05-235

THIS IS TO CERTIFY THAT THIS IS A PAGE OF THE OFFICIAL ZONING ATLAS REFERRED TO AND ADOPTED BY REFERENCE BY ORDINANCE NO. 04-41 OF THE COUNTY OF COLLIER, FLORIDA, ADOPTED JUNE 22, 2004.

BY _____ CHAIRMAN
 ATTEST _____ CLERK

FLOOD INSURANCE RATE MAP INFORMATION	
COMMUNITY NUMBER: 120087	PANEL NUMBER: 275G
PROGRAM: REGULAR	EFFECTIVE DATE: NOV. 17, 2005
FLOOD ZONE: ALL <u>D</u> OR AS SHOWN ON MAP.	
WIND ZONE: ALL _____ OR AS SHOWN ON MAP.	
COLLIER COUNTY, FLORIDA	
COMMUNITY DEVELOPMENT DIVISION	
TWP48S RING 29E SEC(S) 17 NO 1/2	MAP NUMBER: 8917N

