

The Historic/Archaeological Probability Maps are the official County source designating historic or archaeological resources.

LAST REVISION: ZONING _____ OTHER _____

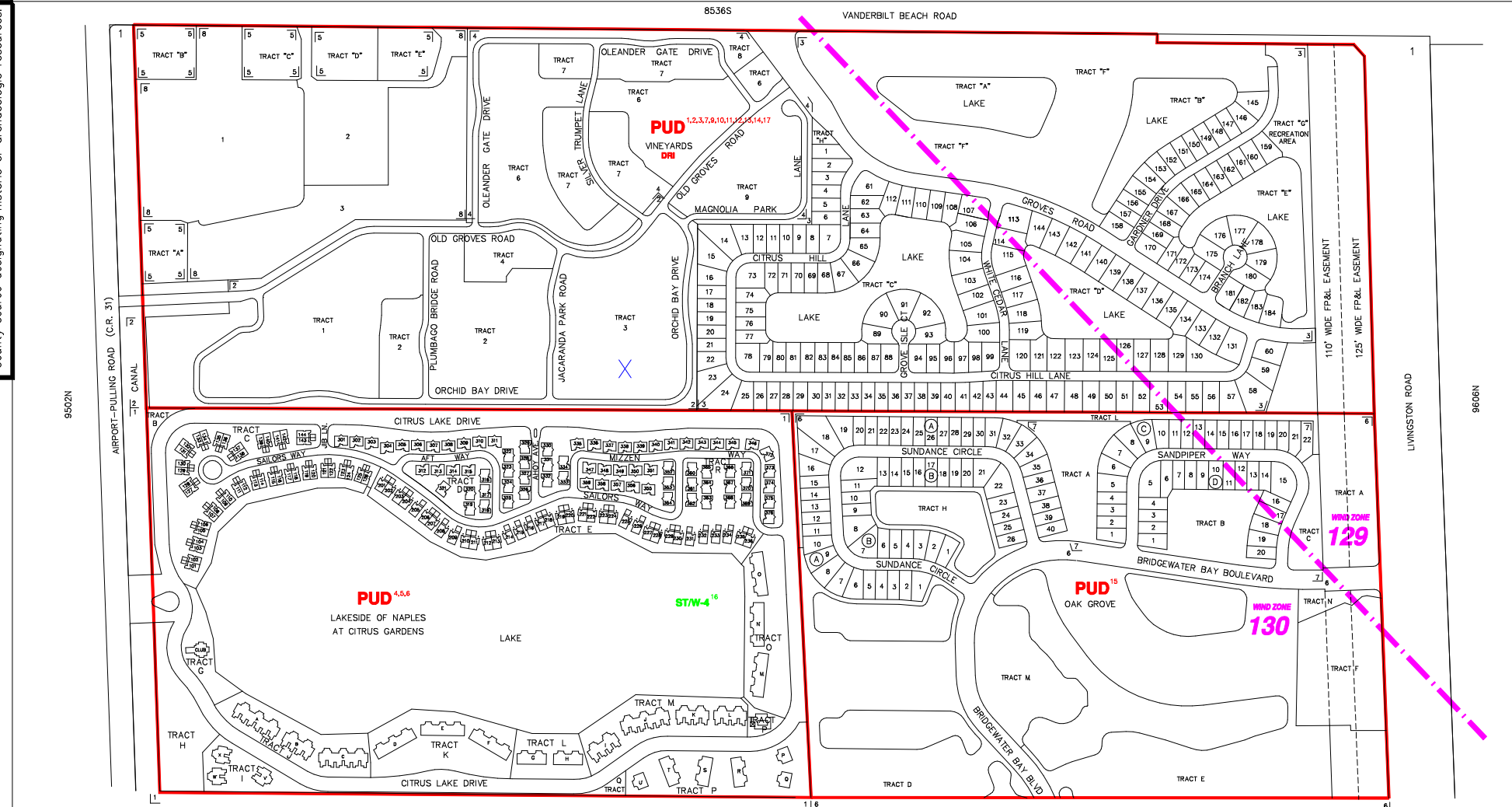

--- INDICATES SPECIAL TREATMENT OVERLAY
 - - - - - INDICATES WIND ZONE BOUNDARY LINE

SUBDIVISION INDEX			
NO.	NAME	P.B.	Pg.
1	LAKESIDE OF NAPLES AT CITRUS GARDENS	15	83-88
2	PIPER'S GROVE PHASE ONE	20	97-99
3	THE GROVARDS	22	78-82
4	PIPER'S GROVE PHASE TWO	23	71-73
5	NAPLES WALK	34	94-95
6	BRIDGEWATER BAY, UNIT ONE	36	87-93
7	BRIDGEWATER BAY, UNIT TWO	38	88-100
8	NAPLES WALK UNIT TWO	41	96-97
10			

ZONING NOTES
 1 5-7-05 R-05-156
 2 8-10-07 SC 204-085-06
 3 8-28-06 SC
 4 8-28-06 SC
 5 8-28-06 SC
 6 8-28-06 SC
 7 8-28-06 SC
 8 8-28-06 SC
 9 8-28-06 SC
 10 8-28-06 SC
 11 7-21-04 PD-04-15 84-129
 12 11-11-04 PD-04-15 84-129
 13 11-11-04 PD-04-15 84-129
 14 9-8-08 PD-08-14 88-52
 15 8-15-08 PD-08-14 88-52
 16 2-28-08 PD-08-14 88-52
 17 2-28-08 PD-08-14 88-52
 18 2-28-08 PD-08-14 88-52
 19 2-28-08 PD-08-14 88-52
 20 2-28-08 PD-08-14 88-52

THIS IS TO CERTIFY THAT THIS IS A PAGE OF THE OFFICIAL ZONING ATLAS REFERRED TO AND ADOPTED BY ORDINANCE NO. 04-41 OF THE COUNTY OF COLLIER, FLORIDA, ADOPTED JUNE 22, 2004.

BY _____ CHAIRMAN
 ATTEST _____ CLERK

FLOOD INSURANCE RATE MAP INFORMATION	
COMMUNITY NUMBER: 120067	PANEL NUMBER: 385G
PROGRAM: REGULAR	EFFECTIVE DATE: NOV. 17, 2005
FLOOD ZONE: ALL_X OR AS SHOWN ON MAP.	
WIND ZONE: ALL_X OR AS SHOWN ON MAP.	
COLLIER COUNTY, FLORIDA	
COMMUNITY DEVELOPMENT DIVISION	
TWP 49S RNG 25E SEC(S) 1 NO 1/2	
SCALE	MAP NUMBER: 9501N