

The Historic/Archaeological Probability Maps are the official County source designating historic or archaeological resources.

9504S

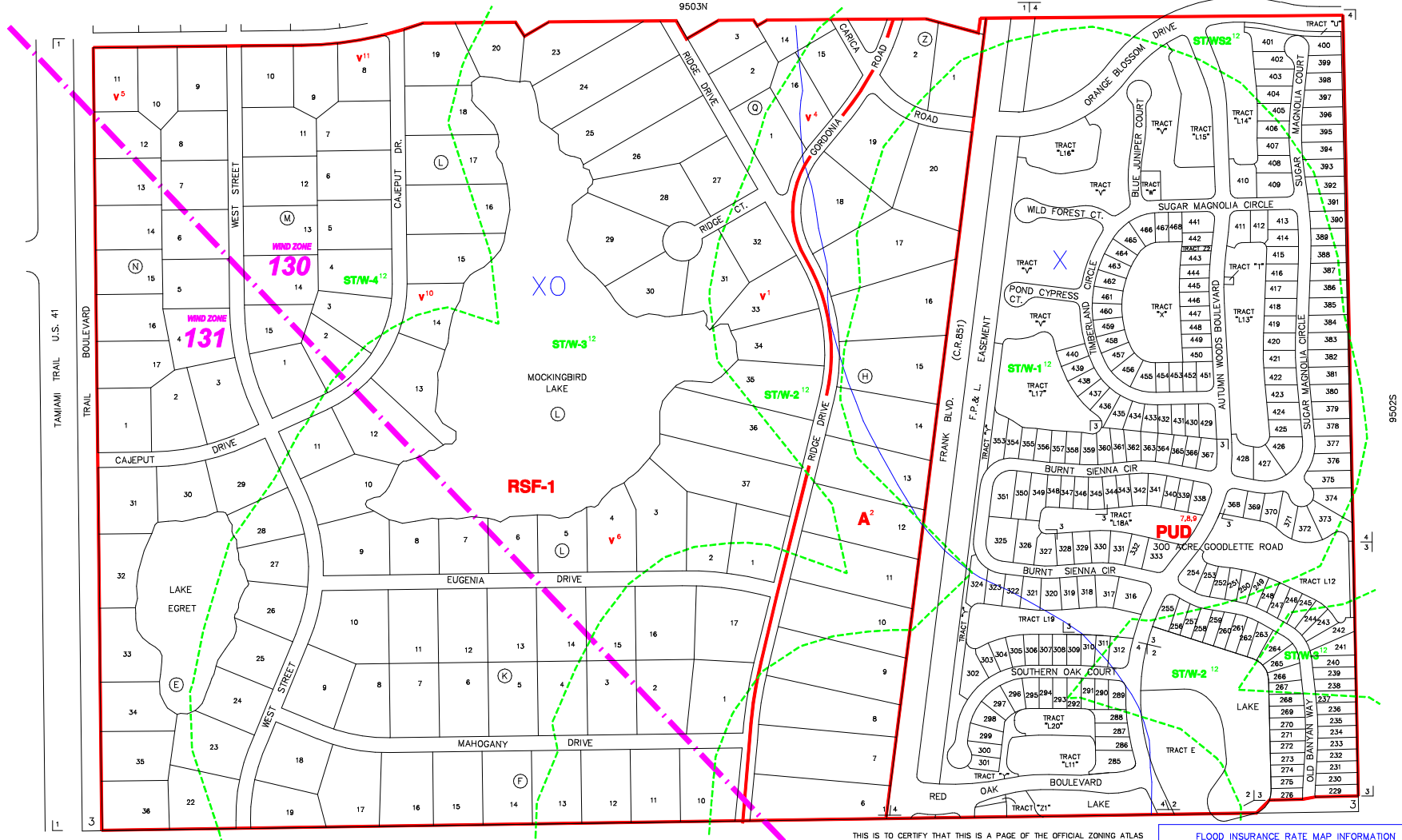

--- INDICATES SPECIAL TREATMENT OVERLAY  
 - - - - - INDICATES WIND ZONE BOUNDARY LINE

SUBDIVISION INDEX							
NO.	NAME	P.B.	Pg.	NO.	NAME	P.B.	Pg.
1	PINE RIDGE EXTENSION			11			
2	AUTUMN WOODS UNIT ONE	3	51	12			
3	AUTUMN WOODS UNIT THREE	28	27-32	13			
4	AUTUMN WOODS UNIT FOUR	33	61-64	14			
		35	79-83	15			
				16			
				17			
				18			
				19			
				20			

**ZONING NOTES**

1 11-14-89 V-89-15 89-306  
 2 DC-91  
 3 4-26-92 V-92-4 92-288  
 4 8-3-94 V-94-273 94-379  
 5 7-29-95 PUD-94-1 95-5  
 6 4-16-98 PD-98-1 98-13  
 7 2-24-98 V-97-15 98-35  
 8 2-24-98 V-97-15 98-35  
 9 8-3-99 V-99-9 99-323  
 10 2-19-00 DC Ord. 00-27  
 11 2-19-00 DC Ord. 00-27

THIS IS TO CERTIFY THAT THIS IS A PAGE OF THE OFFICIAL ZONING ATLAS REFERRED TO AND ADOPTED BY REFERENCE BY ORDINANCE NO. 04-41 OF THE COUNTY OF COLLIER, FLORIDA, ADOPTED JUNE 22, 2004.

BY \_\_\_\_\_ CHAIRMAN

ATTEST \_\_\_\_\_ CLERK

FLOOD INSURANCE RATE MAP INFORMATION

COMMUNITY NUMBER: 120067 PANEL NUMBER 381G

PROGRAM: REGULAR EFFECTIVE DATE: NOV. 17, 2005

FLOOD ZONE: ALL \_\_\_\_\_ OR AS SHOWN ON MAP.

WIND ZONE: ALL \_\_\_\_\_ OR AS SHOWN ON MAP.

COLLIER COUNTY, FLORIDA

COMMUNITY DEVELOPMENT DIVISION

TWP 49S RING 25E SEC(5) 03 SO 1/2

SCALE \_\_\_\_\_ MAP NUMBER: 9503S