

9502S

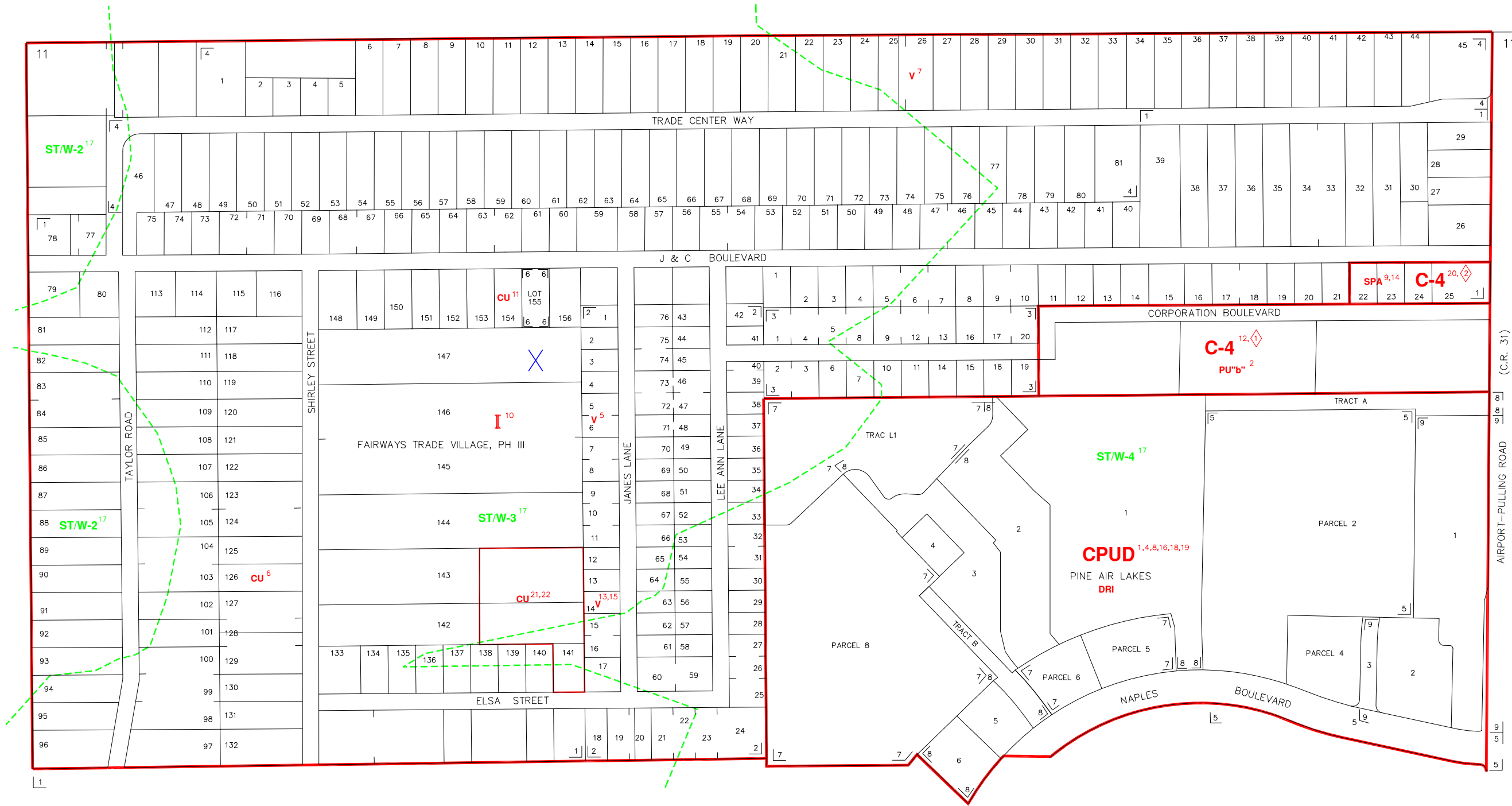

9510N

9512N

9511S

--- INDICATES SPECIAL TREATMENT OVERLAY

SUBDIVISION INDEX							
NO.	NAME	P.B.	Pg.	NO.	NAME	P.B.	Pg.
1	J & C INDUSTRIAL PARK (UNRECORDED)			11			
2	INDUSTRIAL VILLAGE			12			
3	INDUSTRIAL VILLAGE NO.2			13			
4	TRADE CENTER OF NAPLES	15	54-55	14			
5	PINE AIR LAKES UNIT ONE	24	98-101	15			
6	LOT 155 J & C INDUSTRIAL PARK	25	25-27	16			
7	PINE AIR LAKES UNIT 2	32	69-72	17			
8	PINE AIR LAKES UNIT 3	38	25-27	18			
9	PINE AIR LAKES UNIT 4	38	51-53	19			
10				20			

- ZONING NOTES**
- 11-12-85 R-84-26C
 - 11-26-81 PU-91-8 91-793 (EXPIRED)
 - 1-7-92 PUD-91-13 92-1
 - 3-24-92 V-92-2 92-190
 - 5-25-93 CU-93-5 93-215
 - 6-8-93 V-93-8 93-235
 - 8-10-94 PUD-94-25(1,94-25)
 - 5-9-95 SPA-95-1095-130 94-2
 - 5-23-95 R-95-2 95-38
 - 1-23-96 CU-95-22 96-29
 - 4-23-96 R-96-5 96-20
 - 12-17-96 V-96-26 96-595
 - 2-10-98 SPA-97-1 98-38
 - 6-8-99 V-99-3 99-126
 - 8-15-04 LDC 080-05-2317 04-310
 - 3-13-07 DOA-05-AR-8543 07-63
 - 1-29-08 RZ-08-AR-10422 08-03
 - 2-9-08 CU-08-1519 08-375
 - 6-9-09 SE-09-AR-14297 09-151

- DEVELOPMENT STANDARDS MODIFICATIONS**
- 4-23-96 R-96-5 96-20
 - 1-29-08 RZ-08-AR-10422 08-03

THIS IS TO CERTIFY THAT THIS IS A PAGE OF THE OFFICIAL ZONING ATLAS REFERRED TO AND ADOPTED BY REFERENCE BY ORDINANCE NO. 04-41 OF THE COUNTY OF COLLIER, FLORIDA, ADOPTED JUNE 22, 2004.

BY _____ CHAIRMAN
 ATTEST _____ CLERK

FLOOD INSURANCE RATE MAP INFORMATION

COMMUNITY NUMBER: 120067 PANEL NUMBER: 381G,383G,385G
 PROGRAM: REGULAR EFFECTIVE DATE: NOV. 17, 2005
 FLOOD ZONE: ALL X OR AS SHOWN ON MAP.
 WIND ZONE: ALL 130 OR AS SHOWN ON MAP.

COLLIER COUNTY, FLORIDA
 COMMUNITY DEVELOPMENT DIVISION
 TWP 49S RNG 25E SEC(S) 11 NO 1/2
 SCALE 0 400
 MAP NUMBER: 9511N