

9512N

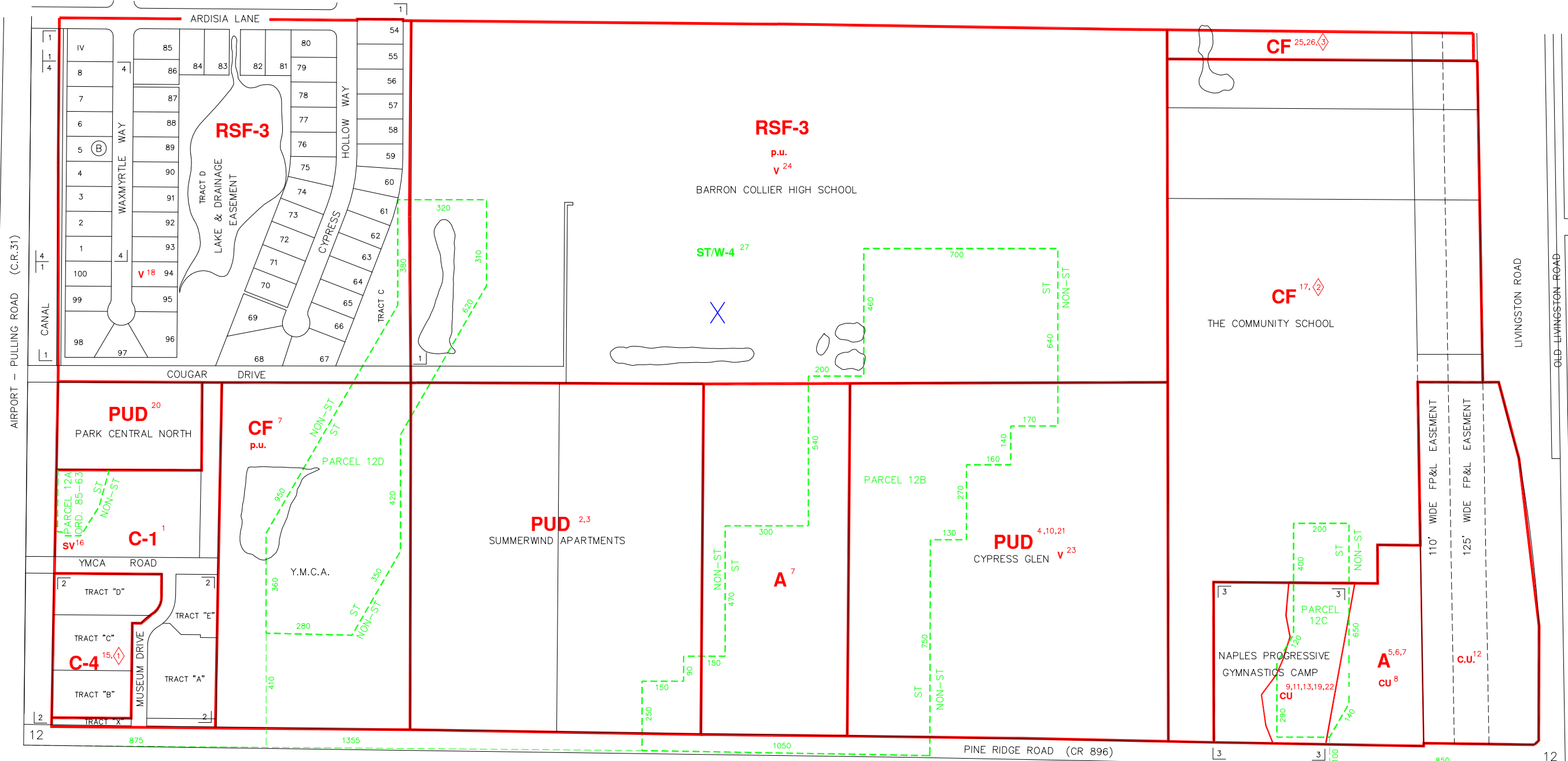

9511S

CGE01

9513N

--- INDICATES SPECIAL TREATMENT OVERLAY

SUBDIVISION INDEX			
NO.	NAME	P.B.	Pg.
1	TALL PINES	12	70-71
2	AIRPORT ROAD SUBDIVISION	24	82-83
3	NAPLES PROGRESSIVE GYMNASIICS CAMP	24	84
4	TALL PINES REPLAT	27	18-19

- ZONING NOTES**
- 1 R-85-10C
  - 2 R-85-23C
  - 3 PDA-86-14C
  - 4 R-86-21C
  - 5 PU-83-23C
  - 6 R-88-3C
  - 7 LDC-91
  - 8 CU-97-26 08-101
  - 9 CU-92-2 92-68
  - 10 10-27-92 PUD-86-21(1) 92-83
  - 11 9-14-93 CU-92-2 EXT. 93-387
  - 12 8-9-94 CU-94-6 94-584
  - 13 9-17-94 CU-92-2 EXT. 94-687
  - 14 9-13-94 CU-94-9 94-685
  - 15 6-13-95 R-95-1 95-39
  - 16 4-27-99 SV-99-1 99-217
  - 17 2-22-00 V-99-30 00-64
  - 18 9-12-00 CU-00-9 00-276
  - 19 7-30-02 PUDZ-01-AR-383 01-48
  - 20 9-11-01 PUDA-02-AR-2028 02-37
  - 21 2-11-03 CU-02-AR-2836 03-75
  - 22 7-27-04 V-04-AR-5756 04-238
  - 23 5-9-01 V-00-30 01-237
  - 24 6-11-04 SV-04-AR-6538 04-33
  - 25 1-1-05 LDC 05-01
  - 26 6-15-05 LDC 05-27

- DEVELOPMENT STANDARDS MODIFICATIONS**
- 6-13-95 R-95-1 95-39
  - 1-25-00 R-99-8 00-06
  - 5-25-04 RZ-03-AR-4937 04-33

THIS IS TO CERTIFY THAT THIS IS A PAGE OF THE OFFICIAL ZONING ATLAS REFERRED TO AND ADOPTED BY REFERENCE BY ORDINANCE NO. 04-41 OF THE COUNTY OF COLLIER, FLORIDA, ADOPTED JUNE 22, 2004.

BY \_\_\_\_\_ CHAIRMAN  
 ATTEST \_\_\_\_\_ CLERK

**FLOOD INSURANCE RATE MAP INFORMATION**

COMMUNITY NUMBER: 120067 PANEL NUMBER: 385G  
 PROGRAM: REGULAR EFFECTIVE DATE: NOV. 17, 2005  
 FLOOD ZONE: ALL X OR AS SHOWN ON MAP.  
 WIND ZONE: ALL 130 OR AS SHOWN ON MAP.

COLLIER COUNTY, FLORIDA  
 COMMUNITY DEVELOPMENT DIVISION  
 TWP 49S RNG 25E SEC(S) 12 SO 1/2  
 SCALE 0 400  
 MAP NUMBER: 9512S