

95155

95225

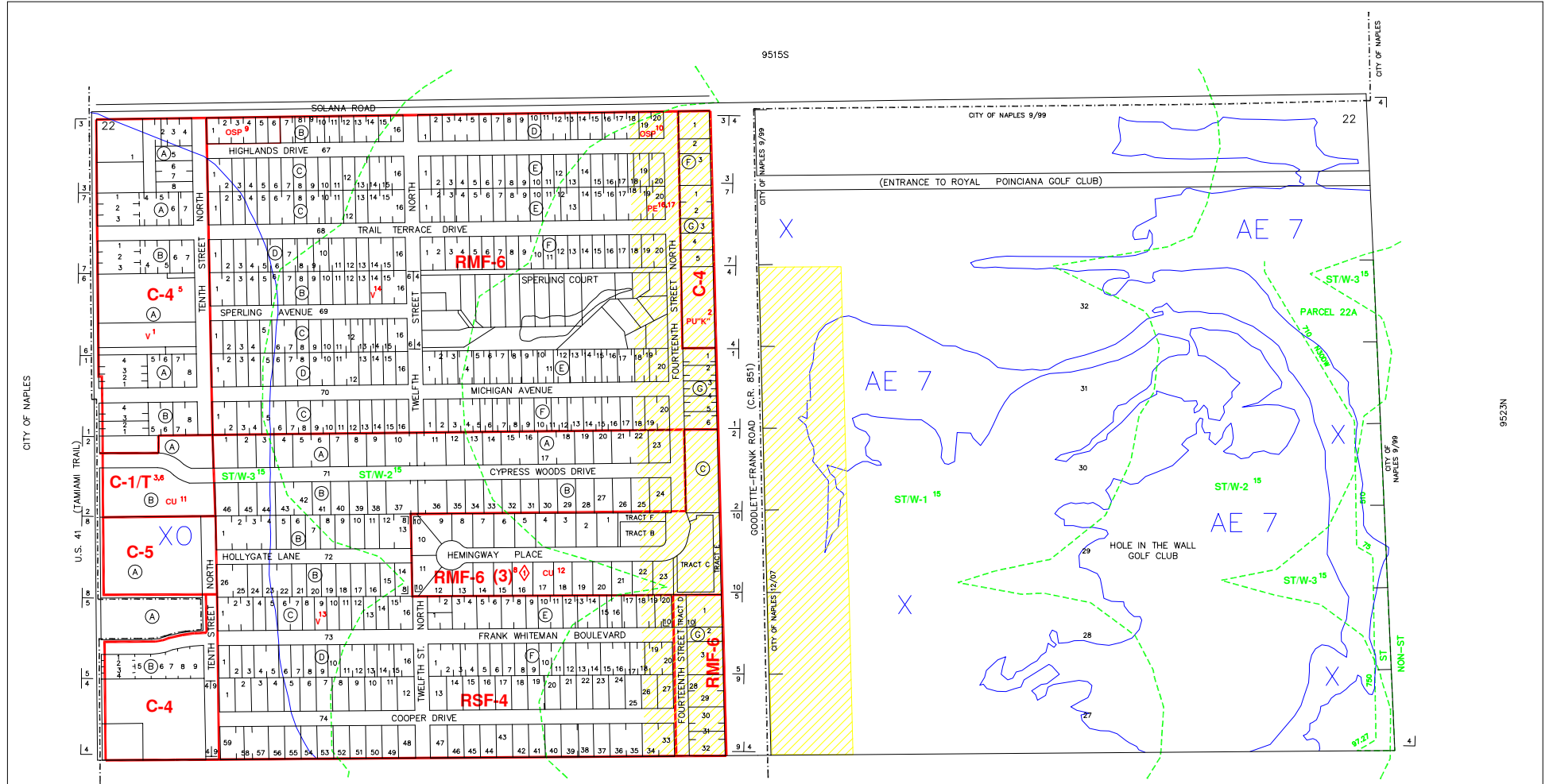

----- INDICATES CITY LIMITS
 - - - - - INDICATES SPECIAL TREATMENT OVERLAY
 // // // // // INDICATES CORRIDOR MANAGEMENT OVERLAY DISTRICT (330' OFFSET FROM R/W LINE)

SUBDIVISION INDEX			
NO.	NAME	P.B.	Pg.
1	BAD AXE	4	10
2	CYPRESS WOODS ESTATES PLAT #2	4	30
3	DEKOR HIGHLANDS	1	80
4	NAPLES IMPROVEMENT CO'S. LITTLE FARMS	2	2
5	NORTH NAPLES HIGHLANDS	2	12
6	SERLING'S SUBDIVISION UNIT 1	4	12
7	TRAIL TERRACE	4	34
8	OAK KNOLL UNIT 1	4	42
9	CARIBE WOODS	4	66
10	HEMINGWAY PLACE	39	22-23
			20

ZONING NOTES
 1-45-55 90-100
 4-16-85 1-85-55
 1-1-89 9-80-34 9-1 (20)
 1-1-89 9-80-34 9-1 (20)
 9 CORRECTION
 1-27-77 9-7
 9-22-84 02-2-84 02-2-84
 10 2-22-84 02-2-84 02-2-84
 11 12-15-85 03-08-18 04-11-85
 12 12-15-85 03-08-18 04-11-85 EXPIRED
 13 2-28-02 11-01-04-1412 04-12-12
 14 6-10-05 11-01-04-1412 04-12-12
 15 6-10-05 11-01-04-1412 04-12-12
 16 1-15-08 05-07-04-12481 08-04-04
 17 1-15-08 05-07-04-12481 08-04-04

DEVELOPMENT STANDARDS MODIFICATIONS
 6-22-82 R-82-4 82-43

THIS IS TO CERTIFY THAT THIS IS A PAGE OF THE OFFICIAL ZONING ATLAS REFERRED TO AND ADOPTED BY REFERENCE BY ORDINANCE NO. 04-41 OF THE COUNTY OF COLLIER, FLORIDA, ADOPTED JUNE 22, 2004.

BY _____ CHAIRMAN
 ATTEST _____ CLERK

FLOOD INSURANCE RATE MAP INFORMATION	
COMMUNITY NUMBER: 120067	PANEL NUMBER: 383G
PROGRAM: REGULAR	EFFECTIVE DATE: NOV. 17, 2005
FLOOD ZONE: ALL _____ OR AS SHOWN ON MAP.	
WIND ZONE: ALL 131 _____ OR AS SHOWN ON MAP.	
COLLIER COUNTY, FLORIDA	
COMMUNITY DEVELOPMENT DIVISION	
TWP 49S RING 25E SEC(S) 22 NO 1/2	
SCALE	MAP NUMBER: 9522N

9523N