

9523N

AE 7

CITY OF NAPLES

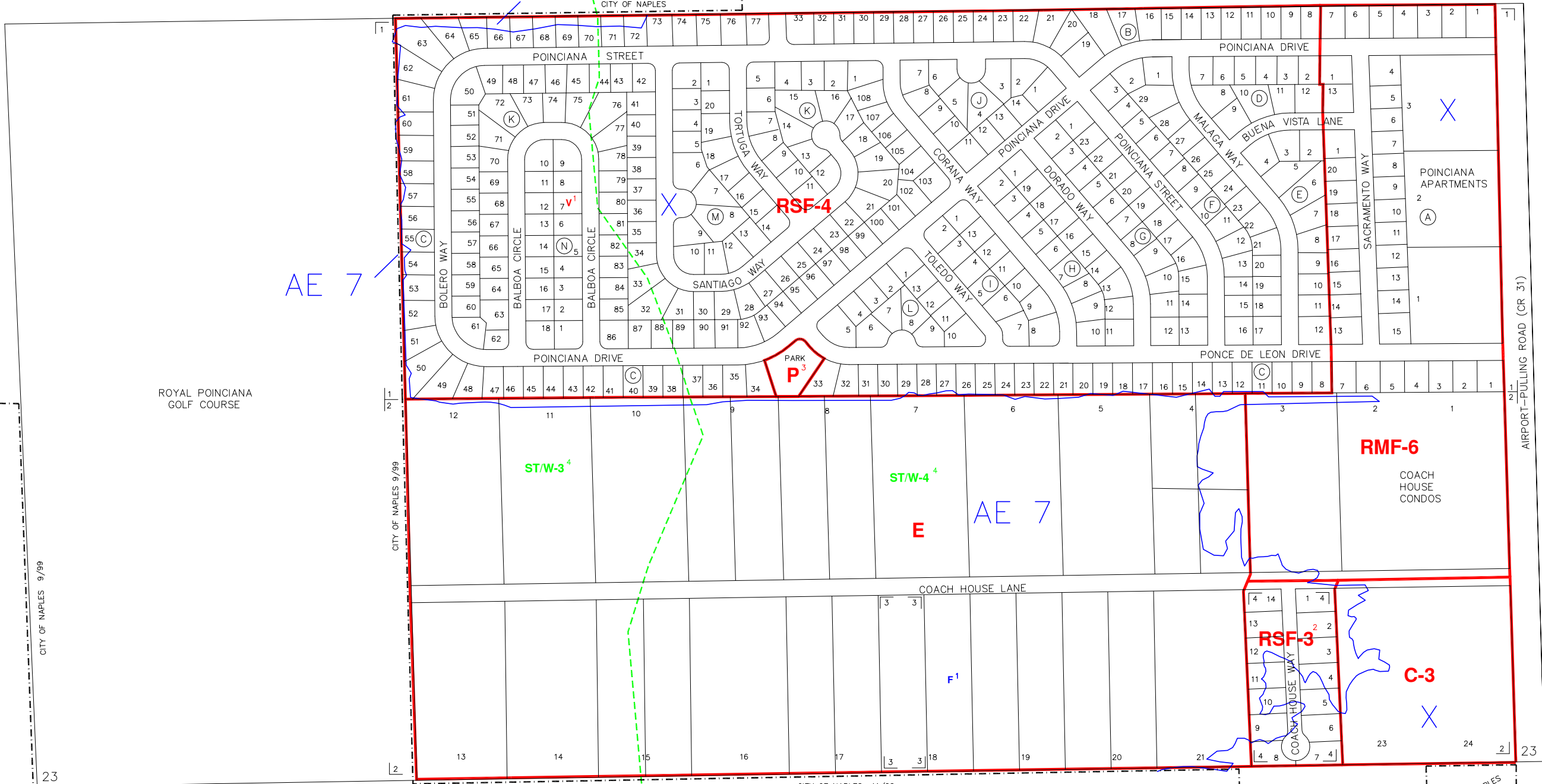

ROYAL POINCIANA GOLF COURSE

AIRPORT-PULLING ROAD (CR 31)  
CANAL

9522S

9524S

23

CITY OF NAPLES 11/88

9526N

FLOOD ZONE MAP REVISION  
1 ZONE X (LOMA) 4-27-06

--- INDICATES CITY OF NAPLES CORPORATE LIMITS  
 - - - - - INDICATES SPECIAL TREATMENT OVERLAY

SUBDIVISION INDEX

NO.	NAME	P.B.	Pg.	NO.	NAME	P.B.	Pg.
1	POINCIANA VILLAGE	8-61	10-80	11			
2	COLONIAL ACRES		UNRECORDED	12			
3	EASTON PARK AT COACH HOUSE LANE	24	97	13			
4	COACHMAN GLEN	36	1-2	14			
5				15			
6				16			
7				17			
8				18			
9				19			
10				20			

**ZONING NOTES**

- 1 V-86-4 5-13-86
- 2 LDC-91
- 3 12-13-00 LDC 00-92
- 4 6-15-05 LDC ORD. 05-27

THIS IS TO CERTIFY THAT THIS IS A PAGE OF THE OFFICIAL ZONING ATLAS REFERRED TO AND ADOPTED BY REFERENCE BY ORDINANCE NO. 04-41 OF THE COUNTY OF COLLIER, FLORIDA, ADOPTED JUNE 22, 2004.

BY \_\_\_\_\_ CHAIRMAN  
 ATTEST \_\_\_\_\_ CLERK

**FLOOD INSURANCE RATE MAP INFORMATION**

COMMUNITY NO: 120067 PANEL NOS: 383G,385G,391G,392G  
 PROGRAM: REGULAR EFFECTIVE DATE: NOV. 17, 2005  
 FLOOD ZONE: ALL \_\_\_\_\_ OR AS SHOWN ON MAP.  
 WIND ZONE: ALL \_\_\_\_\_ 131 \_\_\_\_\_ OR AS SHOWN ON MAP.

COLLIER COUNTY, FLORIDA  
 COMMUNITY DEVELOPMENT DIVISION  
 TWP 49S RNG 25E SEC(S) 23 SO. 1/2  
 SCALE 0 400  
 MAP NUMBER: 9523S