

The Historic/Archaeological Probability Maps are the official County source designating historic or archaeological resources.

LAST REVISION: ZONING _____ OTHER _____

CITY OF NAPLES

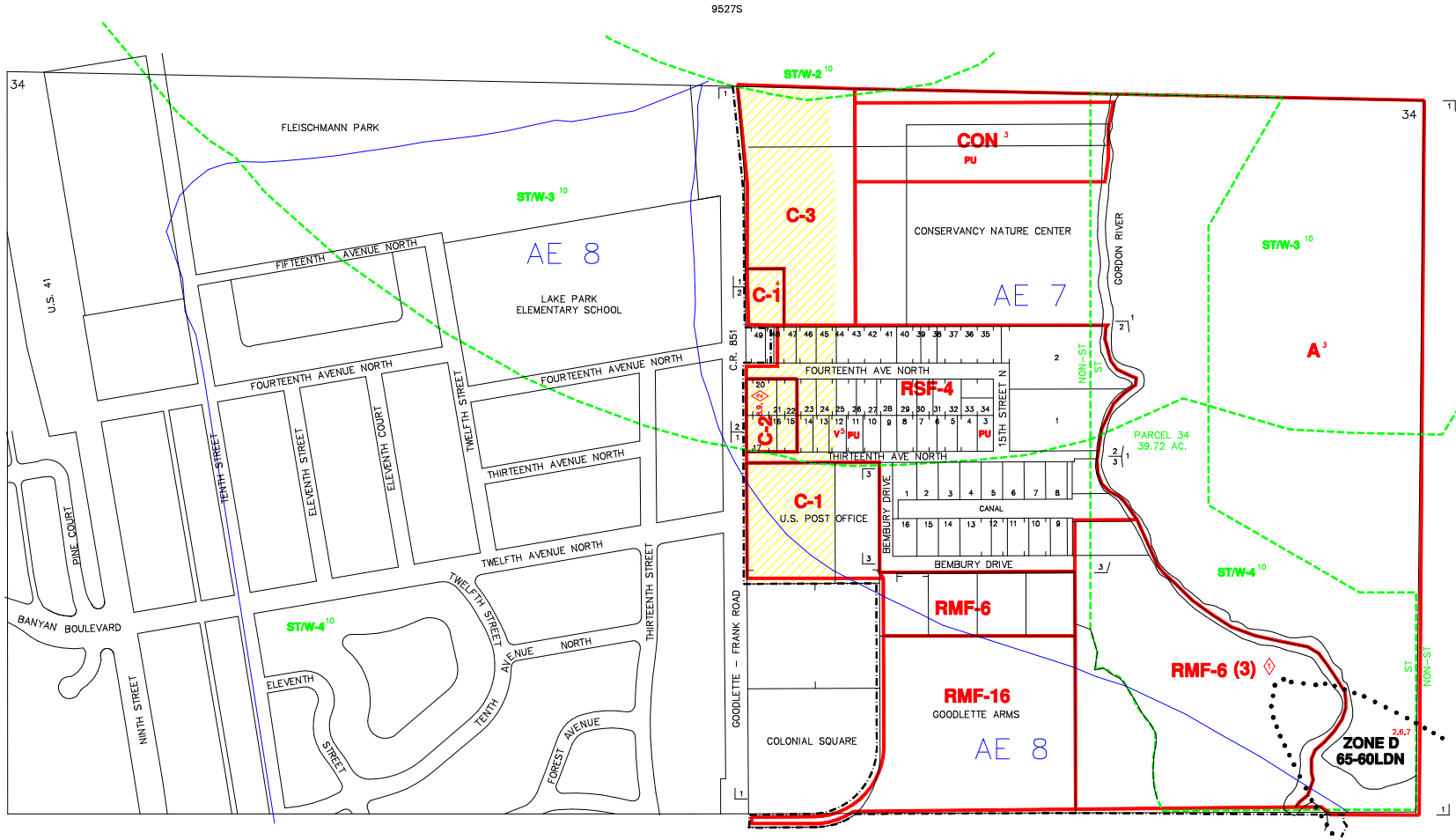

- INDICATES AIRPORT NOISE BOUNDARY
- INDICATES CITY LIMITS
- - - - - INDICATES SPECIAL TREATMENT OVERLAY
- ////// INDICATES CORRIDOR MANAGEMENT OVERLAY DISTRICT (330' OFFSET FROM R/W LINE)

SUBDIVISION INDEX							
NO.	NAME	P.B.	Pg.	NO.	NAME	P.B.	Pg.
1	NAPLES IMPROVEMENT CO LITTLE FARMS	5	84	11			
2	GORDON RIVER HOMES	5	106	12			
3	STORTER SUBDIVISION	5		13			
4				14			
5				15			
6				16			
7				17			
8				18			
9				19			
10				20			

ZONING NOTES

1 20-16-88 LDC 100 CORRIDOR MANAGE-
MENT OVERLAY DISTRICT
2 LDC-21 20-80-21 91-40
3 LDC-21 20-80-21 91-40
4 10-16-99 LDC-21 89-74
5 6-14-00 LDC-21 43-013
6 6-14-00 LDC-21 43-013
7 10-22-02 RZ-01-AR-1204 02-53
8 10-22-02 RZ-01-AR-1204 02-53
9 8-15-03 35-000-005 05-02
10 8-15-03 35-000-005 05-02

DEVELOPMENT STANDARDS MODIFICATIONS

◆ 8-22-02 R-02-4 92-43
◆ 10-22-02 RZ-01-AR-1204 02-53

THIS IS TO CERTIFY THAT THIS IS A PAGE OF THE OFFICIAL ZONING ATLAS REFERRED TO AND ADOPTED BY REFERENCE BY ORDINANCE NO. 04-41 OF THE COUNTY OF COLLIER, FLORIDA, ADOPTED JUNE 22, 2004.

BY _____ CHAIRMAN

ATTEST _____ CLERK

FLOOD INSURANCE RATE MAP INFORMATION	
COMMUNITY NUMBER: 120067	PANEL NUMBER: 391G
PROGRAM: REGULAR	EFFECTIVE DATE: NOV. 17, 2005
FLOOD ZONE: ALL _____ OR AS SHOWN ON MAP.	
WIND ZONE: ALL _____ 132 _____ OR AS SHOWN ON MAP.	
COLLIER COUNTY, FLORIDA	
COMMUNITY DEVELOPMENT DIVISION	
TWP 49S RING 25E	SEC(S) 34 NO 1/2
SCALE	MAP NUMBER:
0 400	9534N

95275

9534S

9535N