

LAST REVISION: ZONING _____ OTHER _____

The Historic/Archaeological Probability Maps are the official County source designating historic or archaeological resources.

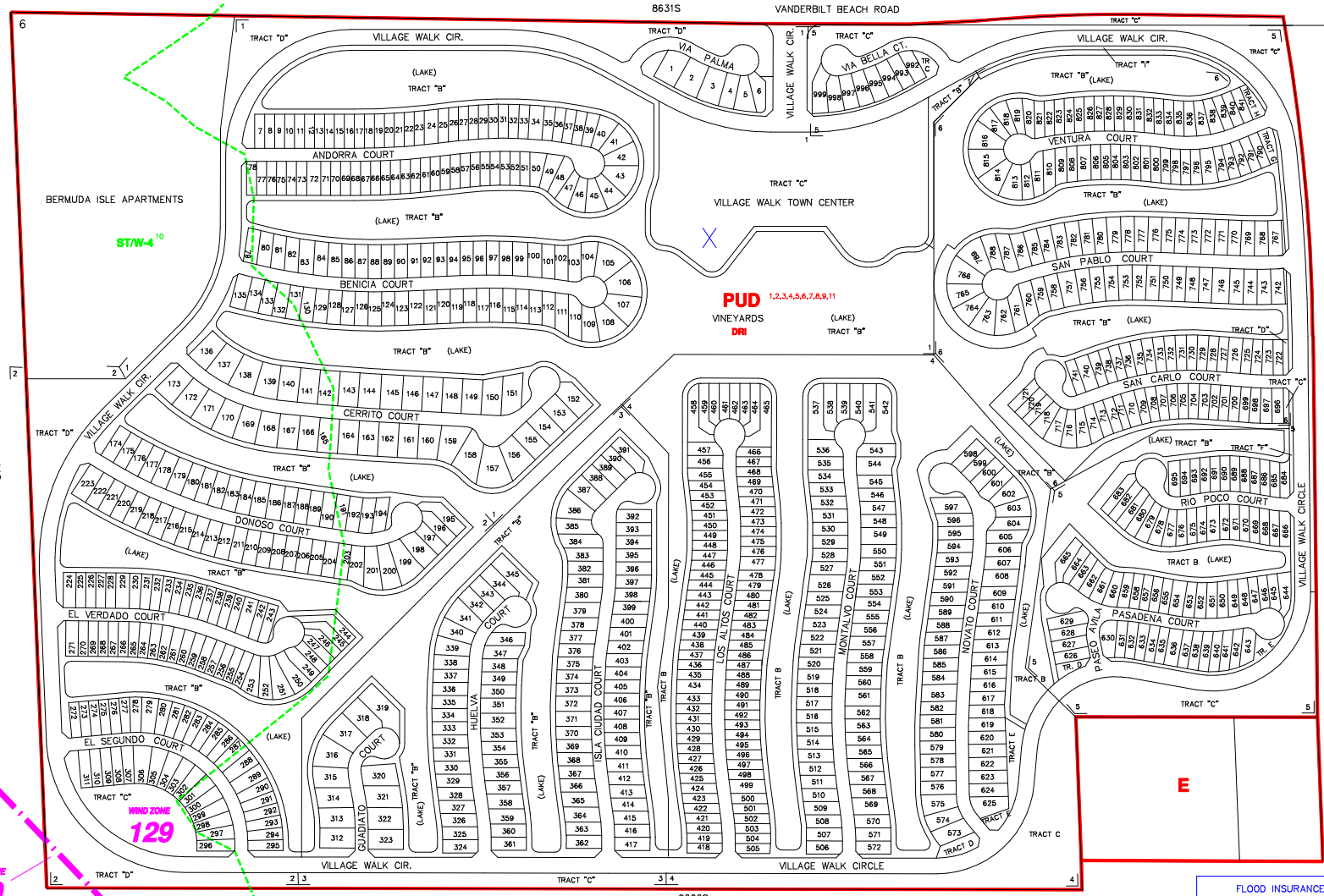

SUBDIVISION INDEX							
NO.	NAME	P.B.	Pg.	NO.	NAME	P.B.	Pg.
1	VILLAGE WALK, PHASE ONE	24	31-36	11			
2	VILLAGE WALK, PHASE TWO	25	8-11	12			
3	VILLAGE WALK, PHASE THREE	26	90-93	13			
4	VILLAGE WALK, PHASE FOUR	27	60-64	14			
5	VILLAGE WALK, PHASE FIVE	27	64-69	15			
6	VILLAGE WALK, PHASE SIX	29	28-31	16			
7				17			
8				18			
9				19			
10				20			

ZONING NOTES

1 5-7-86 R-85-18C
 2 10-13-90 R-85-18C
 3 10-13-90 R-85-18C
 4 1-1-91 PD-85-18C
 5 1-1-91 PD-85-18C
 6 1-1-91 PD-85-18C
 7 1-1-91 PD-85-18C
 8 1-1-91 PD-85-18C
 9 1-1-91 PD-85-18C
 10 9-19-05 LD-05-05-27
 11 2-28-06 LD-05-05-27

THIS IS TO CERTIFY THAT THIS IS A PAGE OF THE OFFICIAL ZONING MAPS REFERRED TO AND ADOPTED BY REFERENCE BY ORDINANCE NO. 04-41 OF THE COUNTY OF COLLIER, FLORIDA, ADOPTED JUNE 22, 2004.

BY _____ CHAIRMAN

ATTEST _____ CLERK

FLOOD INSURANCE RATE MAP INFORMATION

COMMUNITY NUMBER: 120067 PANEL NUMBER: 385G, 425G
 PROGRAM: REGULAR EFFECTIVE DATE: NOV. 17, 2005
 FLOOD ZONE: ALL X OR AS SHOWN ON MAP.
 WIND ZONE: ALL OR AS SHOWN ON MAP.

COLLIER COUNTY, FLORIDA

COMMUNITY DEVELOPMENT DIVISION

TWP 49S RING 26E SEC(5) 06 NO 1/2

SCALE MAP NUMBER:
0 400 9606N

9501N

LIVINSTON ROAD

8631S

VANDERBILT BEACH ROAD

INTERSTATE - 75

9606N

9606S