

The Historic/Archaeological Probability Maps are the official County source designating historic or archaeological resources.

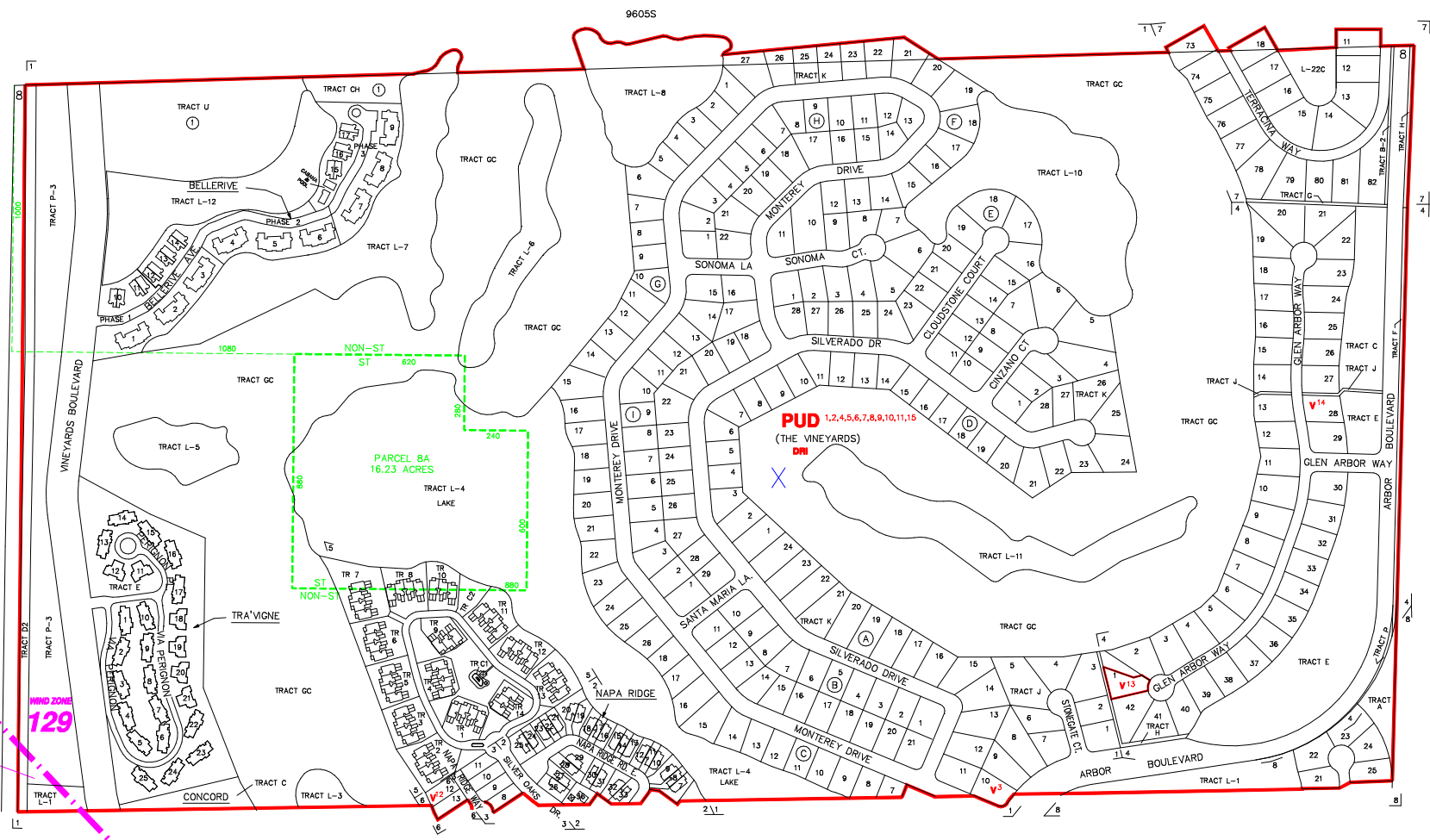

96055

96085

----- INDICATES SPECIAL TREATMENT OVERLAY
 - - - - - INDICATES WIND ZONE BOUNDARY LINE

| SUBDIVISION INDEX | | | | | | | |
|-------------------|----------------------------|------|-------|-----|------|------|-----|
| NO. | NAME | P.B. | Pg. | NO. | NAME | P.B. | Pg. |
| 1 | UNIT ONE AT THE VINEYARDS | 14 | 67-87 | 11 | | | |
| 2 | NAPA RIDGE UNIT ONE | 15 | 88-90 | 12 | | | |
| 3 | NAPA RIDGE UNIT TWO | 15 | 91-92 | 13 | | | |
| 4 | VINEYARDS ARBOR GLEN | 15 | 39-41 | 14 | | | |
| 5 | SILVER OAKS, A CONDO | 15 | 83-84 | 15 | | | |
| 6 | NAPA RIDGE UNIT TWO REPLAT | 15 | 35-36 | 16 | | | |
| 7 | TERRACINA AT THE VINEYARDS | 49 | 88-93 | 17 | | | |
| 8 | HAMMOCK ISLES | 49 | 40-46 | 18 | | | |
| 19 | | | | 19 | | | |
| 20 | | | | 20 | | | |

- ZONING NOTES**
- 1 R-85-15C
 - 2 P-16-85
 - 3 P-16-85
 - 4 P-16-85
 - 5 P-16-85
 - 6 P-16-85
 - 7 P-16-85
 - 8 P-16-85
 - 9 P-16-85
 - 10 P-16-85
 - 11 P-16-85
 - 12 P-16-85
 - 13 P-16-85
 - 14 P-16-85
 - 15 P-16-85

THIS IS TO CERTIFY THAT THIS IS A PAGE OF THE OFFICIAL ZONING ATLAS REFERRED TO AND ADOPTED BY REFERENCE BY ORDINANCE NO. 04-41 OF THE COUNTY OF COLLIER, FLORIDA, ADOPTED JUNE 22, 2004.

BY _____ CHAIRMAN

ATTEST _____ CLERK

FLOOD INSURANCE RATE MAP INFORMATION

COMMUNITY NUMBER: 120067 PANEL NUMBER: 425G
 PROGRAM: REGULAR EFFECTIVE DATE: NOV. 17, 2005
 FLOOD ZONE: ALL, X OR AS SHOWN ON MAP.
 WIND ZONE: ALL _____ OR AS SHOWN ON MAP.

COLLIER COUNTY, FLORIDA

COMMUNITY DEVELOPMENT DIVISION
 TWP 49S RING 26S SEC(S) 08 NO 1/2

SCALE 0 400
 MAP NUMBER: 9608N