

The Historic/Archaeological Probability Maps are the official County source designating historic or archaeological resources.

LAST REVISION: ZONING _____ OTHER _____

9619N

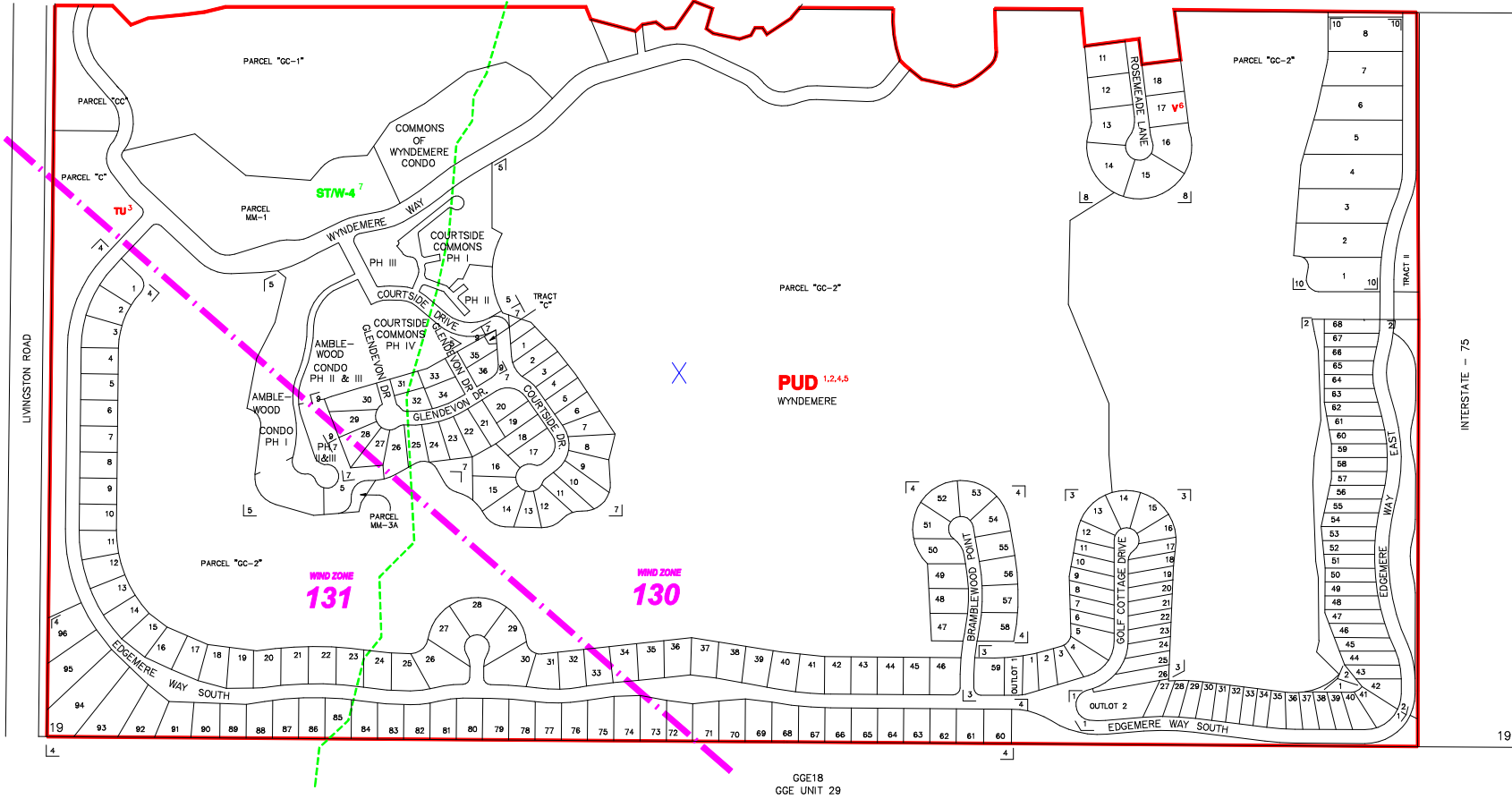

-----INDICATES SPECIAL TREATMENT OVERLAY
 - - - - -INDICATES WIND ZONE BOUNDARY LINE

SUBDIVISION INDEX							
NO.	NAME	P.B.	Pg.	NO.	NAME	P.B.	Pg.
1	GOLF COTTAGES AT WYNDEMERE PHASE 2	14	53 & 54	11			
2	GOLF COTTAGES AT WYNDEMERE PHASE 3	15	93-94	12			
3	GOLF COTTAGES AT WYNDEMERE	15	119-121	13			
4	WYNDEMERE SECTION 1	13	8-12	14			
5	REPLAT OF PART OF WYNDEMERE TRACT MAP	13	39-43	15			
6	REPLAT OF REPLAT OF PART OF WIND TRACT MAP	14	107-112	16			
7	GLENDEVON AT WYNDEMERE	16	18-19	17			
8	ROSEMADE AT WYNDEMERE	15	100-101	18			
9	GLENDEVON REPLAT AT WYNDEMERE	18	73	19			
10	THE ESTATES AT WYNDEMERE	22	90-91	20			

ZONING NOTES
 1 8-11-81 R-81-C
 2 1-16-85 TU-95-T 95-92
 3 4-1-88 PUD-88-1(1) 88-88
 4 4-1-88 PUD-88-1(2) 88-88
 5 1-24-88 V-88-18 88-70
 6 1-13-88 GCE 08-05-77
 7 1-13-88 GCE 08-05-77

THIS IS TO CERTIFY THAT THIS IS A PAGE OF THE OFFICIAL ZONING ATLAS REFERRED TO AND ADOPTED BY REFERENCE BY ORDINANCE NO. 04-41 OF THE COUNTY OF COLLIER, FLORIDA, ADOPTED JUNE 22, 2004.

BY _____ CHAIRMAN
 ATTEST _____ CLERK

FLOOD INSURANCE RATE MAP INFORMATION
 COMMUNITY NUMBER: 120067 PANEL NUMBER 3856,3926
 4156,4256
 PROGRAM: REGULAR EFFECTIVE DATE: NOV. 17, 2005
 FLOOD ZONE: ALL X OR AS SHOWN ON MAP.
 WIND ZONE: ALL _____ OR AS SHOWN ON MAP.

COLLIER COUNTY, FLORIDA
 COMMUNITY DEVELOPMENT DIVISION
 TWP 49S RNG 26E SEC(S) 19 SO 1/2
 SCALE 0 400
 MAP NUMBER: 9619S