

The Historic/Archaeological Probability Maps are the official County source designating historic or archaeological resources.

LAST REVISION: ZONING _____ OTHER _____

9625S

9635N

973132

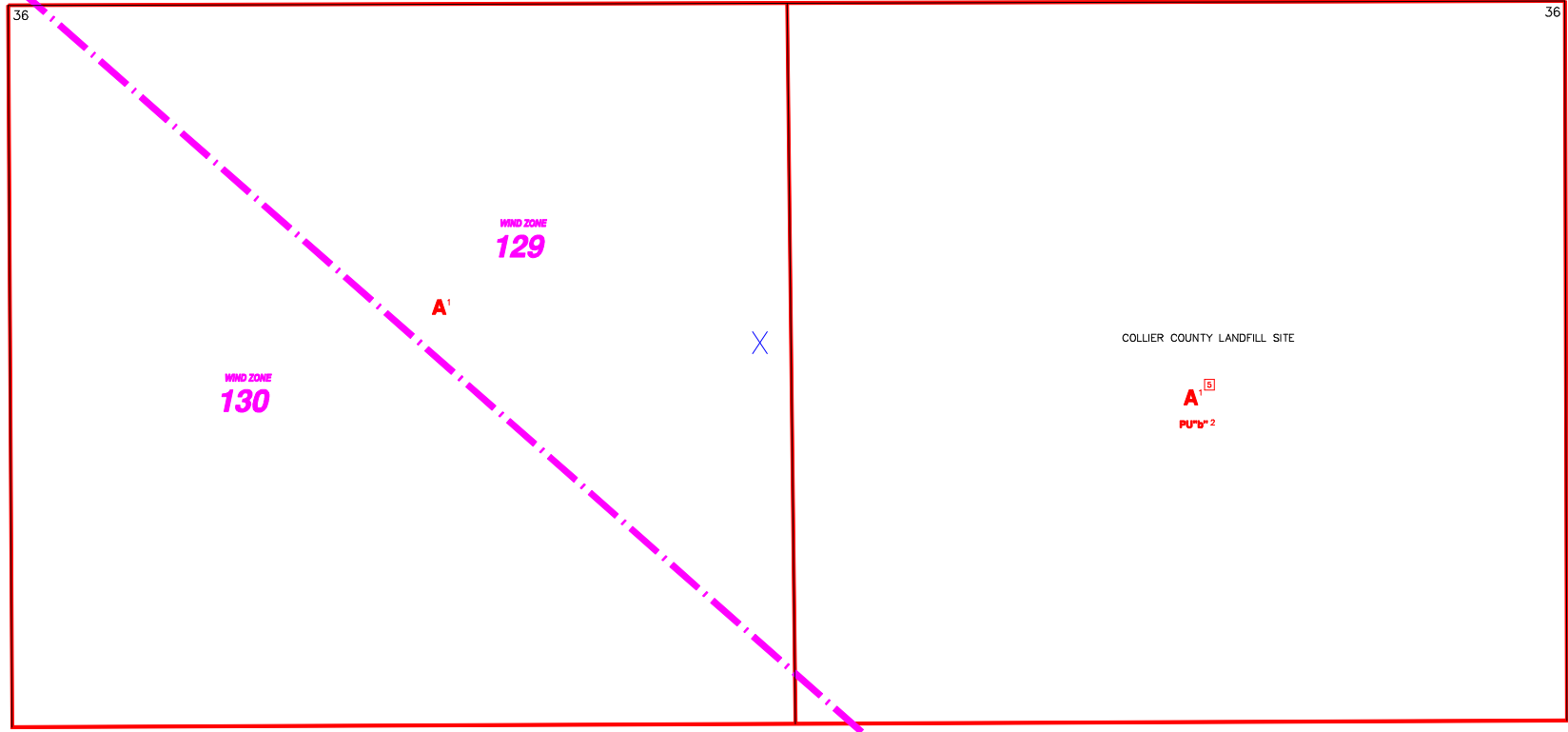

----- INDICATES WIND ZONE BOUNDARY LINE

9636S

SUBDIVISION INDEX			
NO.	NAME	P.B.	Pg.
11			
12			
13			
14			
15			
16			
17			
18			
19			
20			

ZONING NOTES
1. LDC-91-00 PU-00-17 90-514
2. LDC-91-00 PU-00-17 90-514

ZONING OVERLAY NOTES
OVERLAYS CREATED BY
LDC ORD. No. 04-08 1-7-04
[5] REWIND-SENDING LANDS-1810

THIS IS TO CERTIFY THAT THIS IS A PAGE OF THE OFFICIAL ZONING ATLAS REFERRED TO AND ADOPTED BY REFERENCE BY ORDINANCE NO. 04-41 OF THE COUNTY OF COLLIER, FLORIDA, ADOPTED JUNE 22, 2004.

BY _____ CHAIRMAN

ATTEST _____ CLERK

FLOOD INSURANCE RATE MAP INFORMATION	
COMMUNITY NUMBER: 120067	PANEL NUMBER: 4256
PROGRAM: REGULAR	EFFECTIVE DATE: NOV. 17, 2005
FLOOD ZONE: ALL, X, OR AS SHOWN ON MAP.	
WIND ZONE: ALL, OR AS SHOWN ON MAP.	
COLLIER COUNTY, FLORIDA	
COMMUNITY DEVELOPMENT DIVISION	
TWP 49S RNG 26E SEC(S) 36 NO 1/2	
SCALE 0 400	MAP NUMBER: 9636N