

R 29 E

482930

R 30 E

T 49 S

492728

502930

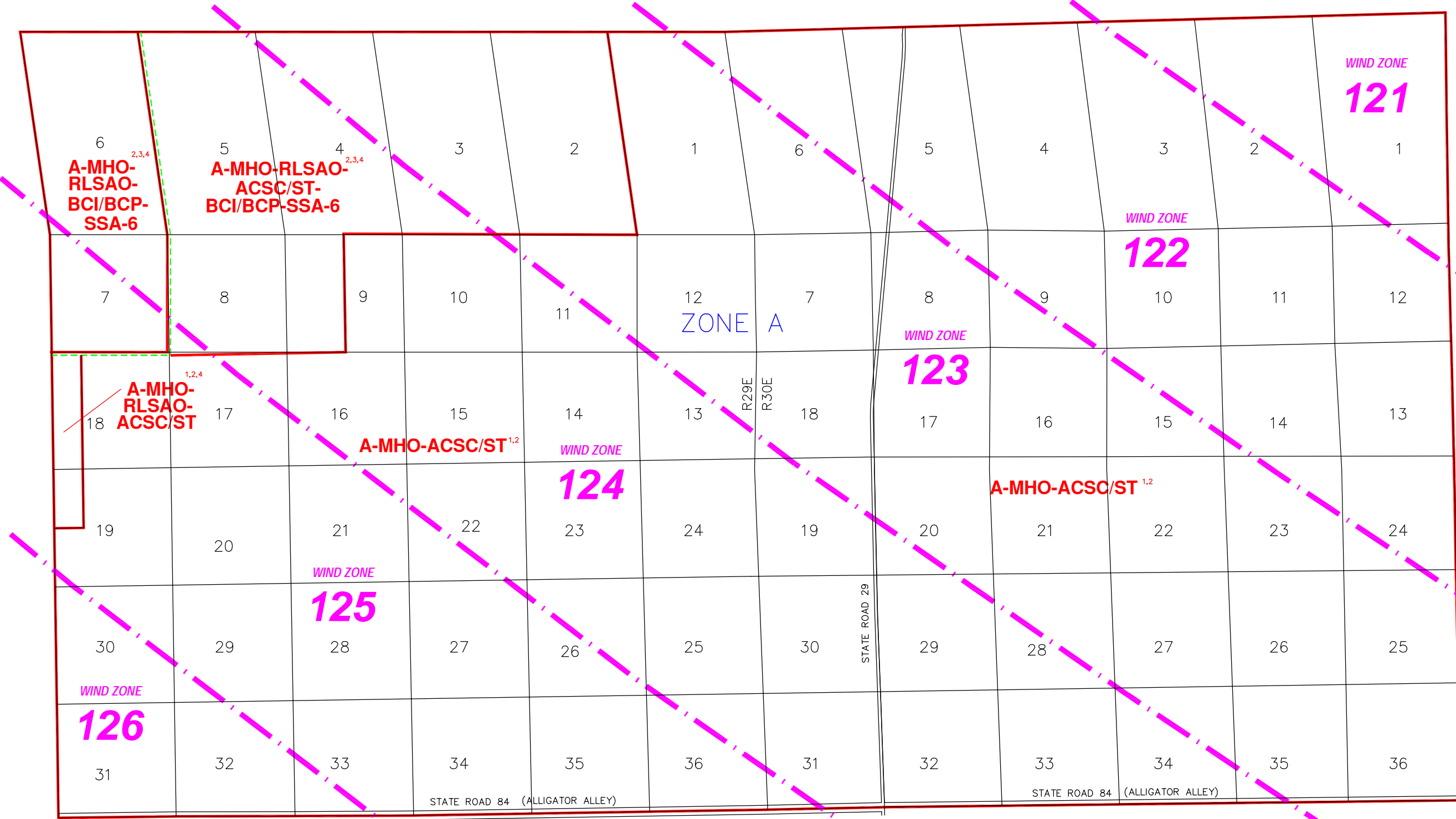

--- INDICATES SPECIAL TREATMENT OVERLAY
 - - - - - INDICATES WIND ZONE BOUNDARY LINE

SUBDIVISION INDEX

NO.	NAME	P.B.	Pg.	NO.	NAME	P.B.	Pg.
1				11			
2				12			
3				13			
4				14			
5				15			
6				16			
7				17			
8				18			
9				19			
10				20			

ZONING NOTES
 1 82-32
 2 LDC-91
 3 6-14-05 SSA-05-AR-7382 05-229
 4 6-16-03 LDC 03-27
 5
 6
 7
 8
 9

THIS IS TO CERTIFY THAT THIS IS A PAGE OF THE OFFICIAL ZONING ATLAS REFERRED TO AND ADOPTED BY REFERENCE BY ORDINANCE NO. 04-41 OF THE COUNTY OF COLLIER, FLORIDA, ADOPTED JUNE 22, 2004.

BY _____ CHAIRMAN

ATTEST _____ CLERK

FLOOD INSURANCE RATE MAP INFORMATION	
COMMUNITY NUMBER: 120067	PANEL NUMBER: 475G,500G
PROGRAM: REGULAR	EFFECTIVE DATE: NOV. 17, 2005
FLOOD ZONE: ALL <u>A</u> OR AS SHOWN ON MAP.	
WIND ZONE: ALL _____ OR AS SHOWN ON MAP.	

COLLIER COUNTY, FLORIDA
 COMMUNITY DEVELOPMENT DIVISION
 TWP 49S RNG 29E & 30E
 SCALE 0 4800
 MAP NUMBER: 492930