

0524N

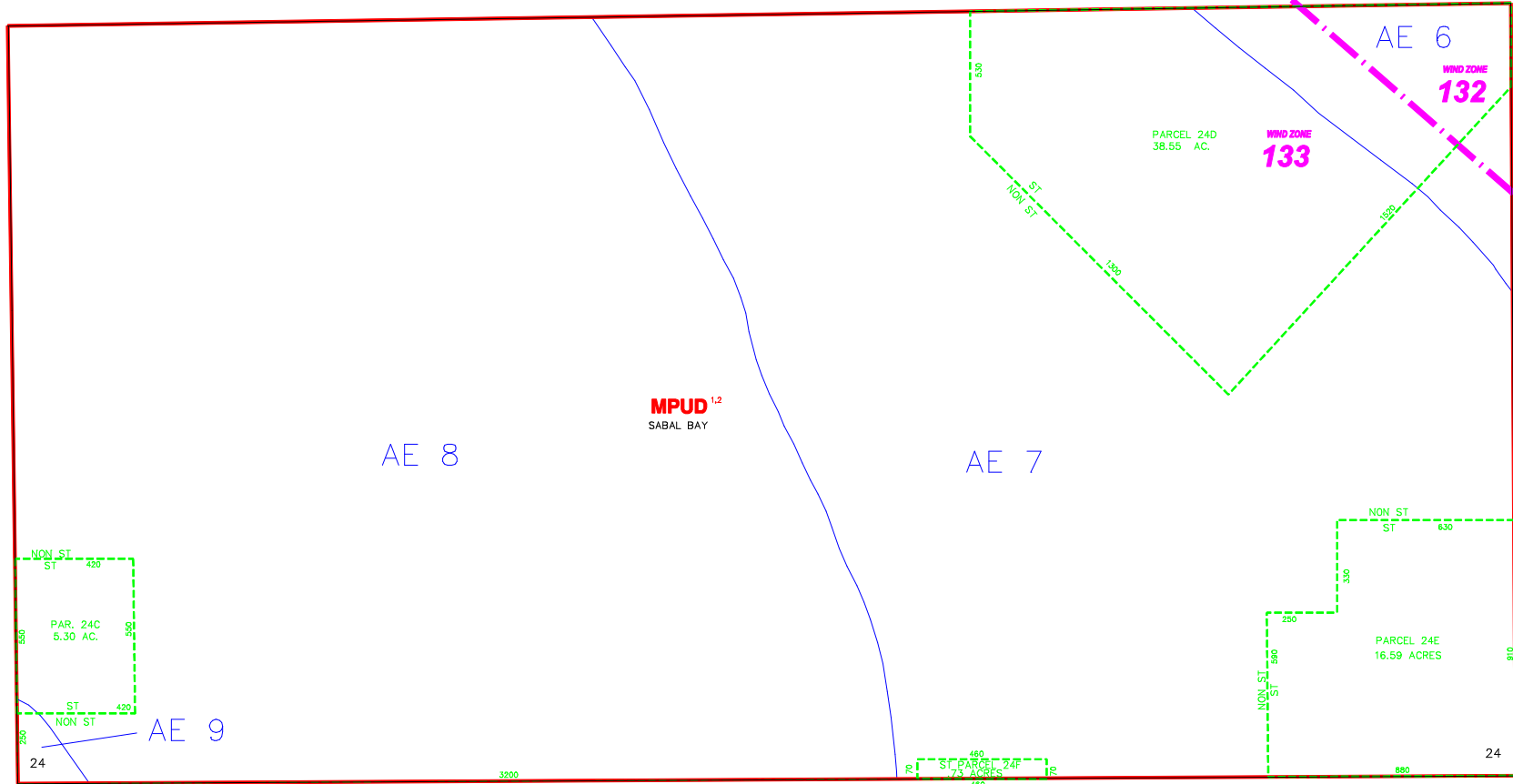

0525N

----- INDICATES SPECIAL TREATMENT OVERLAY  
 - - - - - INDICATES WIND ZONE BOUNDARY LINE

SUBDIVISION INDEX			
NO.	NAME	P.B.	Pg.
11			
12			
13			
14			
15			
16			
17			
18			
19			
20			

**ZONING NOTES**  
 1 1-15-05 DRIVEWAY-DRIVE-AS-8201 04-306  
 2 1-15-05 MPUD-DRIVE-AS-8201 05-58  
 3 1-15-05 MPUD-DRIVE-AS-8201 05-58  
 4 1-15-05 MPUD-DRIVE-AS-8201 05-58

THIS IS TO CERTIFY THAT THIS IS A PAGE OF THE OFFICIAL ZONING ATLAS REFERRED TO AND ADOPTED BY REFERENCE BY ORDINANCE NO. 04-41 OF THE COUNTY OF COLLIER, FLORIDA, ADOPTED JUNE 22, 2004.

BY \_\_\_\_\_ CHAIRMAN

ATTEST \_\_\_\_\_ CLERK

FLOOD INSURANCE RATE MAP INFORMATION	
COMMUNITY NUMBER: 120067	PANEL NUMBER 582G
PROGRAM: REGULAR	EFFECTIVE DATE: NOV. 17, 2005
FLOOD ZONE: ALL _____ OR AS SHOWN ON MAP.	
WIND ZONE: ALL _____ OR AS SHOWN ON MAP.	
COLLIER COUNTY, FLORIDA	
COMMUNITY DEVELOPMENT DIVISION	
TWP 50S RNG 25E SEC(S) 24 SO 1/2	
SCALE	MAP NUMBER:
0 400	0524S

0523S

0619S