

0523S

CITY OF MAPLES

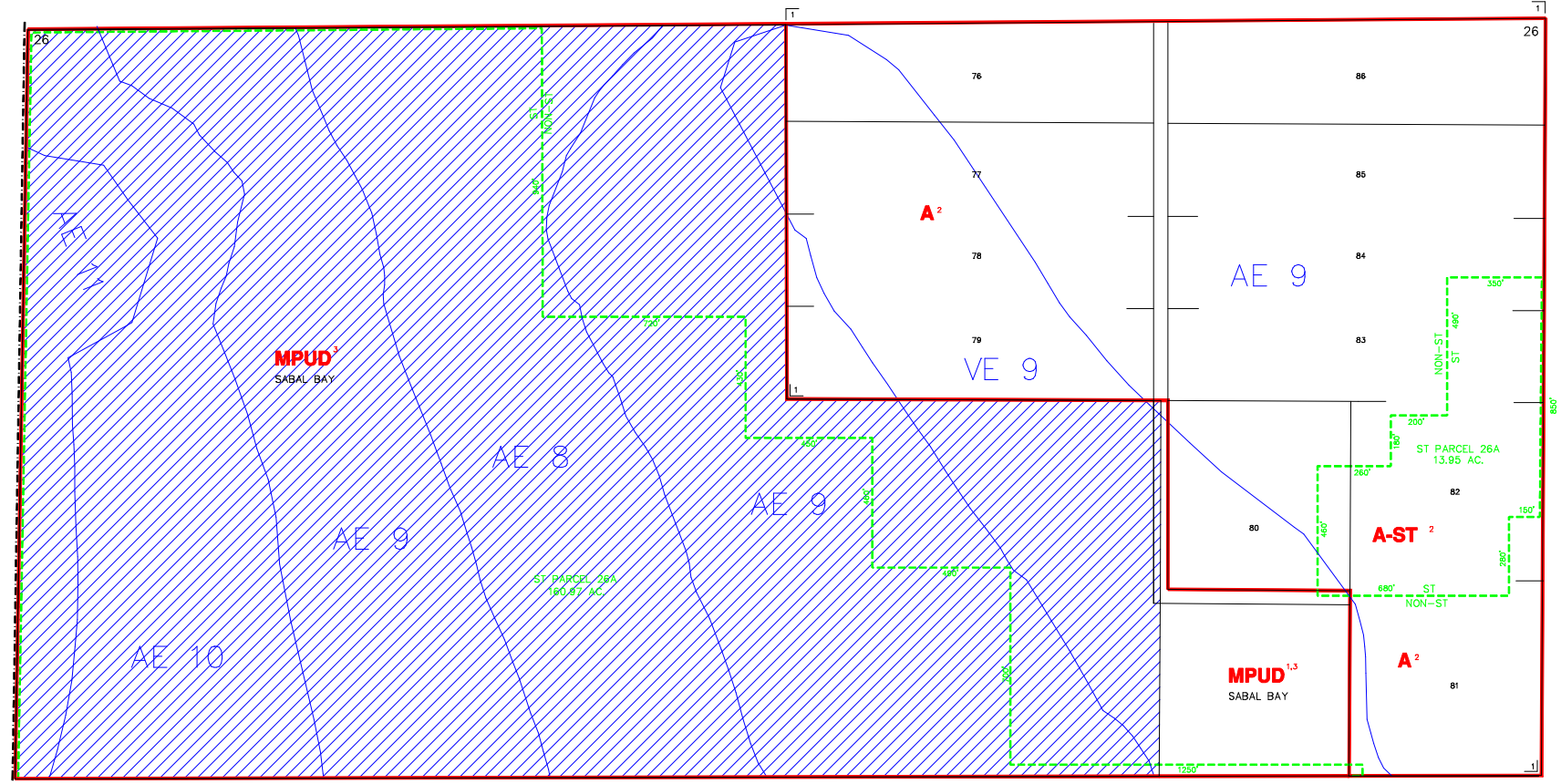

0525N

FLOOD INSURANCE NOT AVAILABLE FOR MANY STRUCTURES NEWLY BUILT OR SUBSTANTIALLY IMPROVED. SEE FLOOD INSURANCE RATE MAP FOR CONTROLLING DATES.

INDICATES SPECIAL TREATMENT OVERLAY
 INDICATES CITY LIMITS

0526S

SUBDIVISION INDEX							
NO.	NAME	P.B.	Pg.	NO.	NAME	P.B.	Pg.
1	NAPLES GROVE & TRUCK CO. LITTLE FARMS NO. 2	1	27A	11			
				12			
				13			
				14			
				15			
				16			
				17			
				18			
				19			
				20			

ZONING NOTES
 1 11-15-05 PR18B-04-AR-6251 05-396
 2 11-15-05 PR18B-04-AR-6251 05-396
 3 11-15-05 PR18B-04-AR-6251 05-396
 4 0 0 0 0 0 0 0 0 0 0

THIS IS TO CERTIFY THAT THIS IS A PAGE OF THE OFFICIAL ZONING ATLAS REFERRED TO AND ADOPTED BY ORDINANCE NO. 04-41 OF THE COUNTY OF COLLIER, FLORIDA, ADOPTED JUNE 22, 2004.

BY _____ CHAIRMAN
 ATTEST _____ CLERK

FLOOD INSURANCE RATE MAP INFORMATION	
COMMUNITY NUMBER: 120067	PANEL NUMBER: 584G
PROGRAM: REGULAR	EFFECTIVE DATE: NOV. 17, 2005
FLOOD ZONE: ALL _____ OR AS SHOWN ON MAP.	
WIND ZONE: ALL 133 _____ OR AS SHOWN ON MAP.	
COLLIER COUNTY, FLORIDA	
COMMUNITY DEVELOPMENT DIVISION	
TWP 50S RNG 25E SEC(S) 26 NO 1/2	
SCALE 0 400	MAP NUMBER: 0526N