

LAST REVISION: ZONING _____ OTHER _____

The Historic/Archaeological Probability Maps are the official County source designating historic or archaeological resources.

0534S

0535N

0536S

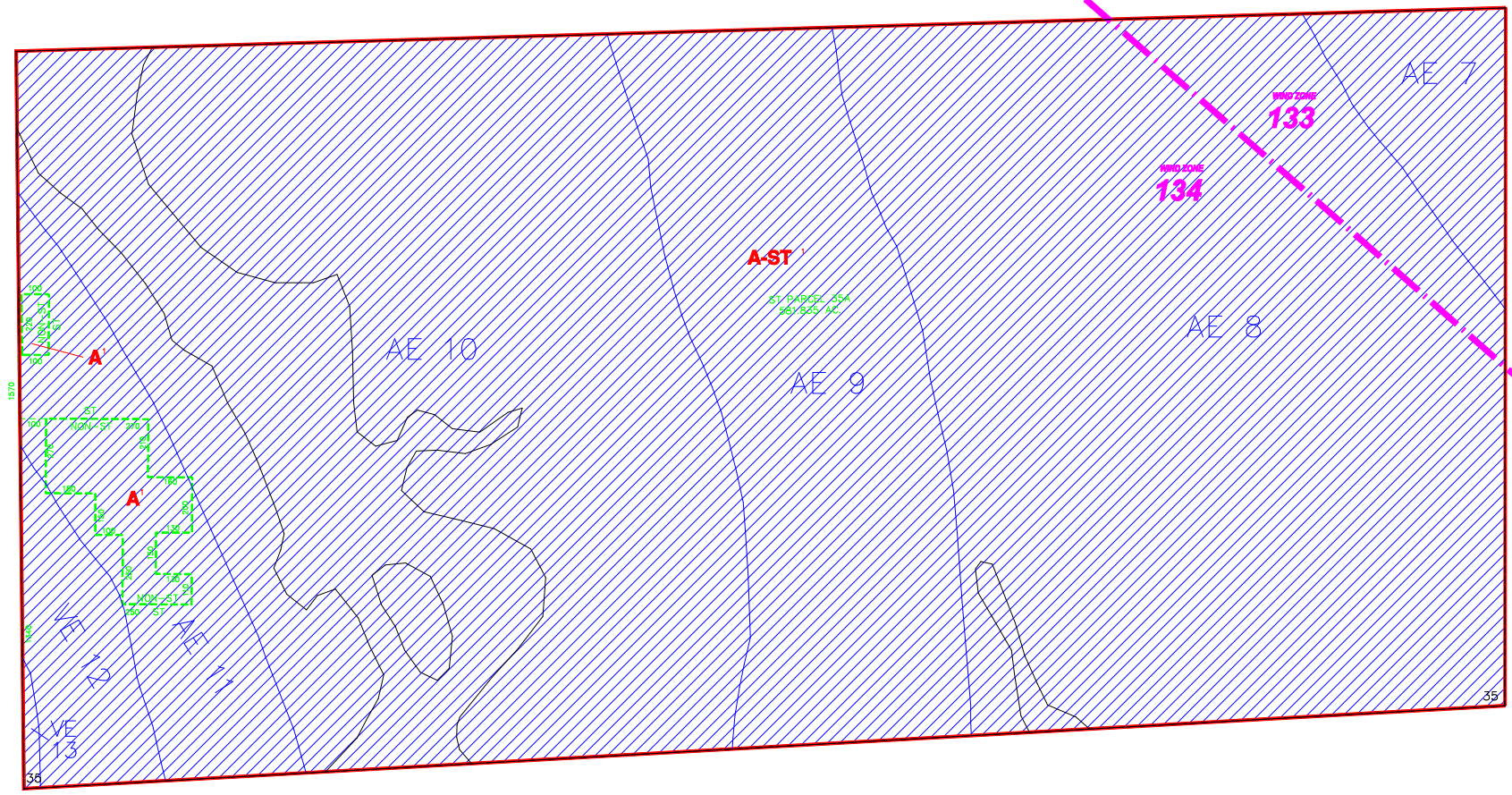

FLOOD INSURANCE NOT AVAILABLE FOR MANY STRUCTURES NEWLY BUILT OR SUBSTANTIALLY IMPROVED. SEE FLOOD INSURANCE RATE MAP FOR CONTROLLING DATES.

INDICATES SPECIAL TREATMENT OVERLAY
 INDICATES WIND ZONE BOUNDARY LINE

1502N

SUBDIVISION INDEX			
NO.	NAME	P.B.	Pg.
11			
12			
13			
14			
15			
16			
17			
18			
19			
20			

ZONING NOTES
 1. LDC-91
 11/17/2008

THIS IS TO CERTIFY THAT THIS IS A PAGE OF THE OFFICIAL ZONING ATLAS REFERRED TO AND ADOPTED BY REFERENCE BY ORDINANCE NO. 04-41 OF THE COUNTY OF COLLIER, FLORIDA, ADOPTED JUNE 22, 2004.

BY _____ CHAIRMAN
 ATTEST _____ CLERK

FLOOD INSURANCE RATE MAP INFORMATION	
COMMUNITY NUMBER: 120067	PANEL NUMBER: 584C
PROGRAM: REGULAR	EFFECTIVE DATE: NOV. 17, 2005
FLOOD ZONE: ALL _____ OR AS SHOWN ON MAP.	
WIND ZONE: ALL _____ OR AS SHOWN ON MAP.	
COLLIER COUNTY, FLORIDA	
COMMUNITY DEVELOPMENT DIVISION	
TWP 50S RING 25E SEC(S) 35 SO 1/2	
SCALE 	MAP NUMBER: 0535S