

RADIO ROAD (G.R. 056)

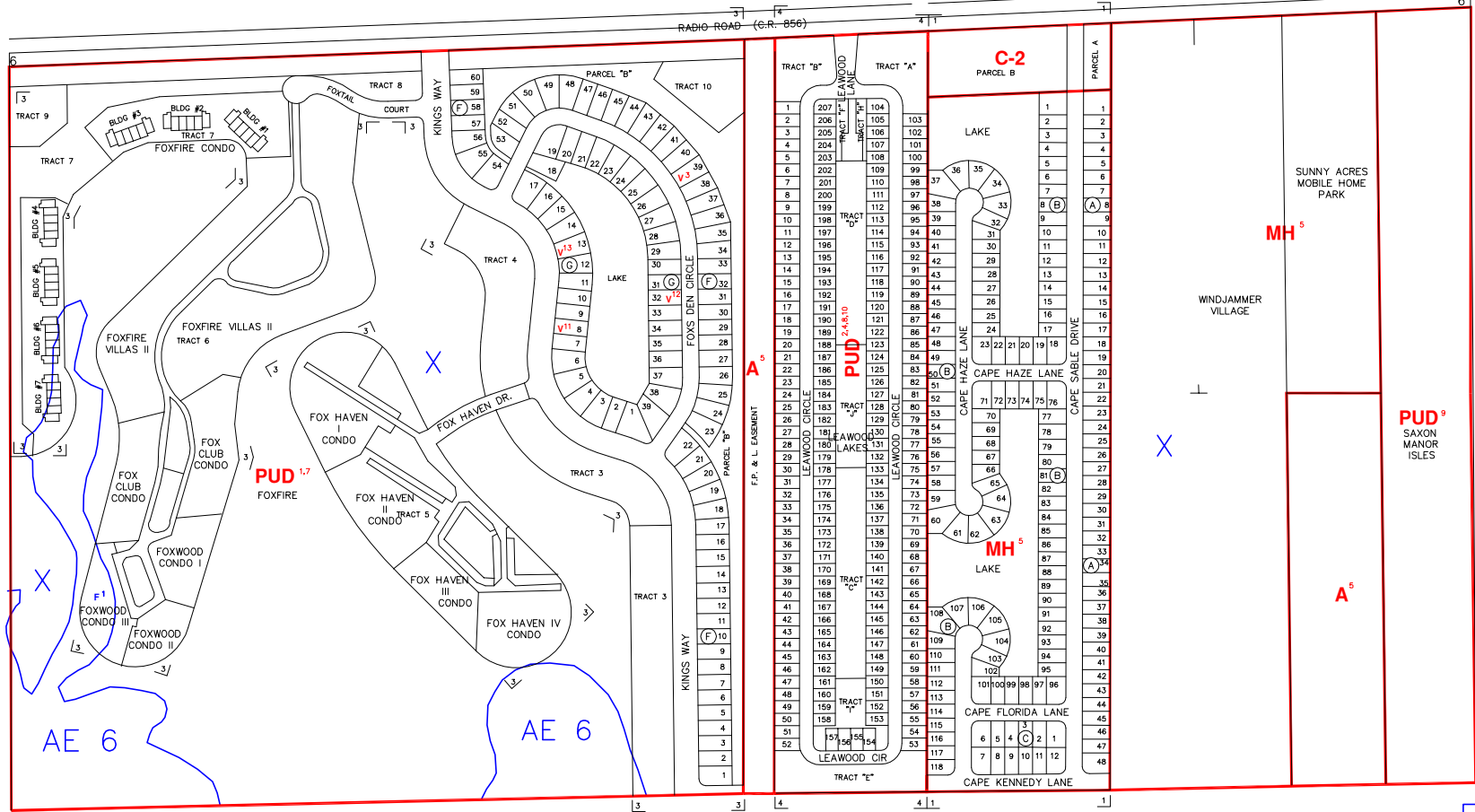

0601N

0603N

FLOOD ZONE MAP REVISION
1 ZONE X (LOMA) 5-20-08

FLOOD INSURANCE RATE MAP INFORMATION
 COMMUNITY NUMBER: 120067 PANEL NUMBER: 394G,415G
 PROGRAM: REGULAR EFFECTIVE DATE: NOV. 17, 2005
 FLOOD ZONE: ALL OR AS SHOWN ON MAP.
 WIND ZONE: ALL 131 OR AS SHOWN ON MAP.

THIS IS TO CERTIFY THAT THIS IS A PAGE OF THE OFFICIAL ZONING ATLAS REFERRED TO AND ADOPTED BY REFERENCE BY OFFICIAL NO. 04-41 OF THE COUNTY OF COLLIER, FLORIDA, ADOPTED JUNE 22, 2004.

BY _____ CHAIRMAN

ATTEST _____ CLERK

COLLIER COUNTY, FLORIDA

COMMUNITY DEVELOPMENT DIVISION

TWP 50S RNG 26E SEC(S) 6 NO 1/2

SCALE MAP NUMBER: 0606N

0 400

SUBDIVISION INDEX

| NO. | NAME | P.B. | Pg. | NO. | NAME | P.B. | Pg. |
|-----|-----------------------|------|---------|-----|------|------|-----|
| 1 | NAPLES MOBILE ESTATES | 10 | 91 | 11 | | | |
| 2 | FOXFIRE UNIT 2 | 13 | 97-100 | 12 | | | |
| 3 | FOXFIRE UNIT 3 | 13 | 101-103 | 13 | | | |
| 4 | LEAWOOD LAKES | 24 | 62-65 | 14 | | | |
| 5 | | | | 15 | | | |
| 6 | | | | 16 | | | |
| 7 | | | | 17 | | | |
| 8 | | | | 18 | | | |
| 9 | | | | 19 | | | |
| 10 | | | | 20 | | | |

ZONING NOTES
 1 6-4-86 ADA-85-50 86-70
 2 2-27-88 AD-86-10
 3 1-22-91 R-80-12 91-9
 4 1-22-91 R-80-12 91-9
 5 1-22-91 R-80-12 91-9
 6 1-22-91 R-80-12 91-9
 7 1-22-91 R-80-12 91-9
 8 1-22-91 R-80-12 91-9
 9 1-22-91 R-80-12 91-9
 10 1-22-91 R-80-12 91-9
 11 1-22-91 R-80-12 91-9
 12 1-22-91 R-80-12 91-9
 13 1-22-91 R-80-12 91-9
 14 1-22-91 R-80-12 91-9
 15 1-22-91 R-80-12 91-9