

0611N

0601S

502728

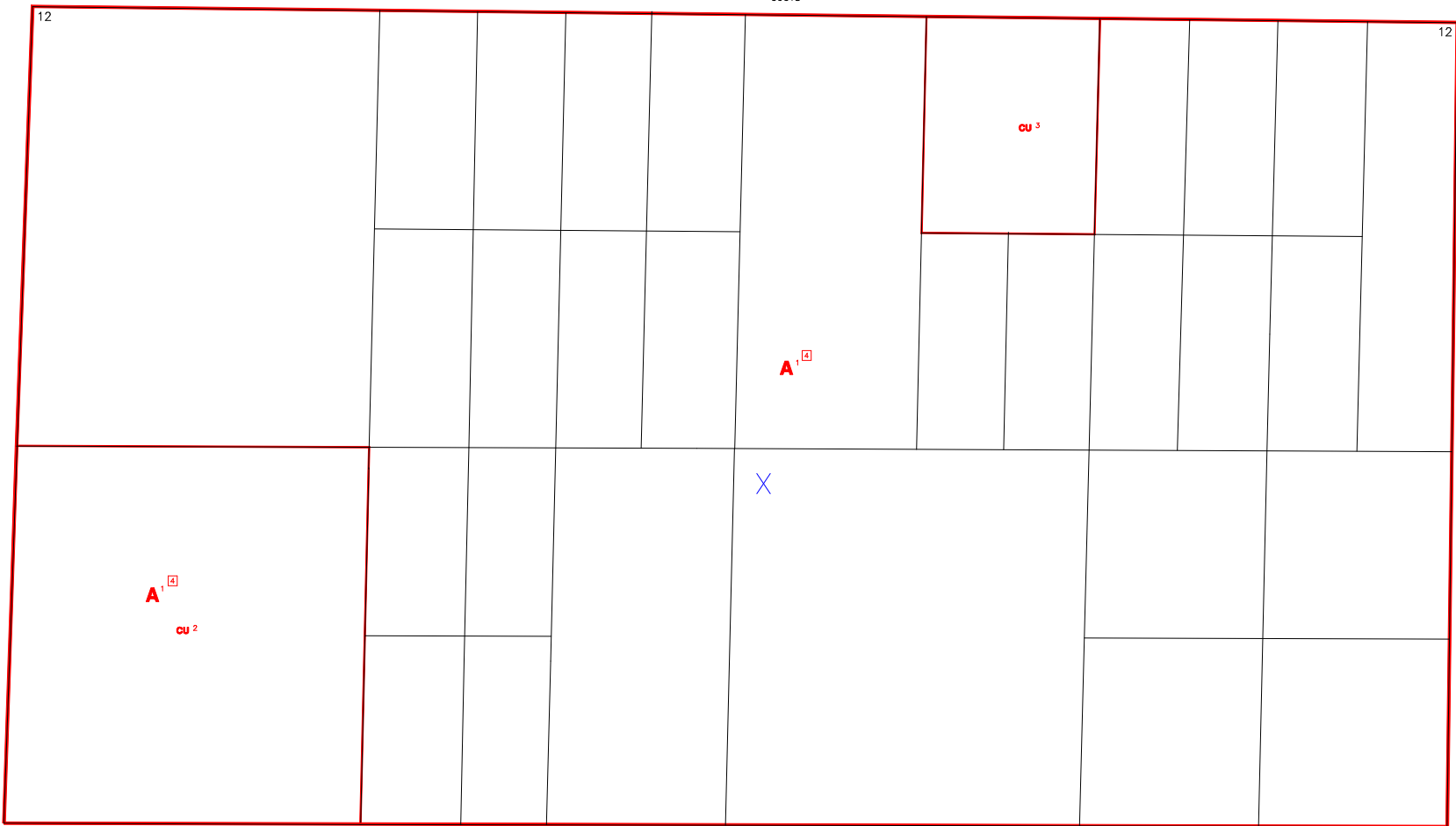

0612S

| SUBDIVISION INDEX | | | |
|-------------------|------|------|-----|
| NO. | NAME | P.B. | Pg. |
| 11 | | | |
| 12 | | | |
| 13 | | | |
| 14 | | | |
| 15 | | | |
| 16 | | | |
| 17 | | | |
| 18 | | | |
| 19 | | | |
| 20 | | | |

ZONING NOTES

1. LDC-93 CU-07-16 07-303
 2. LDC-97 CU-00-18 07-708
 3. LDC-01 CU-00-18 07-708
 4. LDC-00-18 07-708

ZONING OVERLAY NOTES:
 OVERLAYS CREATED BY
 LDC ORD. No. 04-08 1-7-04
 5. REMNUS-SENDING LANDS-NRPA

THIS IS TO CERTIFY THAT THIS IS A PAGE OF THE OFFICIAL ZONING ATLAS REFERRED TO AND ADOPTED BY REFERENCE BY ORDINANCE NO. 04-41 OF THE COUNTY OF COLLIER, FLORIDA, ADOPTED JUNE 22, 2004.

BY _____ CHAIRMAN

ATTEST _____ CLERK

| FLOOD INSURANCE RATE MAP INFORMATION | |
|--|-------------------------------|
| COMMUNITY NUMBER: 120067 | PANEL NUMBER: 425G |
| PROGRAM: REGULAR | EFFECTIVE DATE: NOV. 17, 2005 |
| FLOOD ZONE: ALL X OR AS SHOWN ON MAP. | |
| WIND ZONE: ALL 130 OR AS SHOWN ON MAP. | |

COLLIER COUNTY, FLORIDA

COMMUNITY DEVELOPMENT DIVISION

TWP 50S RNG 26E SEC(S) 12 NO 1/2

SCALE 0 400

MAP NUMBER: 0612N