

LAST REVISION: ZONING-----OTHER-----

The Historic/Archaeological Probability Maps are the official County source designating historic or archaeological resources.

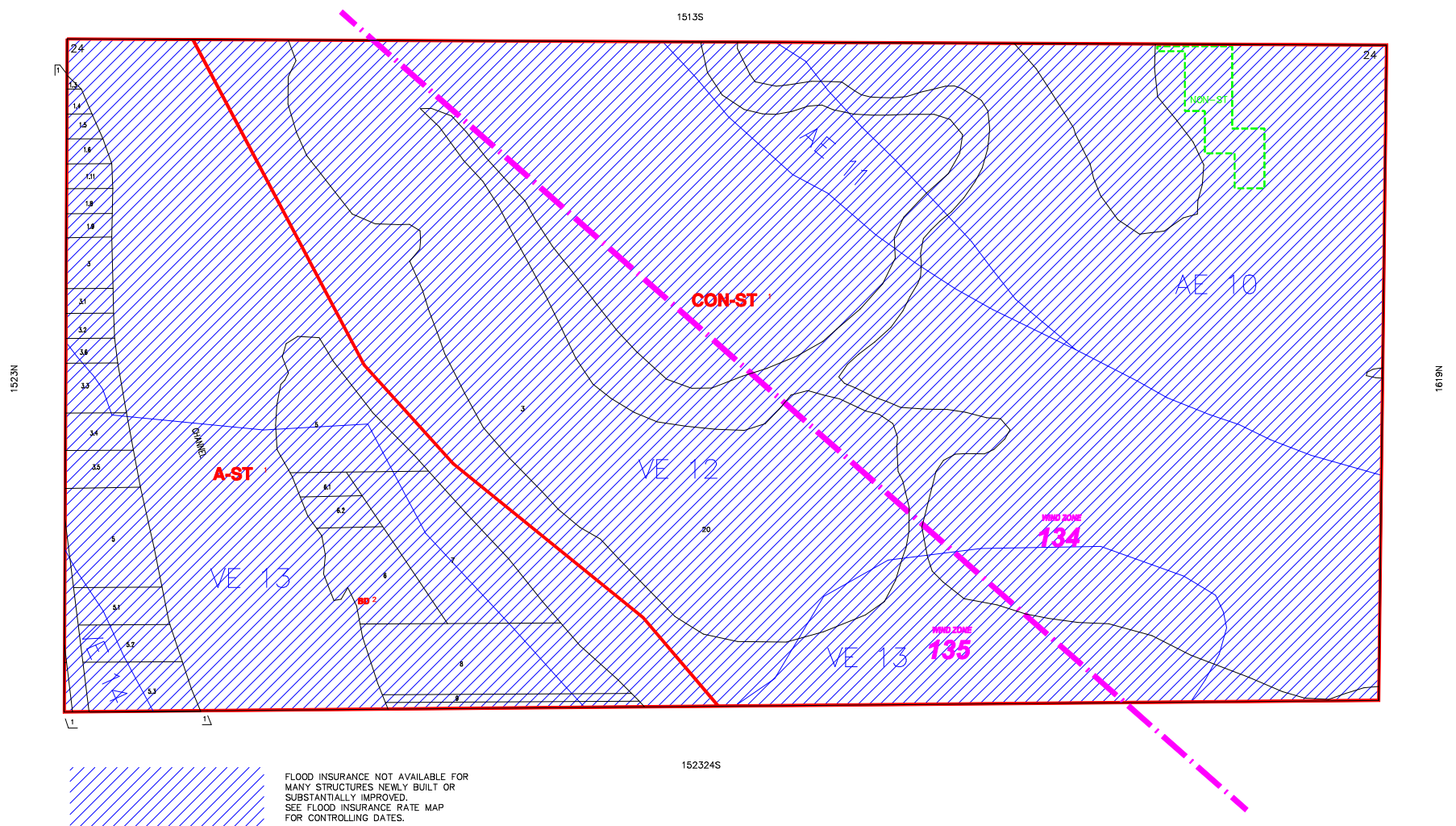

FLOOD INSURANCE NOT AVAILABLE FOR MANY STRUCTURES NEWLY BUILT OR SUBSTANTIALLY IMPROVED. SEE FLOOD INSURANCE RATE MAP FOR CONTROLLING DATES.

INDICATES SPECIAL TREATMENT OVERLAY
 INDICATES WIND ZONE BOUNDARY LINE

SUBDIVISION INDEX			
NO.	NAME	P.B.	Pg.
1	SOUTH NAPLES SHORES	3	11

NO.	NAME	P.B.	Pg.
11			
12			
13			
14			
15			
16			
17			
18			
19			
20			

ZONING NOTES
 1 DC-91
 2 1-2-96 80-96-8 88-9
 3 1-1-99 97-8 10

THIS IS TO CERTIFY THAT THIS IS A PAGE OF THE OFFICIAL ZONING ATLAS REFERRED TO AND ADOPTED BY ORDINANCE NO. 04-41 OF THE COUNTY OF COLLIER, FLORIDA, ADOPTED JUNE 22, 2004.

BY _____ CHAIRMAN
 ATTEST _____ CLERK

FLOOD INSURANCE RATE MAP INFORMATION	
COMMUNITY NUMBER: 120067	PANEL NUMBER 595G
PROGRAM: REGULAR	EFFECTIVE DATE: NOV. 17, 2005
FLOOD ZONE: ALL _____ OR AS SHOWN ON MAP.	
WIND ZONE: ALL _____ OR AS SHOWN ON MAP.	

COLLIER COUNTY, FLORIDA	
COMMUNITY DEVELOPMENT DIVISION	
TWP. 51S RING. 25E SEC(S) 24 NO 1/2	MAP NUMBER: 1524N

SCALE 0 400