

The Historic/Archaeological Probability Maps are the official County source designating historic or archeologic resources.

LAST REVISION: ZONING \_\_\_\_\_ OTHER \_\_\_\_\_

0636S

1602N

512728

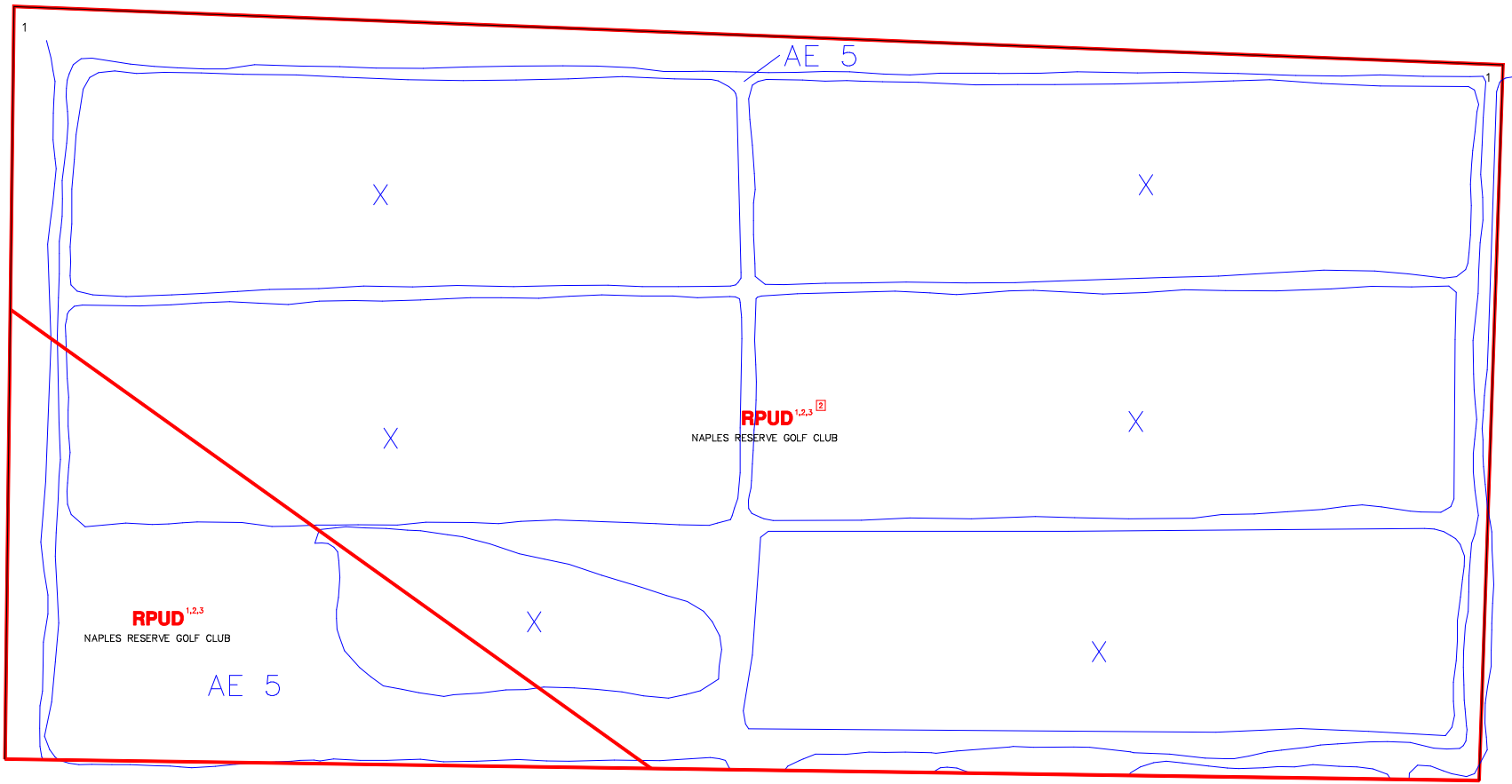

1601S

SUBDIVISION INDEX							
NO.	NAME	P.B.	Pg.	NO.	NAME	P.B.	Pg.
1				11			
2				12			
3				13			
4				14			
5				15			
6				16			
7				17			
8				18			
9				19			
10				20			

**ZONING NOTES**  
 1 6-8-99 RPUD-88-3 88-42  
 2 8-25-04 RPUD-04-08-2732 04-219  
 3 11-10-07 RPUD-07-04-0474 07-171  
 4 11-10-07 RPUD-07-04-0474 07-171

**ZONING OVERLAY NOTES**  
 OVERLAYS CREATED BY  
 LDC ORD. NO. 04-08 1-7-04  
 [2] RPUD-RECEIVING LANDS

THIS IS TO CERTIFY THAT THIS IS A PAGE OF THE OFFICIAL ZONING ATLAS REFERRED TO AND ADOPTED BY REFERENCE BY ORDINANCE NO. 04-41 OF THE COUNTY OF COLLIER, FLORIDA, ADOPTED JUNE 22, 2004.

BY \_\_\_\_\_ CHAIRMAN

ATTEST \_\_\_\_\_ CLERK

FLOOD INSURANCE RATE MAP INFORMATION	
COMMUNITY NUMBER: 120067	PANEL NUMBER: 610G,620G
PROGRAM: REGULAR	EFFECTIVE DATE: NOV. 17, 2005
FLOOD ZONE: ALL _____ OR AS SHOWN ON MAP.	
WIND ZONE: ALL 132 _____ OR AS SHOWN ON MAP.	
COLLIER COUNTY, FLORIDA	
COMMUNITY DEVELOPMENT DIVISION	
TWP. 51S RING. 26E SEC(S) 01 NO 1/2	
SCALE 0 400	MAP NUMBER: 1601N