

1501N

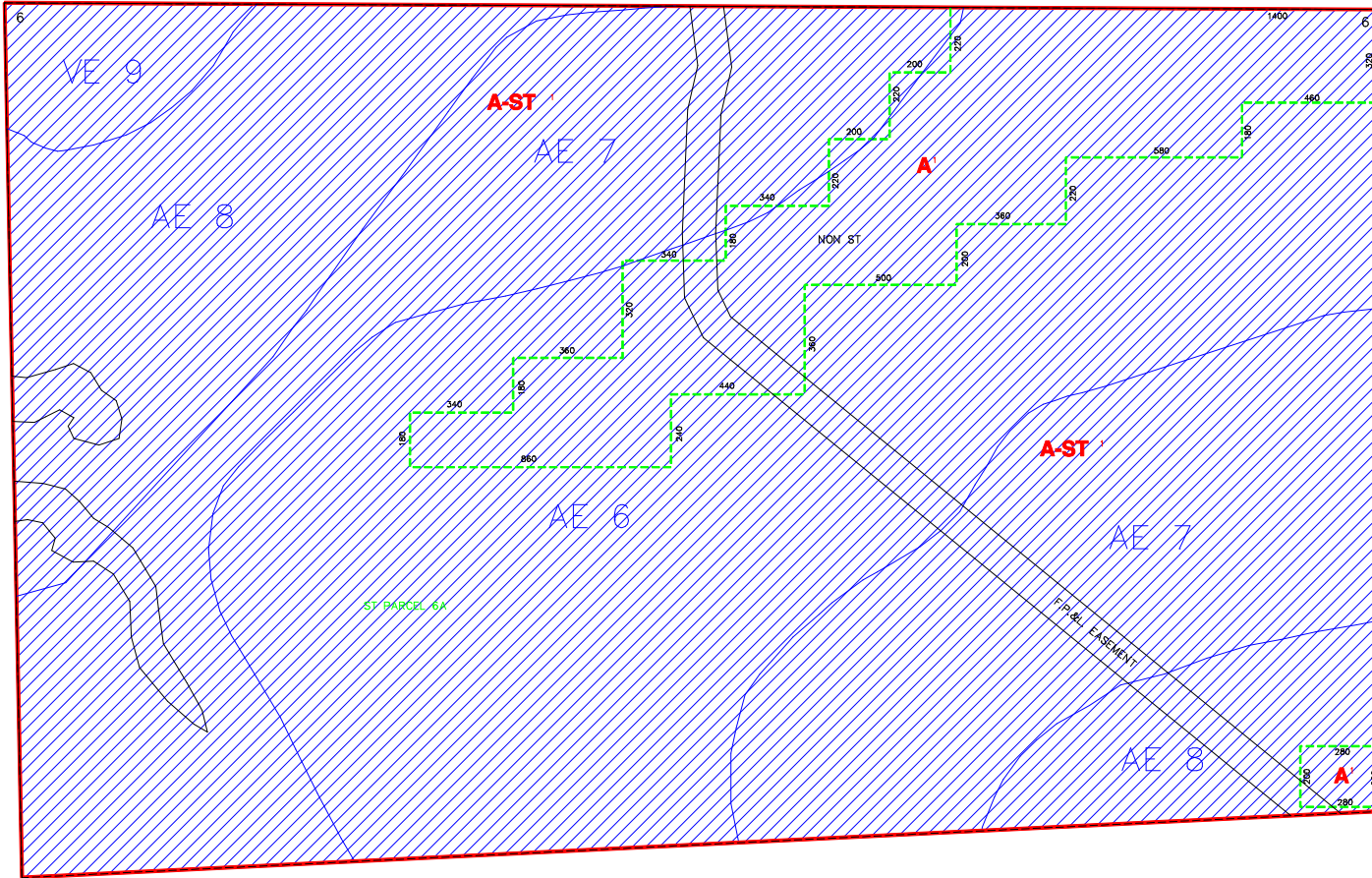

0631S

1605N

1606S

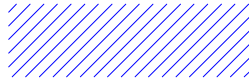

FLOOD INSURANCE NOT AVAILABLE FOR MANY STRUCTURES NEWLY BUILT OR SUBSTANTIALLY IMPROVED. SEE FLOOD INSURANCE RATE MAP FOR CONTROLLING DATES.

--- INDICATES SPECIAL TREATMENT OVERLAY

SUBDIVISION INDEX

NO.	NAME	P.B.	Pg.	NO.	NAME	P.B.	Pg.
11				11			
12				12			
13				13			
14				14			
15				15			
16				16			
17				17			
18				18			
19				19			
20				20			

ZONING NOTES  
LDC-61  
1-22-2008

THIS IS TO CERTIFY THAT THIS IS A PAGE OF THE OFFICIAL ZONING ATLAS REFERRED TO AND ADOPTED BY ORDINANCE NO. 04-41 OF THE COUNTY OF COLLIER, FLORIDA, ADOPTED JUNE 22, 2004.

BY \_\_\_\_\_ CHAIRMAN

ATTEST \_\_\_\_\_ CLERK

FLOOD INSURANCE RATE MAP INFORMATION

COMMUNITY NUMBER: 120067 PANEL NUMBER: 603G,615G  
 PROGRAM: REGULAR EFFECTIVE DATE: NOV. 17, 2005  
 FLOOD ZONE: ALL \_\_\_\_\_ OR AS SHOWN ON MAP.  
 WIND ZONE: ALL 133 \_\_\_\_\_ OR AS SHOWN ON MAP.

COLLIER COUNTY, FLORIDA

COMMUNITY DEVELOPMENT DIVISION  
 TWP. 51S RING. 26E SEC(S) 06 NO 1/2

SCALE 0 400 MAP NUMBER: 1606N