

1608S

1608N

1610S

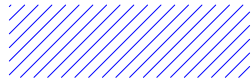
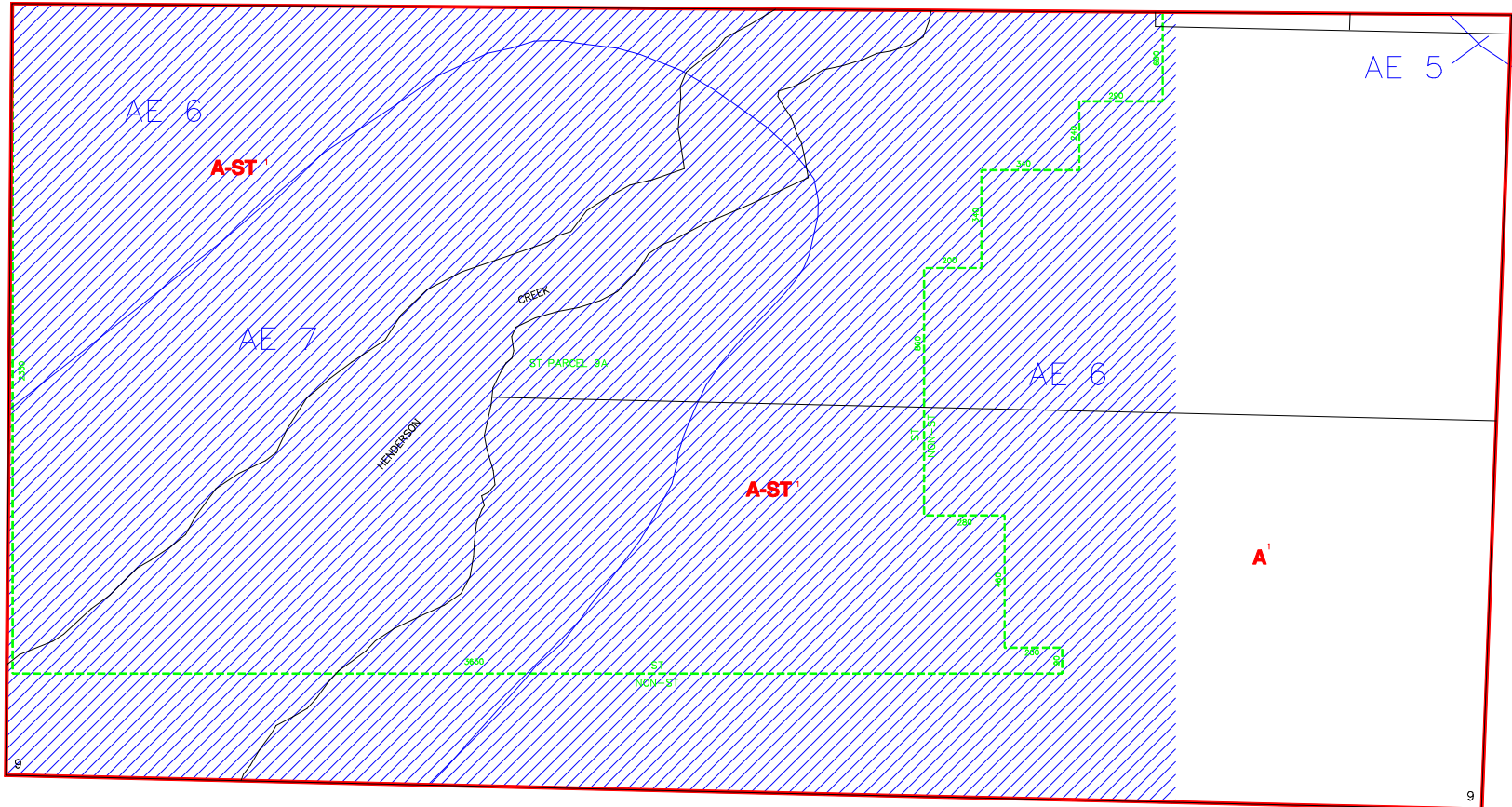

FLOOD INSURANCE NOT AVAILABLE FOR MANY STRUCTURES NEWLY BUILT OR SUBSTANTIALLY IMPROVED. SEE FLOOD INSURANCE RATE MAP FOR CONTROLLING DATES.

----- INDICATES SPECIAL TREATMENT OVERLAY

1616N

SUBDIVISION INDEX							
NO.	NAME	P.B.	Pg.	NO.	NAME	P.B.	Pg.
11				11			
12				12			
13				13			
14				14			
15				15			
16				16			
17				17			
18				18			
19				19			
20				20			

ZONING NOTES
1. LDC-91
NOTED

THIS IS TO CERTIFY THAT THIS IS A PAGE OF THE OFFICIAL ZONING ATLAS REFERRED TO AND ADOPTED BY ORDINANCE NO. 04-41 OF THE COUNTY OF COLLIER, FLORIDA, ADOPTED JUNE 22, 2004.

BY _____ CHAIRMAN

ATTEST _____ CLERK

FLOOD INSURANCE RATE MAP INFORMATION	
COMMUNITY NUMBER: 120067	PANEL NUMBER: 615G
PROGRAM: REGULAR	EFFECTIVE DATE: NOV. 17, 2005
FLOOD ZONE: ALL _____ OR AS SHOWN ON MAP.	
WIND ZONE: ALL 133 _____ OR AS SHOWN ON MAP.	
COLLIER COUNTY, FLORIDA	
COMMUNITY DEVELOPMENT DIVISION	
TWP. 51S RING. 26E SEC(S) 09 SO 1/2	
SCALE	MAP NUMBER:
0 400	1609S