

LAST REVISION: ZONING-----OTHER-----

The Historic/Archaeological Probability Maps are the official County source designating historic or archaeological resources.

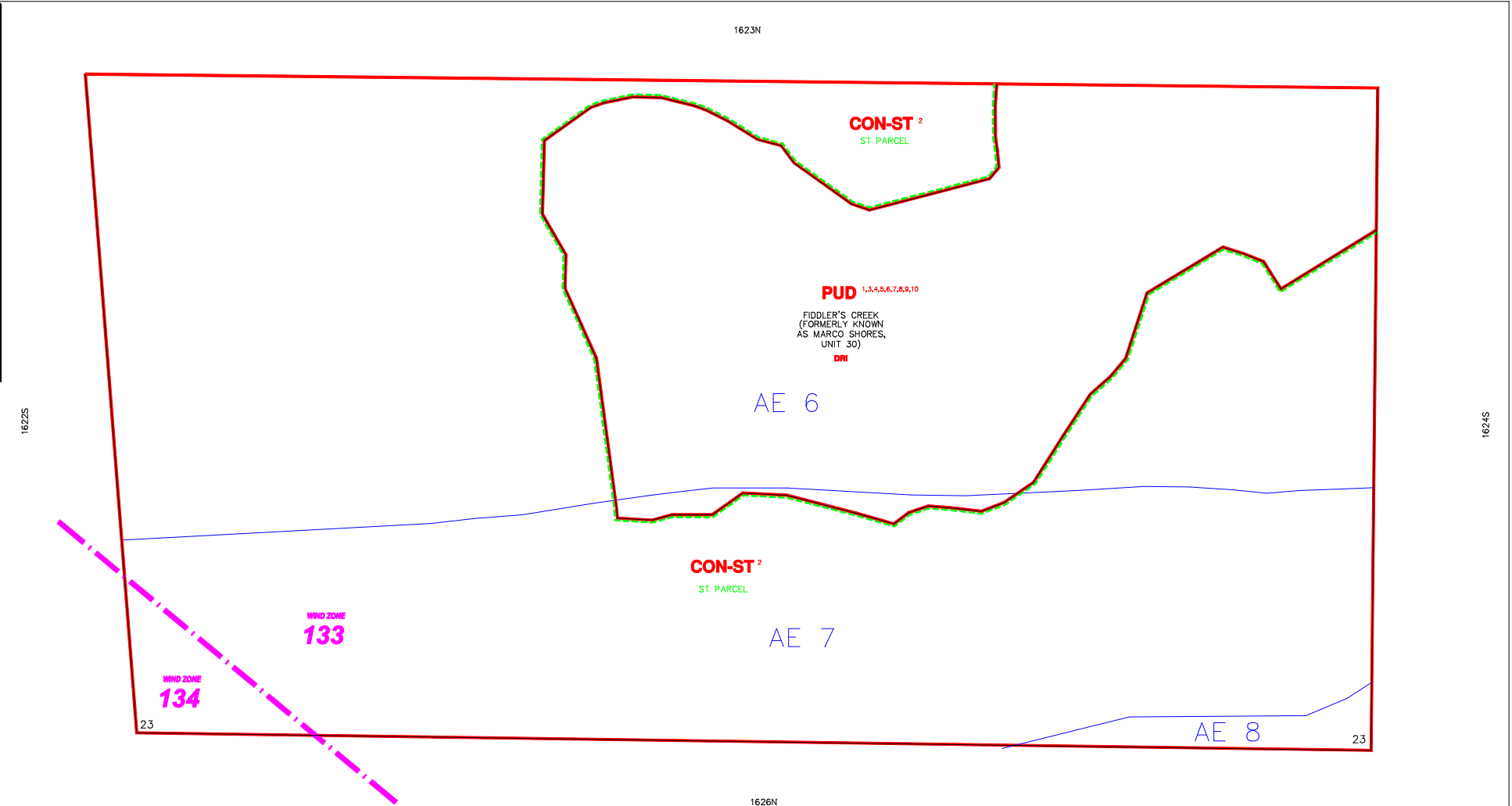

- - - - - INDICATES SPECIAL TREATMENT OVERLAY  
 - - - - - INDICATES WIND ZONE BOUNDARY LINE

SUBDIVISION INDEX			
NO.	NAME	P.B.	Pg.
11			
12			
13			
14			
15			
16			
17			
18			
19			
20			

**ZONING NOTES**

- 1 8-84-7C 6-12-84
- 2 2-25-86 PD04-86-1 86-333
- 3 1-23-86 PD04-86-7(1) 86-74
- 4 1-23-86 PD04-86-7(1) 86-74
- 5 1-28-88 PD04-88-10 88-300, 88-529
- 6 2-24-88 PD04-88-3 88-49
- 7 2-24-88 PD04-88-3 88-49
- 8 2-24-88 PD04-88-3 88-49
- 9 12-12-00 PD04-00-7 00-258
- 10 12-12-00 PD04-00-7 00-258

THIS IS TO CERTIFY THAT THIS IS A PAGE OF THE OFFICIAL ZONING ATLAS REFERRED TO AND ADOPTED BY REFERENCE BY ORDINANCE NO. 04-41 OF THE COUNTY OF COLLIER, FLORIDA, ADOPTED JUNE 22, 2004.

BY \_\_\_\_\_ CHAIRMAN

ATTEST \_\_\_\_\_ CLERK

FLOOD INSURANCE RATE MAP INFORMATION	
COMMUNITY NUMBER: 120067	PANEL NUMBER 615G,620G
PROGRAM: REGULAR	EFFECTIVE DATE: NOV. 17, 2005
FLOOD ZONE: ALL _____ OR AS SHOWN ON MAP.	
WIND ZONE: ALL _____ OR AS SHOWN ON MAP.	
COLLIER COUNTY, FLORIDA	
COMMUNITY DEVELOPMENT DIVISION	
TWP. 51S RING. 26E SEC(S) 23 S0 1/2	
SCALE	MAP NUMBER:
0 400	1623S