

The Historic/Archaeological Probability Maps are the official County source designating historic or archaeological resources.

LAST REVISION: ZONING _____ OTHER _____

1623S

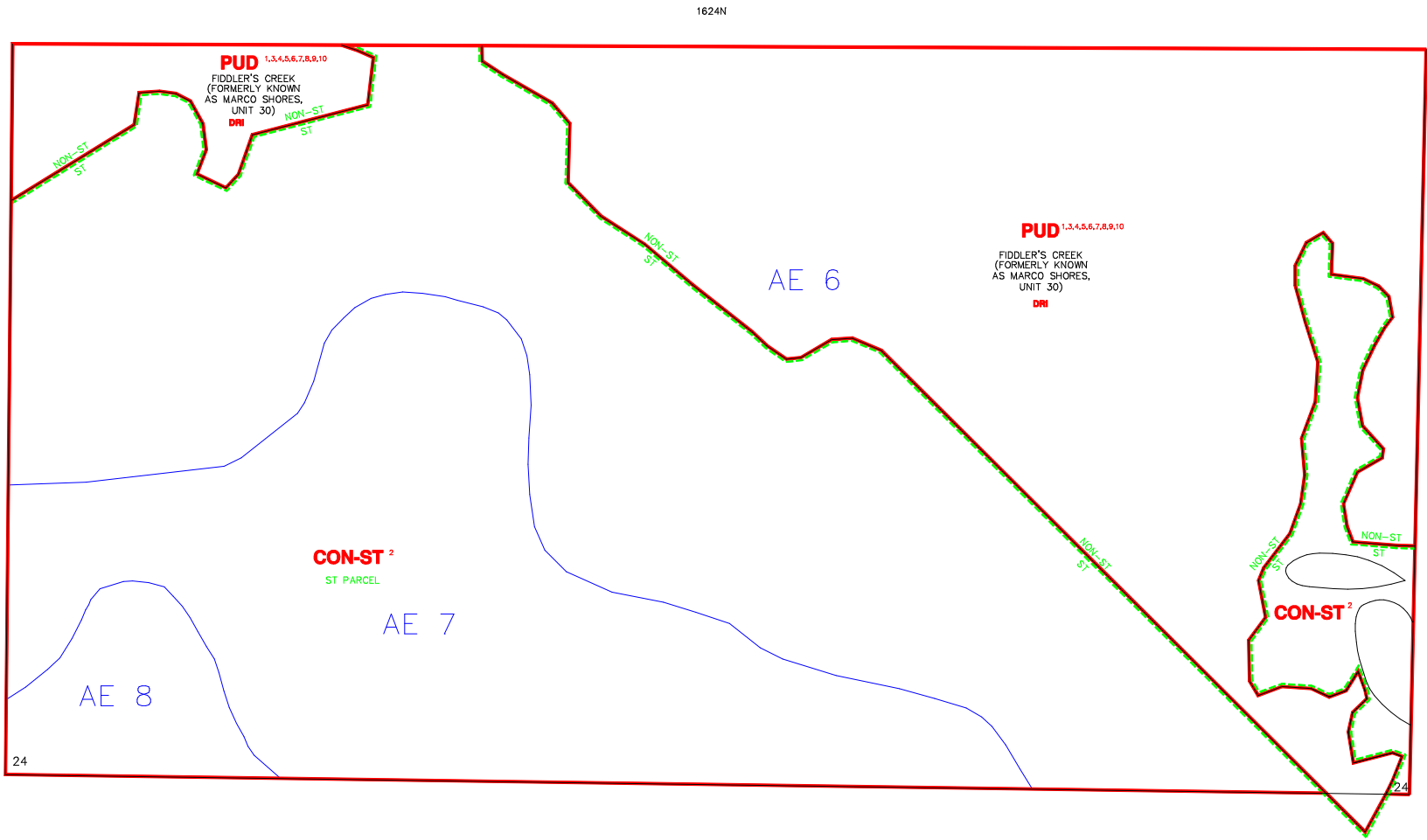

512728

-----INDICATES SPECIAL TREATMENT OVERLAY

SUBDIVISION INDEX							
NO.	NAME	P.B.	Pg.	NO.	NAME	P.B.	Pg.
11				11			
12				12			
13				13			
14				14			
15				15			
16				16			
17				17			
18				18			
19				19			
20				20			

- ZONING NOTES
- 1 6-12-84
 - 2 6-12-84
 - 3 6-12-84
 - 4 6-12-84
 - 5 6-12-84
 - 6 6-12-84
 - 7 6-12-84
 - 8 6-12-84
 - 9 6-12-84
 - 10 6-12-84
 - 11 6-12-84
 - 12 6-12-84
 - 13 6-12-84
 - 14 6-12-84
 - 15 6-12-84
 - 16 6-12-84
 - 17 6-12-84
 - 18 6-12-84
 - 19 6-12-84
 - 20 6-12-84

THIS IS TO CERTIFY THAT THIS IS A PAGE OF THE OFFICIAL ZONING ATLAS REFERRED TO AND ADOPTED BY REFERENCE BY ORDINANCE NO. 04-41 OF THE COUNTY OF COLLIER, FLORIDA, ADOPTED JUNE 22, 2004.

BY _____ CHAIRMAN
 ATTEST _____ CLERK

FLOOD INSURANCE RATE MAP INFORMATION	
COMMUNITY NUMBER: 120067	PANEL NUMBER 620G
PROGRAM: REGULAR	EFFECTIVE DATE: NOV. 17, 2005
FLOOD ZONE: ALL _____ OR AS SHOWN ON MAP.	
WIND ZONE: ALL 133 _____ OR AS SHOWN ON MAP.	
COLLIER COUNTY, FLORIDA	
COMMUNITY DEVELOPMENT DIVISION	
TWP. 51S RNG. 26E SEC(S) 24 SO 1/2	
SCALE	MAP NUMBER:
0 400	1624S