

The Historic/Archaeological Probability Maps are the official County source designating historic or archaeological resources.

LAST REVISION: ZONING _____ OTHER _____

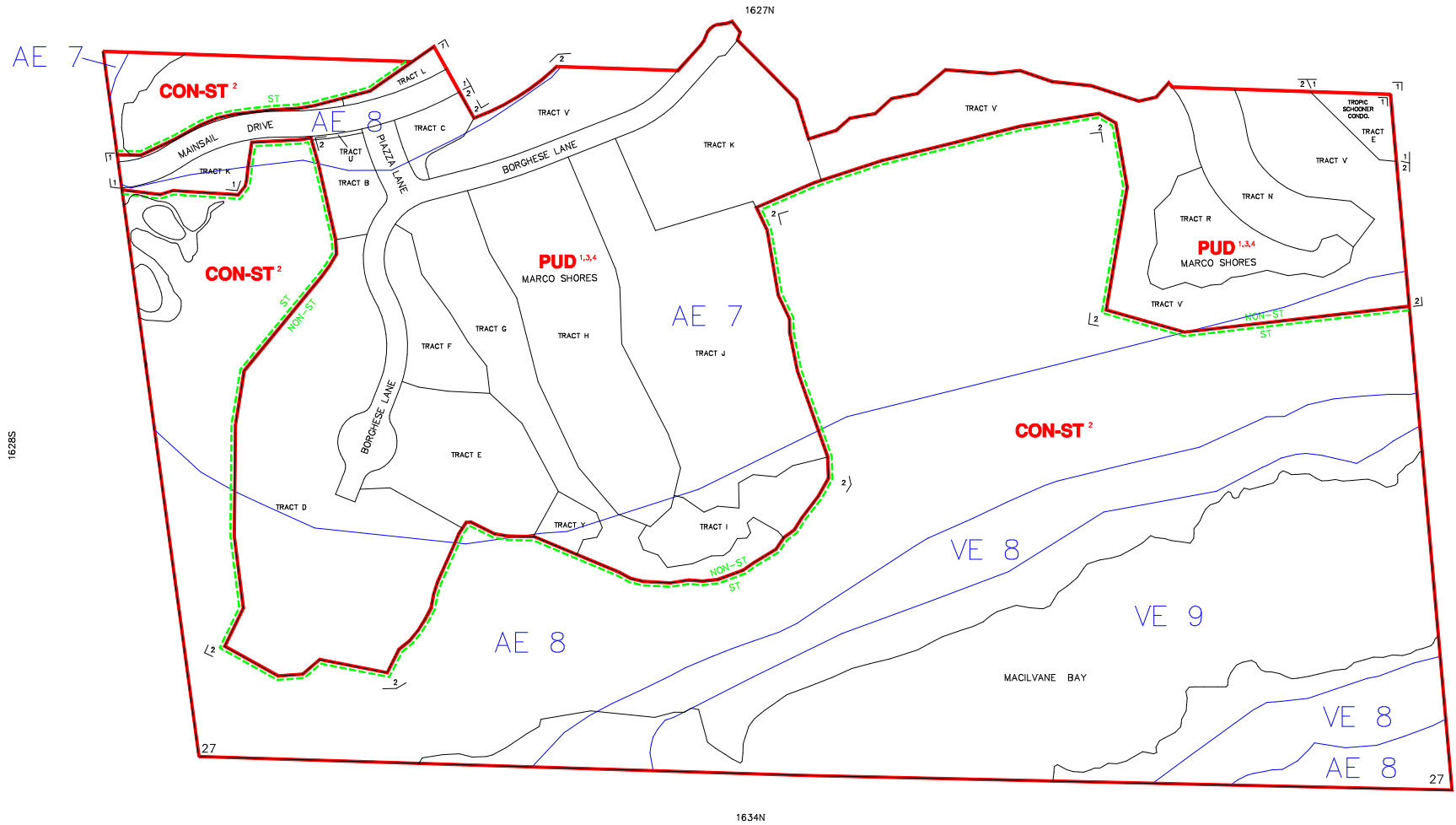

----- INDICATES SPECIAL TREATMENT OVERLAY

SUBDIVISION INDEX							
NO.	NAME	P.B.	Pg.	NO.	NAME	P.B.	Pg.
1	MARCO SHORES UNIT 1	14	33-38	11			
	HAMMOCK BAY	39	14-19	12			
				13			
				14			
				15			
				16			
				17			
				18			
				19			
				20			

ZONING NOTES

1 PD-86-8C AMEND. TO PUD(0-9)
 2 PD-86-8C
 3 PD-86-8C
 4 PD-86-8C
 5 PD-86-8C
 6 PD-86-8C
 7 PD-86-8C
 8 PD-86-8C
 9 PD-86-8C
 10 PD-86-8C

THIS IS TO CERTIFY THAT THIS IS A PAGE OF THE OFFICIAL ZONING ATLAS REFERRED TO AND ADOPTED BY REFERENCE BY ORDINANCE NO. 04-41 OF THE COUNTY OF COLLIER, FLORIDA, ADOPTED JUNE 22, 2004.

BY _____ CHAIRMAN

ATTEST _____ CLERK

FLOOD INSURANCE RATE MAP INFORMATION	
COMMUNITY NUMBER: 120067	PANEL NUMBER: 802G,825G
PROGRAM: REGULAR	EFFECTIVE DATE: NOV. 17, 2005
FLOOD ZONE: ALL _____ OR AS SHOWN ON MAP.	
WIND ZONE: ALL 134 _____ OR AS SHOWN ON MAP.	
COLLIER COUNTY, FLORIDA	
COMMUNITY DEVELOPMENT DIVISION	
TWP. 51S RING. 26E SEC(S) 27 SO 1/2	
SCALE	MAP NUMBER:
0 400	1627S