

The Historic/Archaeological Probability Maps are the official County source designating historic or archaeological resources.

1632S

1633N

1634S

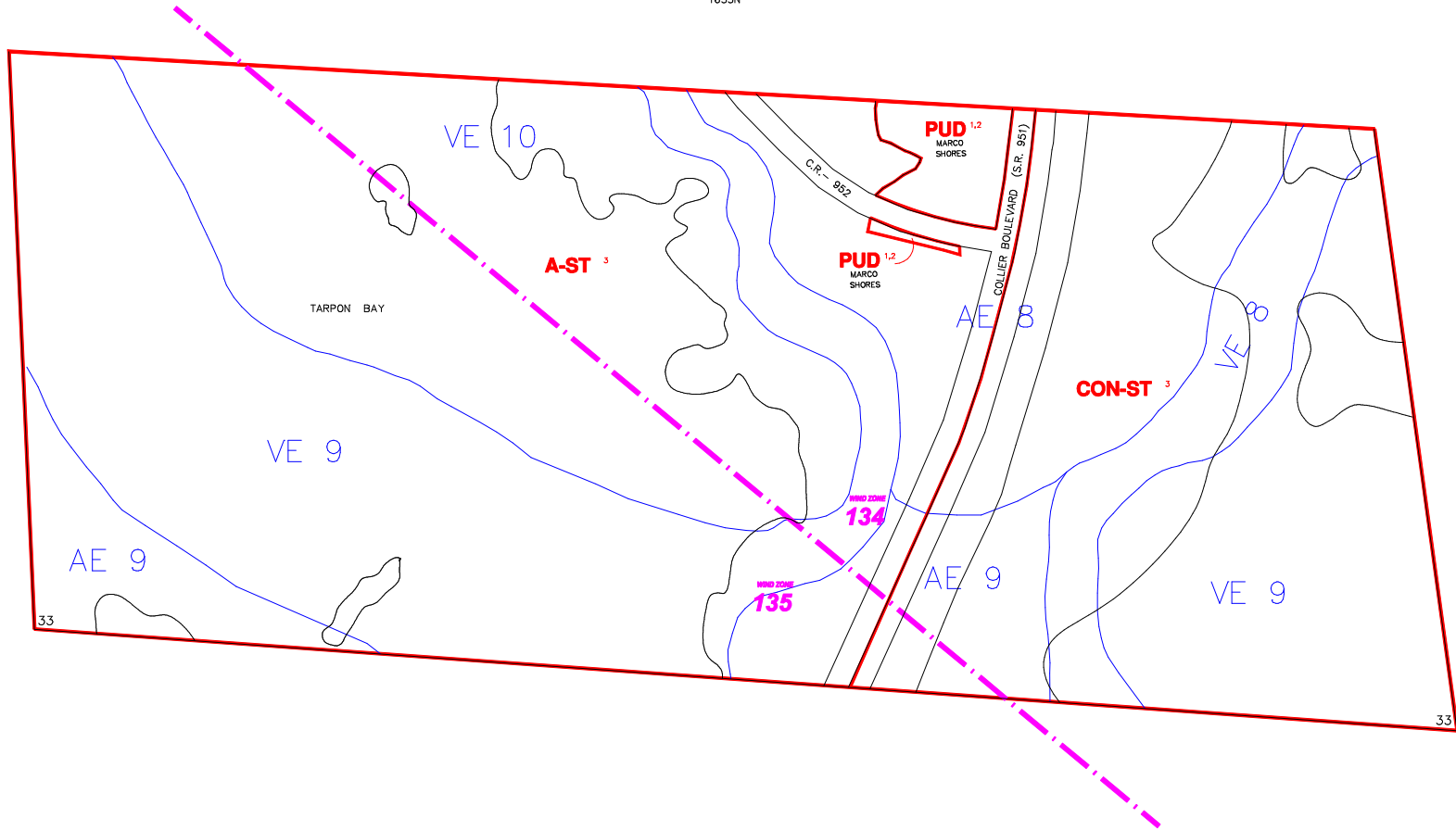

33

33

LAST REVISION: ZONING _____ OTHER _____

----- INDICATES SPECIAL TREATMENT OVERLAY
 - - - - - INDICATES WIND ZONE BOUNDARY LINE

MB1B

ZONING NOTES
 1. PUD 1,2 MARCO SHORES
 2. PUD 1,2 MARCO SHORES
 3. LDC-81
 4. LDC-81
 5. LDC-81
 6. LDC-81

THIS IS TO CERTIFY THAT THIS IS A PAGE OF THE OFFICIAL ZONING ATLAS REFERRED TO AND ADOPTED BY REFERENCE BY ORDINANCE NO. 04-41 OF THE COUNTY OF COLLIER, FLORIDA, ADOPTED JUNE 22, 2004.

BY _____ CHAIRMAN

ATTEST _____ CLERK

FLOOD INSURANCE RATE MAP INFORMATION	
COMMUNITY NUMBER: 120067 PANEL NUMBER: 802G	
PROGRAM: REGULAR EFFECTIVE DATE: NOV. 17, 2005	
FLOOD ZONE: ALL _____ OR AS SHOWN ON MAP.	
WIND ZONE: ALL _____ OR AS SHOWN ON MAP.	
COLLIER COUNTY, FLORIDA	
COMMUNITY DEVELOPMENT DIVISION	
TWP 51S RNG 26E SEC(S) 33 SO 1/2	
SCALE 0 500	MAP NUMBER: 1633S

SUBDIVISION INDEX							
NO.	NAME	P.B.	Pg.	NO.	NAME	P.B.	Pg.
				11			
				12			
				13			
				14			
				15			
				16			
				17			
				18			
				19			
				20			