

171718

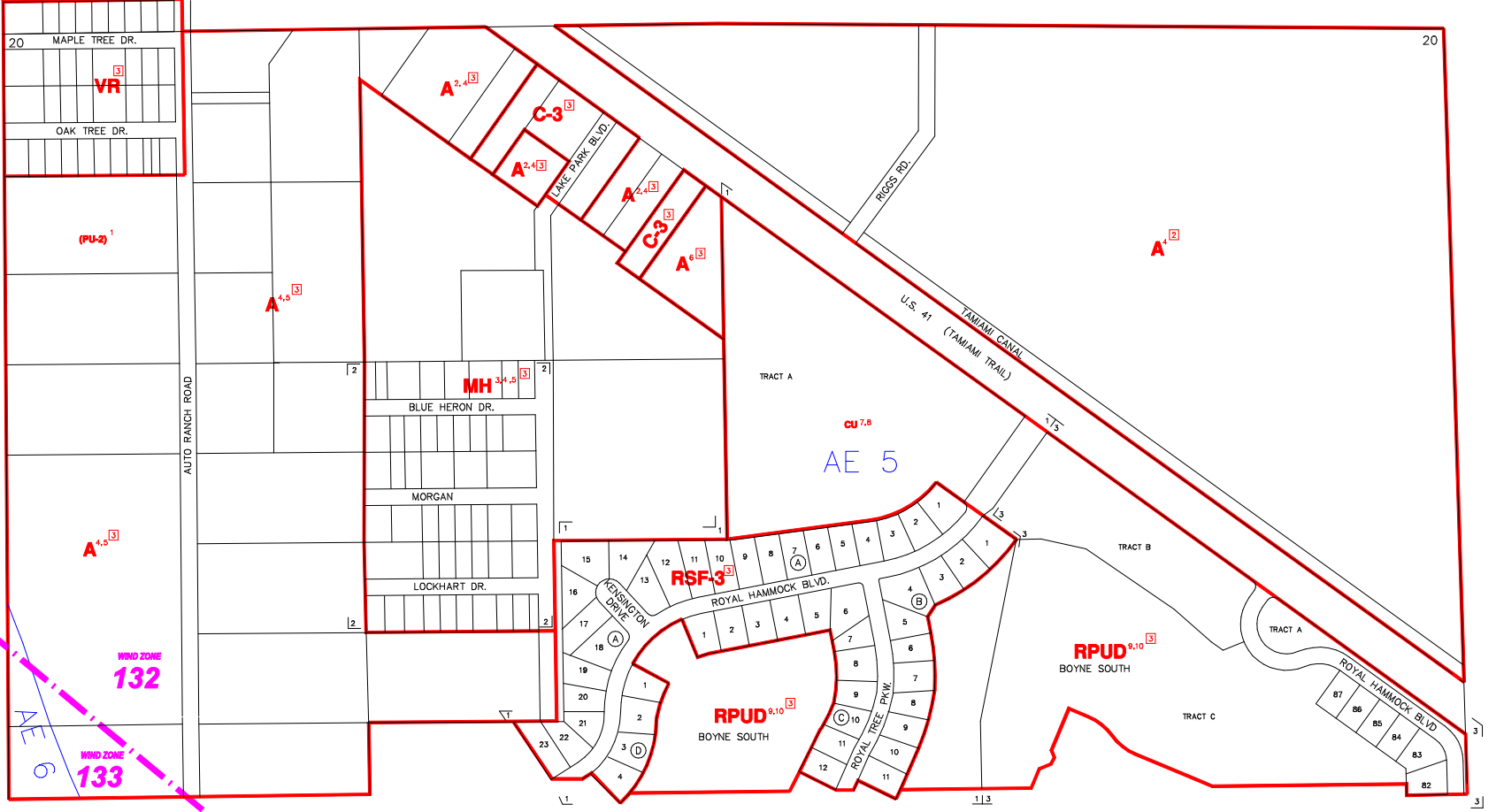

512728

512728

20 MAPLE TREE DR.

OAK TREE DR.

AUTO RANCH ROAD

BLUE HERON DR.

MORGAN

LOCKHART DR.

KENSINGTON DRIVE

ROYAL HAMMOCK BLVD.

BOYNE SOUTH

ROYAL HAMMOCK BLVD.

ROYAL HAMMOCK BLVD.

ROYAL HAMMOCK BLVD.

ROYAL HAMMOCK BLVD.

ROYAL HAMMOCK BLVD.

ROYAL HAMMOCK BLVD.

ROYAL HAMMOCK BLVD.

ROYAL HAMMOCK BLVD.

ROYAL HAMMOCK BLVD.

ROYAL HAMMOCK BLVD.

ROYAL HAMMOCK BLVD.

ROYAL HAMMOCK BLVD.

ROYAL HAMMOCK BLVD.

ROYAL HAMMOCK BLVD.

ROYAL HAMMOCK BLVD.

ROYAL HAMMOCK BLVD.

ROYAL HAMMOCK BLVD.

ROYAL HAMMOCK BLVD.

WIND ZONE 132

WIND ZONE 133

INDICATES WIND ZONE BOUNDARY LINE

1720S

SUBDIVISION INDEX			
NO.	NAME	P.B.	Pg.
1	ROYAL PALM GOLF EST. 1	UNREC'D	14
2	BLUE HERON LAKE PARK	UNREC'D	14
3	ROYAL PALM GOLF EST. REPLAT #3	UNREC'D	14
4		89-99	14
11			11
12			12
13			13
14			14
15			15
16			16
17			17
18			18
19			19
20			20

**ZONING NOTES**

1 1-12-82 PU-87-19-C (ZPO)

2 1-17-91 R-80-34 81-1

3 4-16-91 R-80-34 81-1

4 10-18-97 R-80-34 81-1

5 10-18-97 R-80-34 81-1

6 2-4-97 CU-35-20 EXT. 97-71

7 2-4-97 CU-35-20 EXT. 97-71

8 2-4-97 CU-35-20 EXT. 97-71

9 2-4-97 CU-35-20 EXT. 97-71

10 2-4-97 CU-35-20 EXT. 97-71

11 2-4-97 CU-35-20 EXT. 97-71

12 2-4-97 CU-35-20 EXT. 97-71

13 2-4-97 CU-35-20 EXT. 97-71

14 2-4-97 CU-35-20 EXT. 97-71

15 2-4-97 CU-35-20 EXT. 97-71

16 2-4-97 CU-35-20 EXT. 97-71

17 2-4-97 CU-35-20 EXT. 97-71

18 2-4-97 CU-35-20 EXT. 97-71

19 2-4-97 CU-35-20 EXT. 97-71

20 2-4-97 CU-35-20 EXT. 97-71

**ZONING OVERLAY NOTES**

OVERLAYS CREATED BY

LOC ORD. No. 04-08 1-7-04

2 RPUD-RECEIVING LANDS

3 RPUD-NEUTRAL LANDS

THIS IS TO CERTIFY THAT THIS IS A PAGE OF THE OFFICIAL ZONING ATLAS REFERRED TO AND ADOPTEE BY REFERENCE BY ORDINANCE NO. 04-41 OF THE COUNTY OF COLLIER, FLORIDA, ADOPTED JUNE 22, 2004.

BY \_\_\_\_\_ CHAIRMAN

ATTEST \_\_\_\_\_ CLERK

**FLOOD INSURANCE RATE MAP INFORMATION**

COMMUNITY NUMBER: 120067 PANEL NUMBER 620G,650G

PROGRAM: REGULAR EFFECTIVE DATE: NOV. 17, 2005

FLOOD ZONE: ALL \_\_\_\_\_ OR AS SHOWN ON MAP.

WIND ZONE: ALL \_\_\_\_\_ OR AS SHOWN ON MAP.

COLLIER COUNTY, FLORIDA

COMMUNITY DEVELOPMENT DIVISION

TWP 51S RNG 27E SEC 20 NO 1/2

SCALE 1" = 400'

MAP NUMBER: 1720N