

The Historic/Archaeological Probability Maps are the official County source designating historic or archaeological resources.

LAST REVISION: ZONING _____ OTHER _____

CGE16

T 51 S

CGE17

R 29 E

502930

R 30 E

WIND ZONE 125

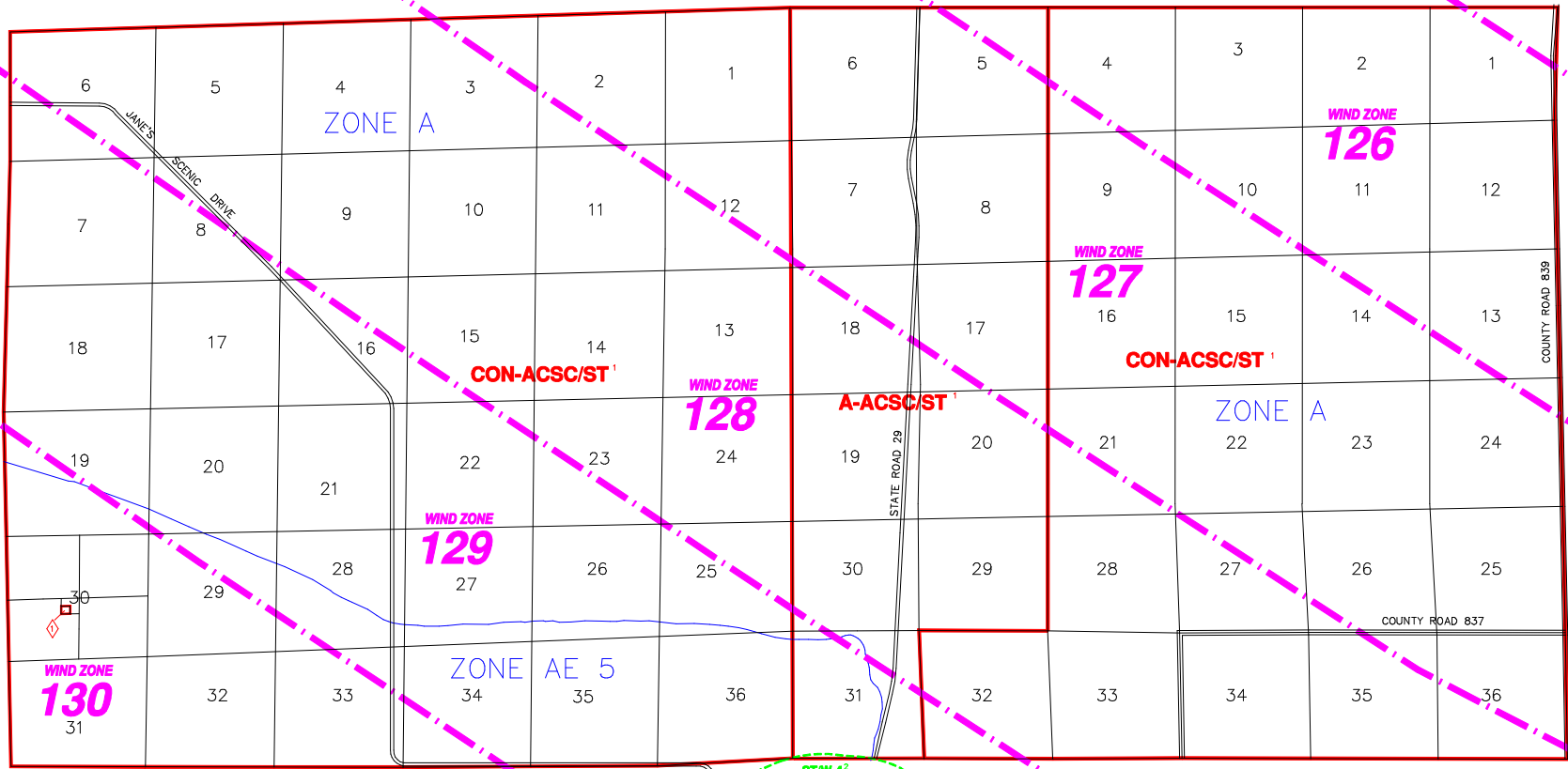

513132

522930

--- INDICATES SPECIAL TREATMENT OVERLAY
 - - - - - INDICATES WIND ZONE BOUNDARY LINE

SUBDIVISION INDEX

NO.	NAME	P.B.	Pg.	NO.	NAME	P.B.	Pg.
1				11			
2				12			
3				13			
4				14			
5				15			
6				16			
7				17			
8				18			
9				19			
10				20			

ZONING NOTES
 1 LDC-91
 2 6-15-05 LDC ORD. 00-27

DEVELOPMENT STANDARDS MODIFICATIONS
 7-16-96 TDR-96-2 96-39

THIS IS TO CERTIFY THAT THIS IS A PAGE OF THE OFFICIAL ZONING ATLAS REFERRED TO AND ADOPTED BY REFERENCE BY ORDINANCE NO. 04-41 OF THE COUNTY OF COLLIER, FLORIDA, ADOPTED JUNE 22, 2004.

BY _____ CHAIRMAN
 ATTEST _____ CLERK

FLOOD INSURANCE RATE MAP INFORMATION	
COMMUNITY NUMBER: 120067	PANEL NUMBER: 8756.9006
PROGRAM: REGULAR	EFFECTIVE DATE: NOV. 17, 2005
FLOOD ZONE: ALL _____ OR AS SHOWN ON MAP.	
WIND ZONE: ALL _____ OR AS SHOWN ON MAP.	

COLLIER COUNTY, FLORIDA
 COMMUNITY DEVELOPMENT DIVISION
 TWP 51S RNG 29E & 30E
 SCALE 0 4800
 MAP NUMBER: 512930