

The Historic/Archaeological Probability Maps are the official County source designating historic or archaeological resources.

LAST REVISION: ZONING _____ OTHER _____

522930

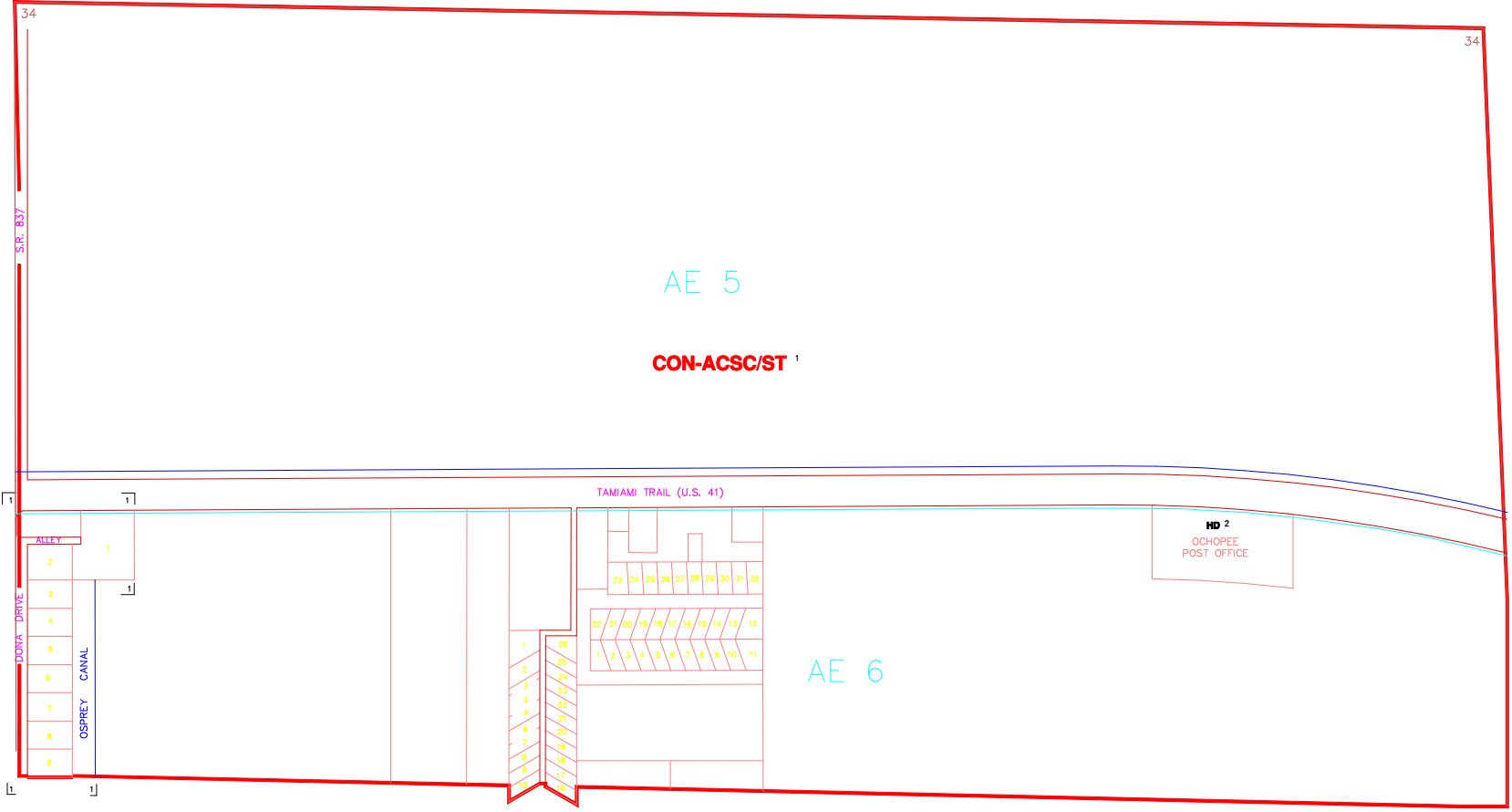

2034S

SUBDIVISION INDEX			
NO.	NAME	P.B.	Pg.
1	KENTUCKYANA ESTATES UNIT 1	9	98

ZONING NOTES
 1 LDC-91
 2-27-94 HD-94-1 84-706

THIS IS TO CERTIFY THAT THIS IS A PAGE OF THE OFFICIAL ZONING ATLAS REFERRED TO AND ADOPTED BY REFERENCE BY ORDINANCE NO. 04-41 OF THE COUNTY OF COLLIER, FLORIDA, ADOPTED JUNE 22, 2004.

BY _____ CHAIRMAN

ATTEST _____ CLERK

FLOOD INSURANCE RATE MAP INFORMATION

COMMUNITY NUMBER: 120067 PANEL NUMBER: 900G

PROGRAM: REGULAR EFFECTIVE DATE: NOV. 17, 2005

FLOOD ZONE: ALL _____ OR AS SHOWN ON MAP.

WIND ZONE: ALL 130 _____ OR AS SHOWN ON MAP.

COLLIER COUNTY, FLORIDA

COMMUNITY DEVELOPMENT DIVISION

TWP 52S RNG30E SEC 34 NO. 1/2

SCALE 0 400

MAP NUMBER: 2034N