

The Historic/Archaeological Probability Maps are the official County source designating historic or archaeological resources.

LAST REVISION: ZONING _____ OTHER _____

R 31 E

513132

R 32 E

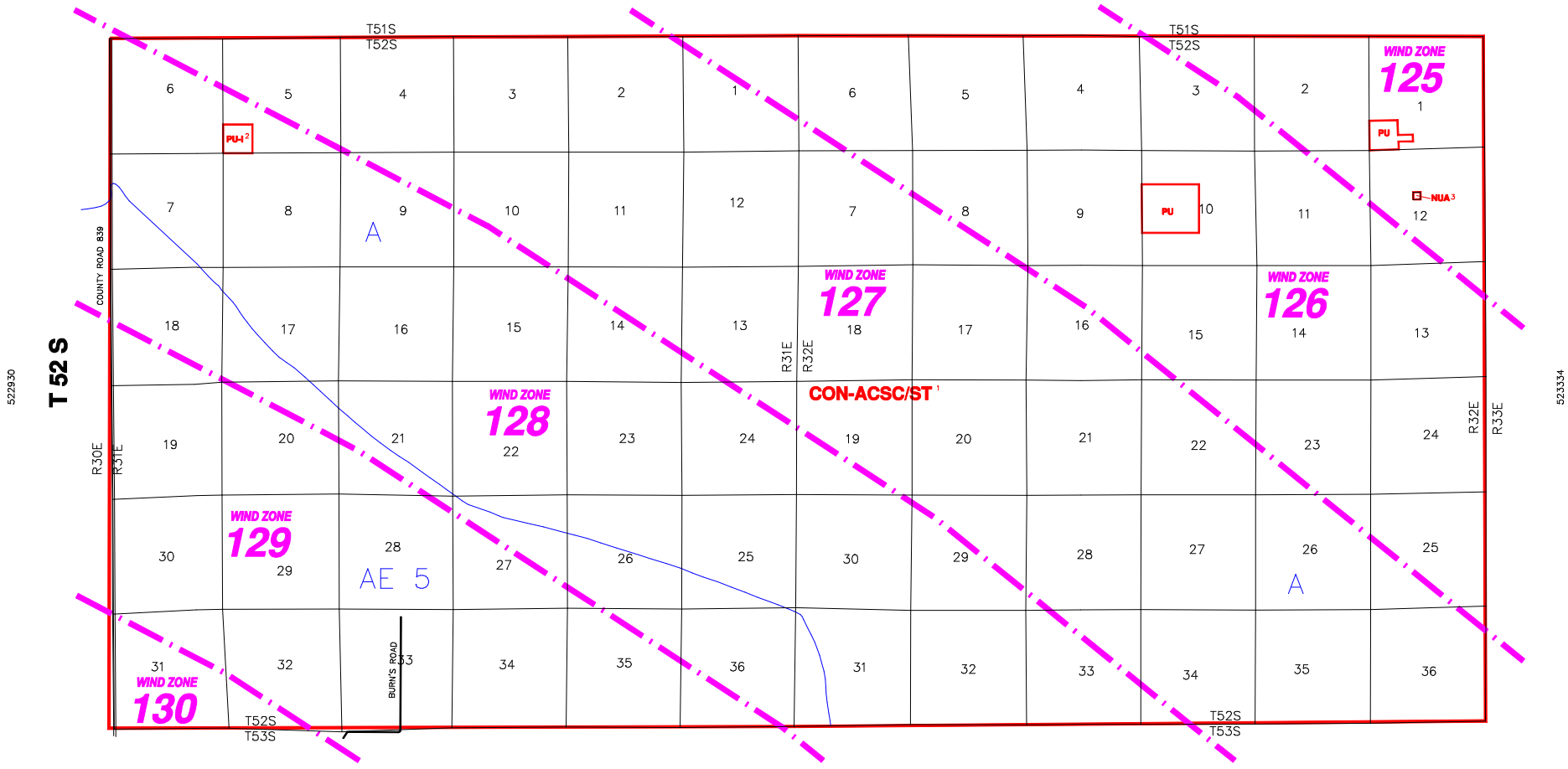

T 52 S

COUNTY ROAD 639

A

AE 5

BURN'S ROAD

6 5 4 3 2 1 6 5 4 3 2 1
 7 8 9 10 11 12 7 8 9 10 11 12
 18 17 16 15 14 13 18 17 16 15 14 13
 19 20 21 22 23 24 19 20 21 22 23 24
 30 29 28 27 26 25 30 29 28 27 26 25
 31 32 33 34 35 36 31 32 33 34 35 36

WIND ZONE 125

WIND ZONE 127

WIND ZONE 126

WIND ZONE 128

WIND ZONE 129

WIND ZONE 130

CON-ACSC/ST¹

PU4?

PU

PU

PU

NUA 3

R30E R31E

R31E R32E

R32E R33E

5229330

523334

533132

INDICATES WIND ZONE BOUNDARY LINE

SUBDIVISION INDEX

NO.	NAME	P.B.	Pg.	NO.	NAME	P.B.	Pg.
1				11			
2				12			
3				13			
4				14			
5				15			
6				16			
7				17			
8				18			
9				19			
10				20			

ZONING NOTES
 1 LDC-91
 2 8-25-91 PU-91-3-C
 3 9-4-98 NUA-98-1 98-293
 4 11-05-99

THIS IS TO CERTIFY THAT THIS IS A PAGE OF THE OFFICIAL ZONING ATLAS REFERRED TO AND ADOPTED BY REFERENCE BY ORDINANCE NO. 04-41 OF THE COUNTY OF COLLIER, FLORIDA, ADOPTED JUNE 22, 2004.

BY _____ CHAIRMAN
 ATTEST _____ CLERK

FLOOD INSURANCE RATE MAP INFORMATION

COMMUNITY NUMBER: 120067 PANEL NUMBER: 900G
 925C, 930G

PROGRAM: REGULAR EFFECTIVE DATE: NOV. 17, 2005

FLOOD ZONE: ALL _____ OR AS SHOWN ON MAP.

WIND ZONE: ALL _____ OR AS SHOWN ON MAP.

COLLIER COUNTY, FLORIDA
 COMMUNITY DEVELOPMENT DIVISION
 TWP 52S RNG 31E & 32E
 SCALE 0 4800 MAP NUMBER: 523132