

LAST REVISION: ZONING \_\_\_\_\_ OTHER \_\_\_\_\_

The Historic/Archaeological Probability Maps are the official County source designating historic or archaeological resources.

342627

52533134

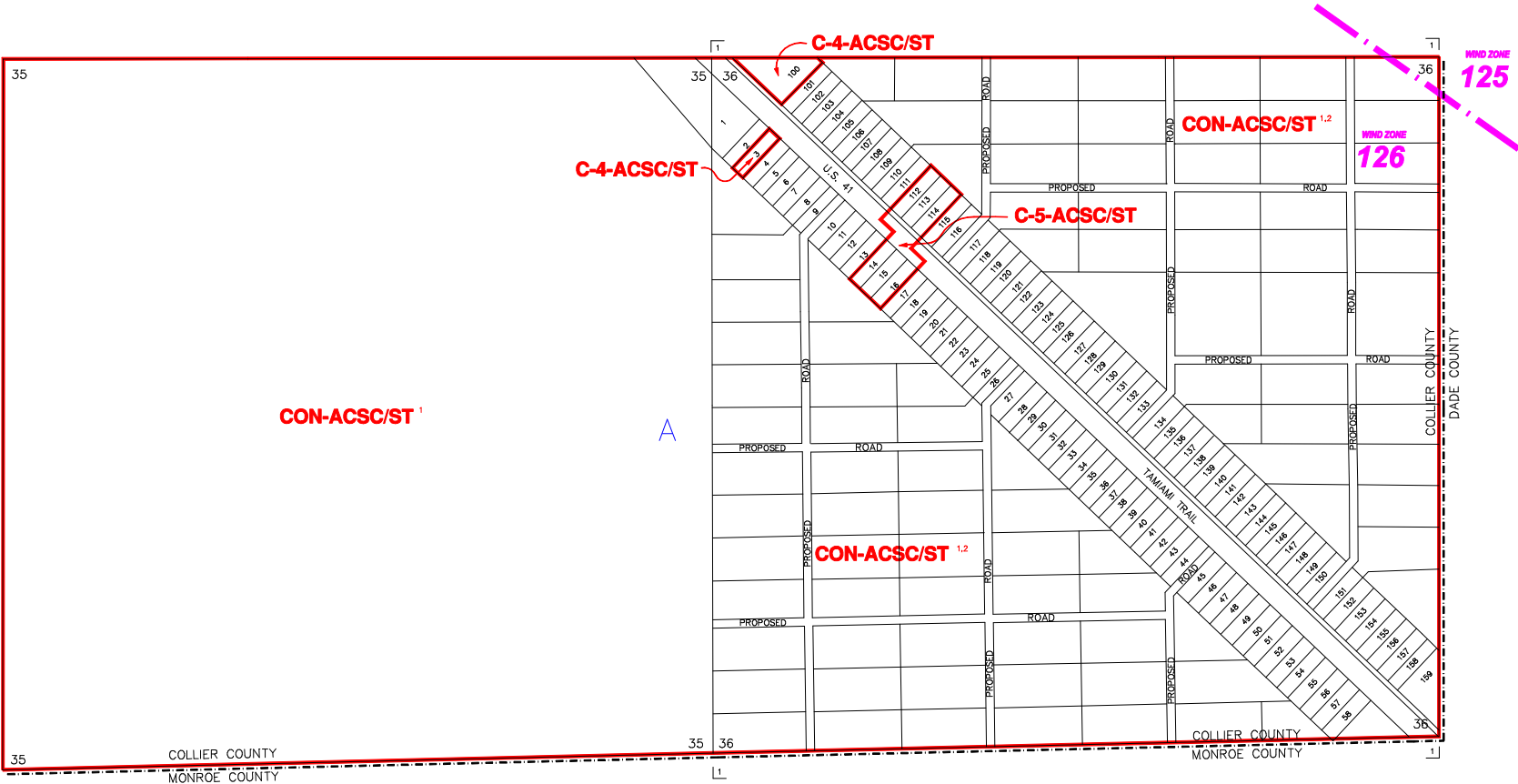

— — — — — INDICATES WIND ZONE BOUNDARY LINE

| SUBDIVISION INDEX |                           |      |     |
|-------------------|---------------------------|------|-----|
| NO.               | NAME                      | P.B. | Pg. |
| 1                 | PAOLTA ACRES - UNRECORDED |      |     |

| SUBDIVISION INDEX |      |      |     |
|-------------------|------|------|-----|
| NO.               | NAME | P.B. | Pg. |
| 11                |      |      |     |
| 12                |      |      |     |
| 13                |      |      |     |
| 14                |      |      |     |
| 15                |      |      |     |
| 16                |      |      |     |
| 17                |      |      |     |
| 18                |      |      |     |
| 19                |      |      |     |
| 20                |      |      |     |

ZONING NOTES  
1 LDC-39  
11 C-18-02 R-02-7 02-74  
11-11-2008

THIS IS TO CERTIFY THAT THIS IS A PAGE OF THE OFFICIAL ZONING ATLAS REFERRED TO AND ADOPTED BY REFERENCE BY ORDINANCE NO. 04-41 OF THE COUNTY OF COLLIER, FLORIDA, ADOPTED JUNE 22, 2004.

BY \_\_\_\_\_ CHAIRMAN

ATTEST \_\_\_\_\_ CLERK

| FLOOD INSURANCE RATE MAP INFORMATION         |                               |
|--|-------------------------------|
| COMMUNITY NUMBER: 120067                     | PANEL NUMBER: 1150G           |
| PROGRAM: REGULAR                             | EFFECTIVE DATE: NOV. 17, 2005 |
| FLOOD ZONE: ALL <u>A</u> OR AS SHOWN ON MAP. |                               |
| WIND ZONE: ALL _____ OR AS SHOWN ON MAP.     |                               |

COLLIER COUNTY, FLORIDA  
 COMMUNITY DEVELOPMENT DIVISION  
 TWP. 53S RING. 34E SECS. 35 & 36  
 SCALE 0 800  
 MAP NUMBER: 343536

52533134