

The Historic/Archaeological Probability Maps are the official County source designating historic or archaeological resources.

LAST REVISION: ZONING _____ OTHER _____

GCE26

9622N

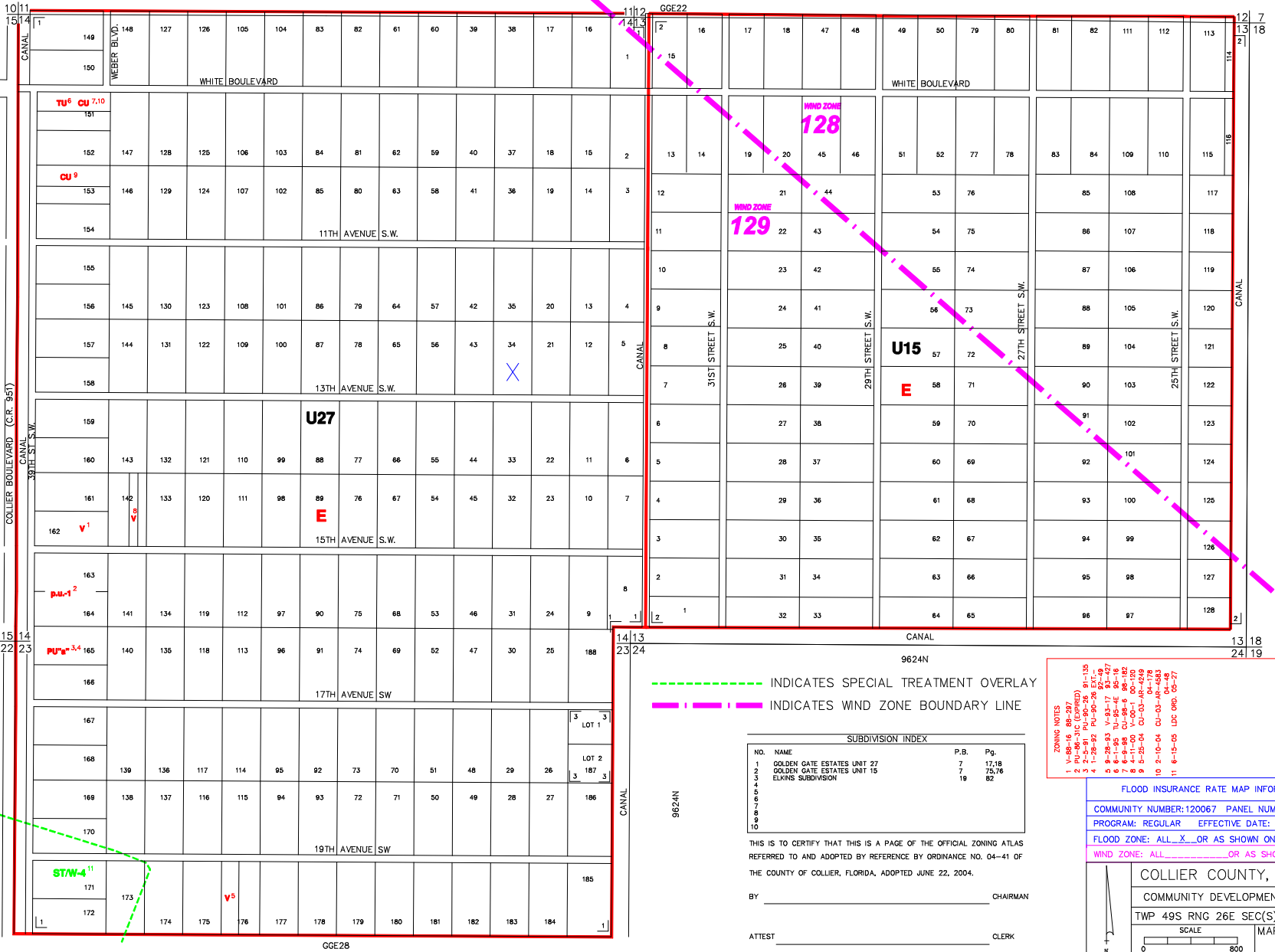

--- INDICATES SPECIAL TREATMENT OVERLAY
 - - - - - INDICATES WIND ZONE BOUNDARY LINE

SUBDIVISION INDEX			
NO.	NAME	P.B.	Pg.
1	GOLDEN GATE ESTATES UNIT 27	7	17,18
2	GOLDEN GATE ESTATES UNIT 15	7	75,76
3	ELKINS SUBDIVISION	19	82

THIS IS TO CERTIFY THAT THIS IS A PAGE OF THE OFFICIAL ZONING ATLAS REFERRED TO AND ADOPTED BY REFERENCE BY ORDINANCE NO. 04-41 OF THE COUNTY OF COLLIER, FLORIDA, ADOPTED JUNE 22, 2004.

BY _____ CHAIRMAN
 ATTEST _____ CLERK

- ZONING NOTES**
- 1 V-16-16 (88-297)
 - 2 V-16-16 (88-297)
 - 3 P.U.-9-1
 - 4 1-26-92 P.U.-90-26 E3-16
 - 5 2-26-93 V-93-17 E3-17
 - 6 3-26-93 V-93-17 E3-17
 - 7 4-26-93 V-93-17 E3-17
 - 8 4-11-00 V-00-1 00-100
 - 9 5-25-04 CU-03-08-1519
 - 10 2-10-04 CU-03-08-4583
 - 11 6-16-05 IUC 090-05-77

FLOOD INSURANCE RATE MAP INFORMATION

COMMUNITY NUMBER: 120067 PANEL NUMBER 425G
 PROGRAM: REGULAR EFFECTIVE DATE: NOV. 17, 2005
 FLOOD ZONE: ALL X OR AS SHOWN ON MAP.
 WIND ZONE: ALL _____ OR AS SHOWN ON MAP.

COLLIER COUNTY, FLORIDA
 COMMUNITY DEVELOPMENT DIVISION
 TWP 49S RNG 26E SEC(S) 13,14,23pt.
 SCALE 1" = 800'
 MAP NUMBER: GGE27

UNITS
 15
 27