

The Historic/Archaeological Probability Maps are the official County source designating historic or archaeological resources.

LAST REVISION: ZONING _____ OTHER _____

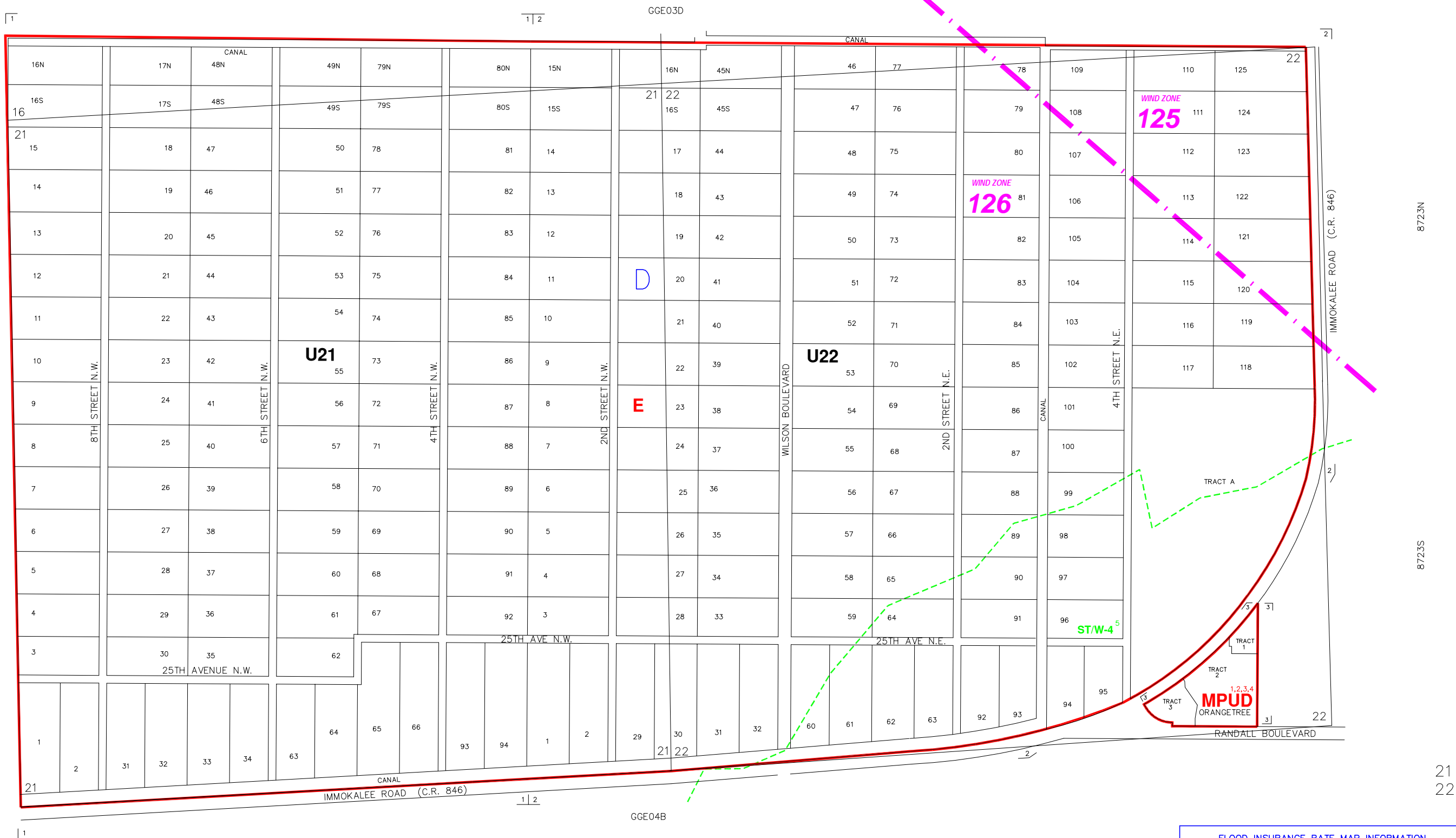

--- INDICATES SPECIAL TREATMENT OVERLAY
 --- INDICATES WIND ZONE BOUNDARY LINE

SUBDIVISION INDEX							
NO.	NAME	P.B.	Pg.	NO.	NAME	P.B.	Pg.
1	GOLDEN GATE ESTATES UNIT 21	7	81-82	11			
2	GOLDEN GATE ESTATES UNIT 22	7	83-84	12			
3	NEIGHBORHOOD SHOPPES AT ORANGETREE	50	83-86	13			
4				14			
5				15			
6				16			
7				17			
8				18			
9				19			
10				20			

ZONING NOTES
 1 5-28-91 PDA-89-16 91-43
 2 5-11-04 PUDZ-03-AR-3584 04-30
 3 11-16-04 PUDA-03-AR-4227 04-73
 4 7-26-05 PUDA-05-AR-7085 05-42
 5 6-8-10 LDC ORD. 10-23

THIS IS TO CERTIFY THAT THIS IS A PAGE OF THE OFFICIAL ZONING ATLAS REFERRED TO AND ADOPTED BY REFERENCE BY ORDINANCE NO. 04-41 OF THE COUNTY OF COLLIER, FLORIDA, ADOPTED JUNE 22, 2004.

BY _____ CHAIRMAN

ATTEST _____ CLERK

FLOOD INSURANCE RATE MAP INFORMATION	
COMMUNITY NUMBER: 120067	PANEL NUMBER: 250G
PROGRAM: REGULAR	EFFECTIVE DATE: NOV. 17, 2005
FLOOD ZONE: ALL <u>D</u> OR AS SHOWN ON MAP.	
WIND ZONE: ALL _____ OR AS SHOWN ON MAP.	
COLLIER COUNTY, FLORIDA	
COMMUNITY DEVELOPMENT DIVISION	
TWP 48S RNG 27E SEC(S) 21 & 22	
SCALE	MAP NUMBER:
0 800	GGE04A