

The Historic/Archaeological Probability Maps are the official County source designating historic or archaeological resources.

LAST REVISION: ZONING \_\_\_\_\_ OTHER \_\_\_\_\_

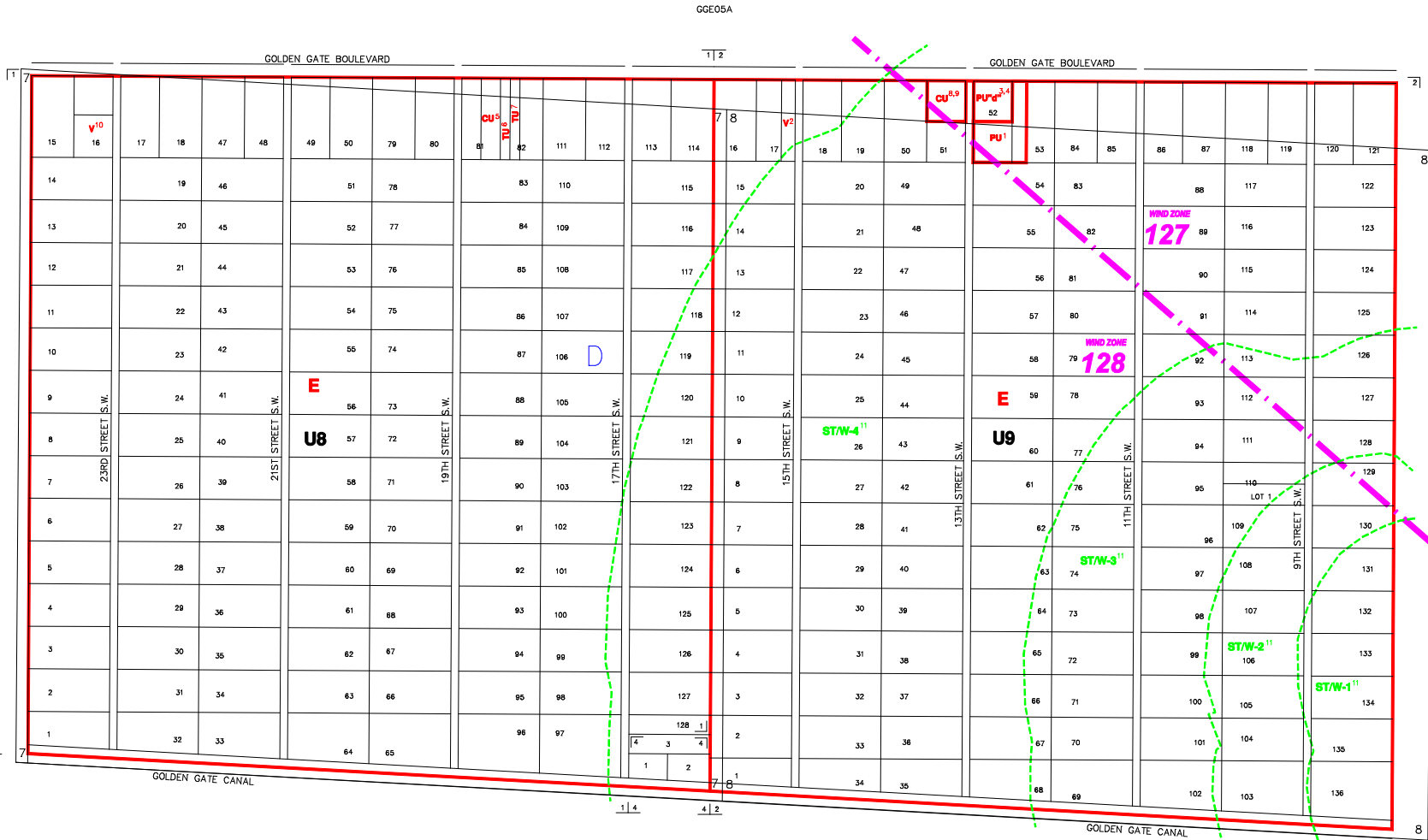

----- INDICATES SPECIAL TREATMENT OVERLAY  
 - - - - - INDICATES WIND ZONE BOUNDARY LINE

SUBDIVISION INDEX							
NO.	NAME	P.B.	Pg.	NO.	NAME	P.B.	Pg.
1	GOLDEN GATE ESTATES UNIT 8	4	97,98	11			
2	GOLDEN GATE ESTATES UNIT 9	4	99,100	12			
3	GOLDEN GATE ESTATES UNIT 9 TRACT 110 REPLAT	18	99	13			
4	ENDRES SUBDIVISION	37	100	14			
5				15			
6				16			
7				17			
8				18			
9				19			
10				20			

**ZONING NOTES**  
 1 12-23-86 PU-86-17  
 2 1-25-89 PU-89-16-2 DOP  
 3 4-8-91 PU-89-24 91-020 SOP  
 4 8-13-81 PU-89-24 91-020 SOP  
 5 11-14-89 CU-89-13 95-848  
 6 8-19-87 TU-87-55 97-47  
 7 8-19-87 TU-87-55 97-47  
 8 3-14-90 CU-00-2 00-273  
 9 8-22-88 V-88-10 88-397  
 10 8-22-88 V-88-10 88-397  
 11 6-15-85 LDC ORD. 05-27

THIS IS TO CERTIFY THAT THIS IS A PAGE OF THE OFFICIAL ZONING ATLAS REFERRED TO AND ADOPTED BY REFERENCE BY ORDINANCE NO. 04-41 OF THE COUNTY OF COLLIER, FLORIDA, ADOPTED JUNE 22, 2004.

BY \_\_\_\_\_ CHAIRMAN  
 ATTEST \_\_\_\_\_ CLERK

**FLOOD INSURANCE RATE MAP INFORMATION**  
 COMMUNITY NUMBER: 120067 PANEL NUMBER 425G  
 PROGRAM: REGULAR EFFECTIVE DATE: NOV. 17, 2005  
 FLOOD ZONE: ALL D OR AS SHOWN ON MAP.  
 WIND ZONE: ALL \_\_\_\_\_ OR AS SHOWN ON MAP.

COLLIER COUNTY, FLORIDA  
 COMMUNITY DEVELOPMENT DIVISION  
 TWP 49S RNG 27E SEC(S) 7 & 8  
 SCALE 800  
 MAP NUMBER: GGE05D

UNITS  
 8  
 9