

The Historic/Archaeological Probability Maps are the official County source designating historic or archaeological resources.

LAST REVISION: ZONING---OTHER---OTHER

482526
GGE03

8713N

8713S

472728
GGE06

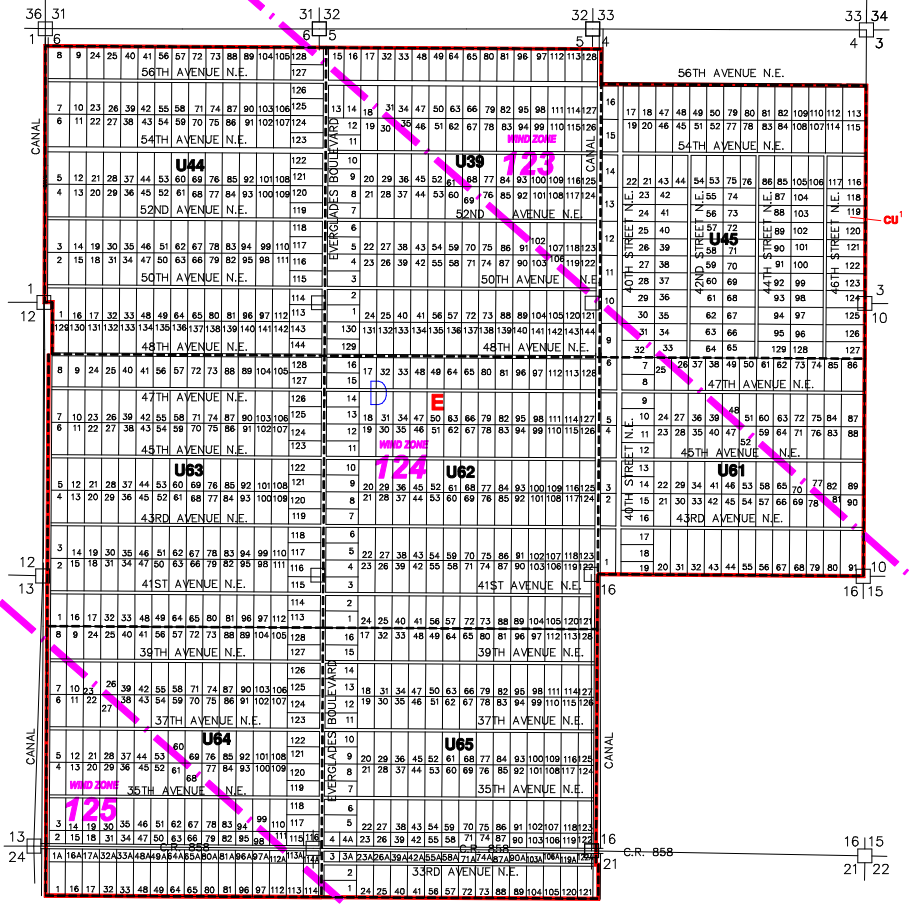

--- INDICATES WIND ZONE BOUNDARY LINE

GOLDEN GATE ESTATES UNIT INDEX					
UNIT NO.	P.B.	Pg.	UNIT NO.	P.B.	Pg.
U39	7	24			
U44	7	28			
U45	7	30			
U61	5	86			
U63	5	87			
U63	7	83			
U64	7	84			
U65	5	88			
U68A	9	46			

ZONING NOTES
1-14-03 CD-02-AR-2476 03-25
2 2 2 2 2

482728

39
44
45
61
62
63
64
65

GGE08
482728

THIS IS TO CERTIFY THAT THIS IS A PAGE OF THE OFFICIAL ZONING ATLAS REFERRED TO AND ADOPTED BY REFERENCE BY ORDINANCE NO. 04-41 OF THE COUNTY OF COLLIER, FLORIDA, ADOPTED JUNE 22, 2004.

BY _____ CHAIRMAN
ATTEST _____ CLERK

FLOOD INSURANCE RATE MAP INFORMATION
 COMMUNITY NUMBER: 120067 PANEL NUMBER: 250C
 PROGRAM: REGULAR EFFECTIVE DATE: NOV. 17, 2005
 FLOOD ZONE: ALL D OR AS SHOWN ON MAP.
 WIND ZONE: ALL _____ OR AS SHOWN ON MAP.

COLLIER COUNTY, FLORIDA
 COMMUNITY DEVELOPMENT DIVISION
 TWP 48S RNG 28E
 SCALE 0 2400 MAP NUMBER: GGE07