

492728
GGE07

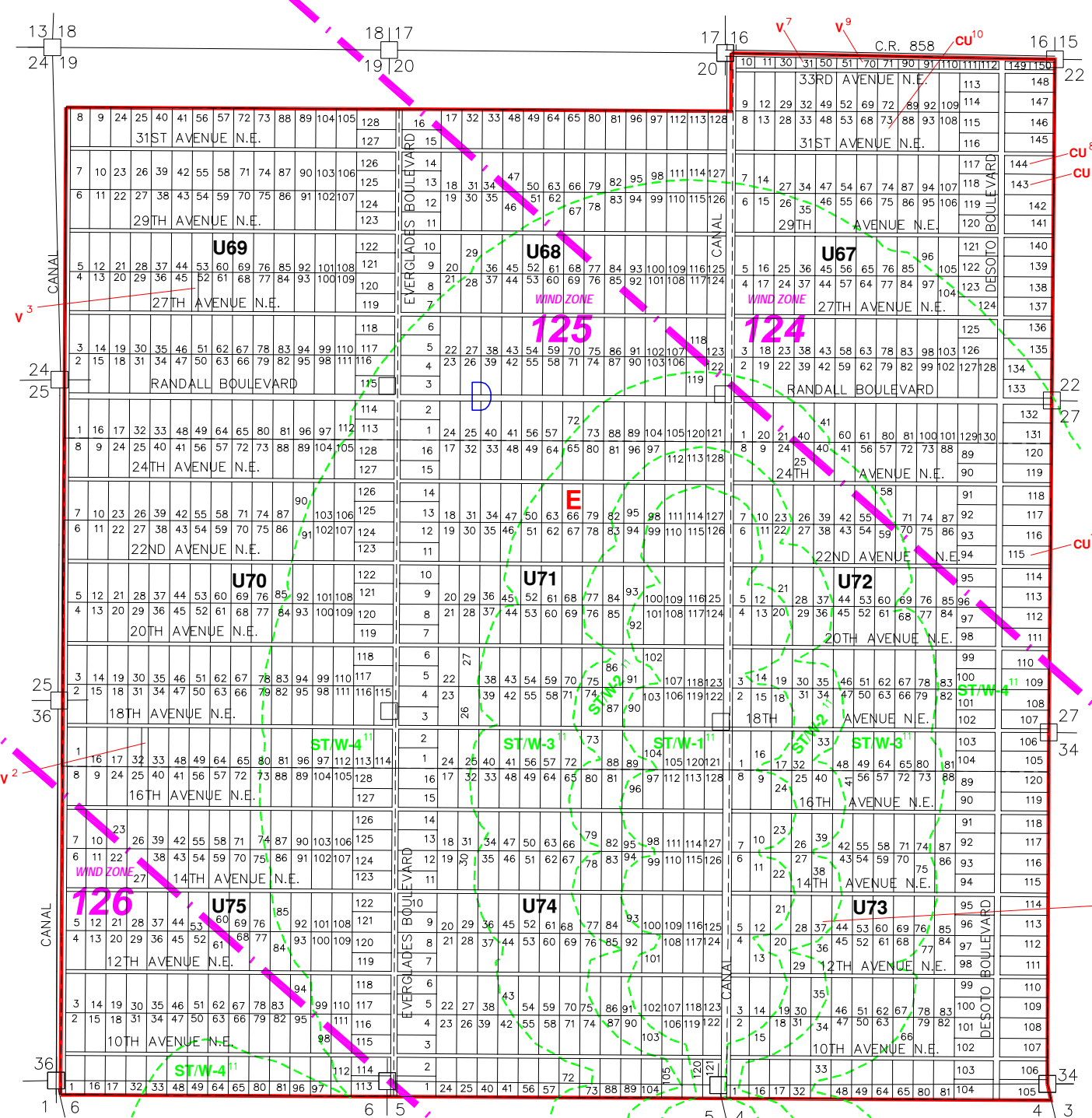

8724N

8724S

GGE04C

GGE04E

482728

67
67A
68
69
70
71
72
73
74
75

- INDICATES WIND ZONE BOUNDARY LINE
- INDICATES GOLDEN GATE UNIT BOUNDARY
- INDICATES SPECIAL TREATMENT OVERLAY

GOLDEN GATE ESTATES UNIT INDEX					
UNIT NO.	P.B.	Pg.	UNIT NO.	P.B.	Pg.
U67	5	89			
U67A	5	47			
U68	5	90			
U69	7	65			
U70	5	6			
U71	5	7			
U72	5	8			
U73	5	9			
U74	5	10			
U75	5	11,12			

ZONING NOTES

1 5-11-93 V-93-4 93-191
 2 10-12-93 V-93-23 93-479
 3 10-24-00 V-00-17 00-370
 4 2-12-02 CU-01-AR-1620 02-85
 5 1-14-03 VA-02-AR-3108 03-23
 6 10-22-02 CU-02-AR-2366 02-434
 7 11-5-02 VA-02-AR-2445 02-458
 8 4-22-03 CU-02-AR-2866 03-153
 9 6-15-05 LDC ORD. 05-27
 10 2-26-08 CU-07-AR-11977 08-50
 11
 12

THIS IS TO CERTIFY THAT THIS IS A PAGE OF THE OFFICIAL ZONING ATLAS REFERRED TO AND ADOPTED BY REFERENCE BY ORDINANCE NO. 04-41 OF THE COUNTY OF COLLIER, FLORIDA, ADOPTED JUNE 22, 2004.

BY _____ CHAIRMAN
 ATTEST _____ CLERK

FLOOD INSURANCE RATE MAP INFORMATION	
COMMUNITY NUMBER: 120067	PANEL NUMBER: 250G,450G
PROGRAM: REGULAR	EFFECTIVE DATE: NOV. 17, 2005
FLOOD ZONE: ALL <u>D</u> OR AS SHOWN ON MAP.	
WIND ZONE: ALL _____ OR AS SHOWN ON MAP.	
COLLIER COUNTY, FLORIDA	
COMMUNITY DEVELOPMENT DIVISION	
TWP 48S RNG 28E	
SCALE 0 2400	MAP NUMBER: GGE08