

The Historic/Archaeological Probability Maps are the official County source designating historic or archaeological resources.

LAST REVISION: ZONING _____ OTHER _____

492728

492728

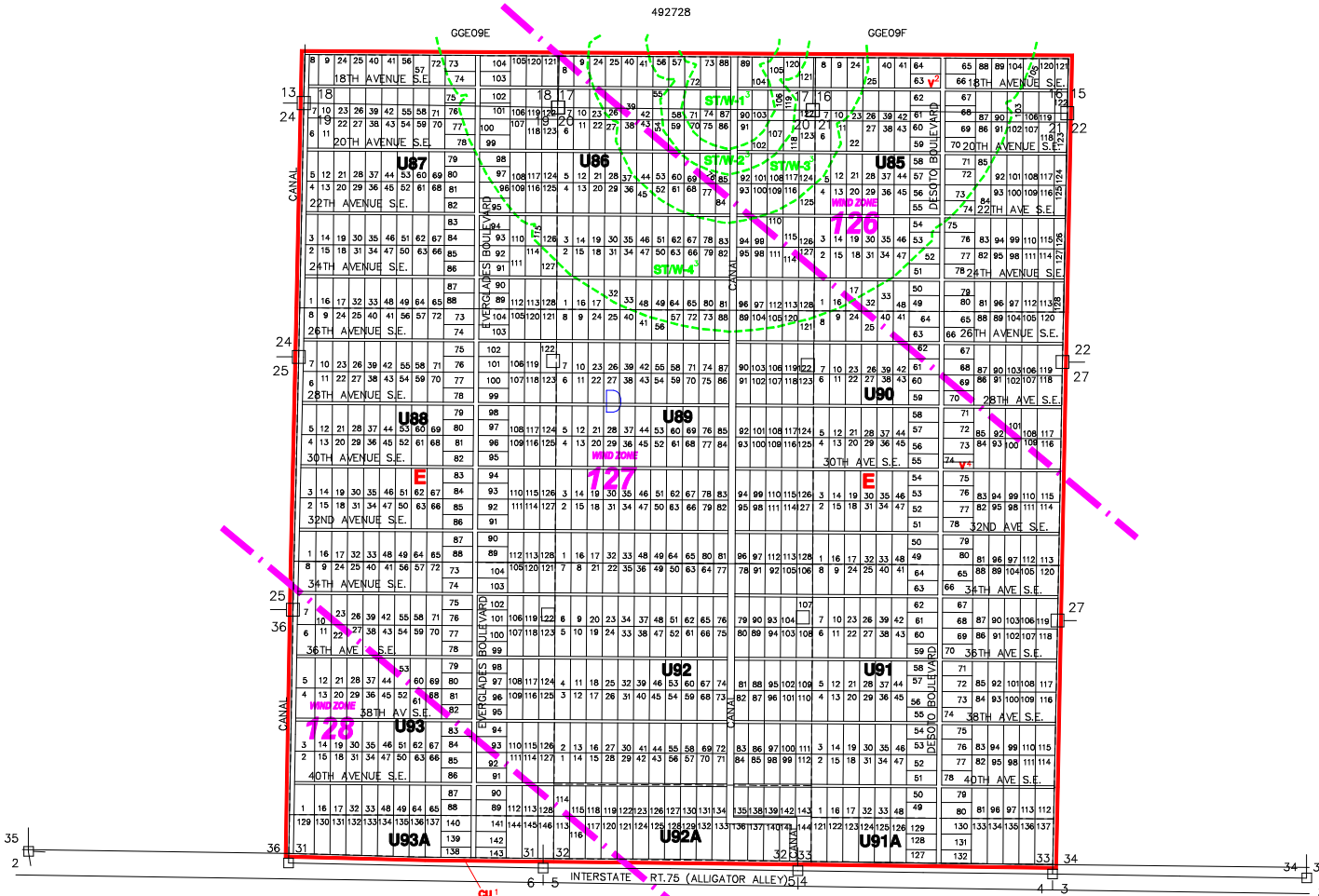

-----INDICATES GOLDEN GATE UNIT BOUNDARY
 - - - - -INDICATES SPECIAL TREATMENT OVERLAY
 - - - - -INDICATES WIND ZONE BOUNDARY LINE

GOLDEN GATE ESTATES UNIT INDEX					
UNIT NO.	P.B.	Pg.	UNIT NO.	P.B.	Pg.
U85	5	24	U92A	9	10
U86	5	25	U93A	9	11
U87	5	26			
U88	5	27			
U89	5	28			
U90	5	29			
U91	5	30			
U92	5	31			
U93	5	32			
U93A	5	33			

ZONING NOTES
 4-24-01 CU-00-19 01-168
 7-30-02 VA-02-AP-2444 02-330
 1-17-03 VA-02-AP-2444 02-330
 5-14-08 VA-02-AP-2616 06-65
 1-22-09 02-07-08

THIS IS TO CERTIFY THAT THIS IS A PAGE OF THE OFFICIAL ZONING ATLAS REFERRED TO AND ADOPTED BY REFERENCE BY ORDINANCE NO. 04-41 OF THE COUNTY OF COLLIER, FLORIDA, ADOPTED JUNE 22, 2004.

BY _____ CHAIRMAN
 ATTEST _____ CLERK

FLOOD INSURANCE RATE MAP INFORMATION
 COMMUNITY NUMBER: 120067 PANEL NUMBER: 450G
 PROGRAM: REGULAR EFFECTIVE DATE: NOV. 17, 2005
 FLOOD ZONE: ALL D OR AS SHOWN ON MAP.
 WIND ZONE: ALL _____ OR AS SHOWN ON MAP.

COLLIER COUNTY, FLORIDA
 COMMUNITY DEVELOPMENT DIVISION
 TWP 49S RNG 28E
 SCALE _____ MAP NUMBER: GGE10
 0 2400

85
 86
 87
 88
 89
 90
 91
 91A
 92
 92A
 93
 93A