

The Historic/Archaeological Probability Maps are the official County source designating historic or archaeological resources.

LAST REVISION: ZONING _____ OTHER _____

502526
GGE11

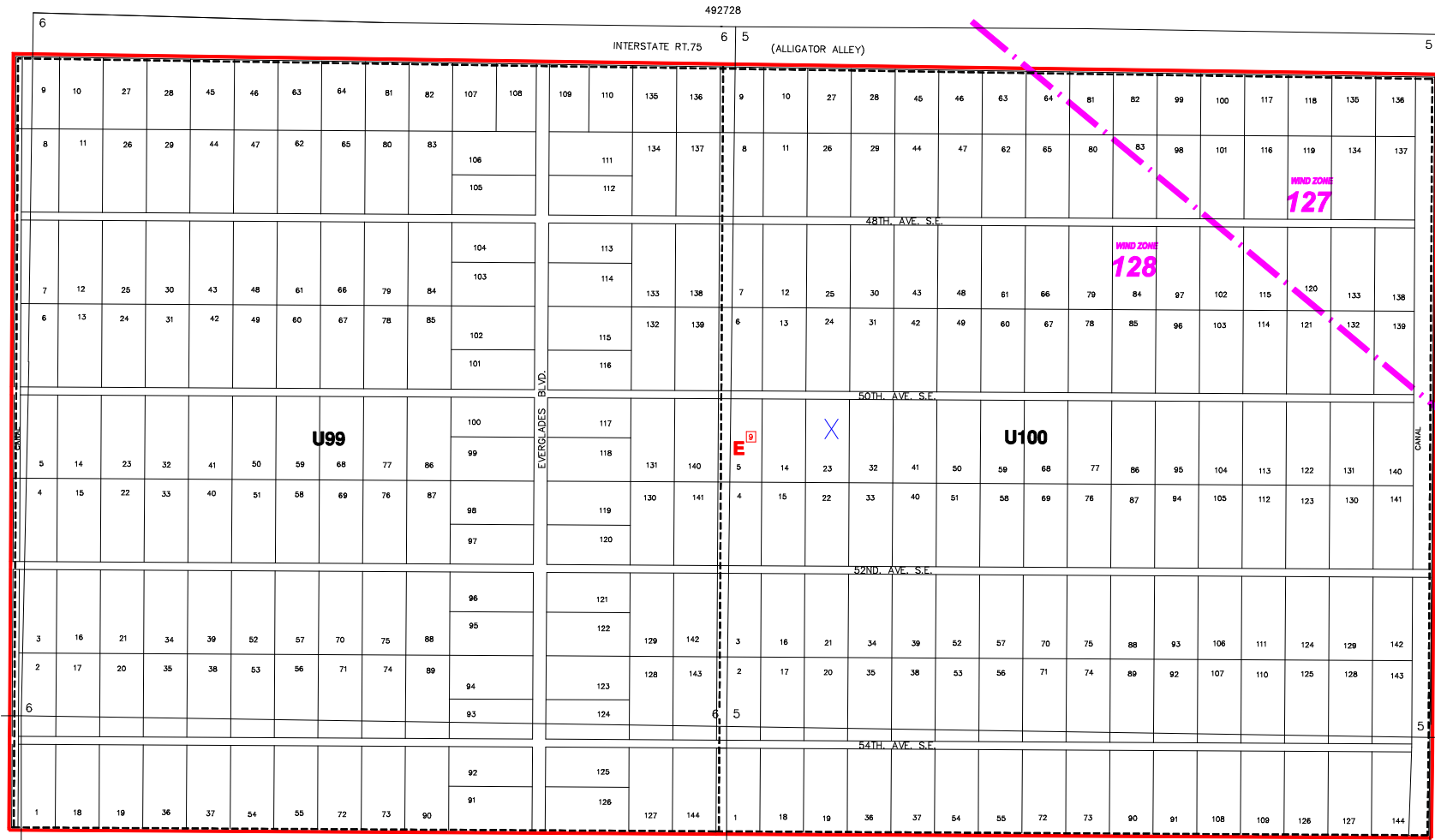

GGE12B

99
100

----- INDICATES WIND ZONE BOUNDARY LINE

GOLDEN GATE ESTATES UNIT INDEX			SUBDIVISION INDEX			
UNIT NO.	P.B.	Pg.	NO.	NAME	P.B.	Pg.
U99	7	33				
U100	5	33				

ZONING NOTES

ZONING OVERLAY NOTES
OVERLAY CREATED BY
LDC ORD. No. 04-08 1-7-04
[B] NRPA

THIS IS TO CERTIFY THAT THIS IS A PAGE OF THE OFFICIAL ZONING ATLAS REFERRED TO AND ADOPTED BY REFERENCE BY ORDINANCE NO. 04-41 OF THE COUNTY OF COLLIER, FLORIDA, ADOPTED JUNE 22, 2004.

BY _____ CHAIRMAN
ATTEST _____ CLERK

FLOOD INSURANCE RATE MAP INFORMATION	
COMMUNITY NUMBER: 120067 PANEL NUMBER: 450G	
PROGRAM: REGULAR EFFECTIVE DATE: NOV. 17, 2005	
FLOOD ZONE: ALL ___X___ OR AS SHOWN ON MAP.	
WIND ZONE: ALL _____ OR AS SHOWN ON MAP.	
COLLIER COUNTY, FLORIDA	
COMMUNITY DEVELOPMENT DIVISION	
TWP 50S RNG 28E	
SCALE 0 800	MAP NUMBER: GGE12A

492728

6

6 5

5

INTERSTATE RT.75 (ALLIGATOR ALLEY)

48TH AVE. S.E.

50TH AVE. S.E.

52ND AVE. S.E.

54TH AVE. S.E.

U99

U100

WIND ZONE
127

WIND ZONE
128

E

X

GGE12C